

STATE OF ILLINOIS
DEPARTMENT OF TRANSPORTATION

F.A.P. RTE.	SECTION	COUNTY	TOTAL SHEETS	SHEET NO.
14	(138Z)T-1	ALEXANDER	10	1
		ILLINOIS	CONTRACT NO. 78993	

D-99-027-23

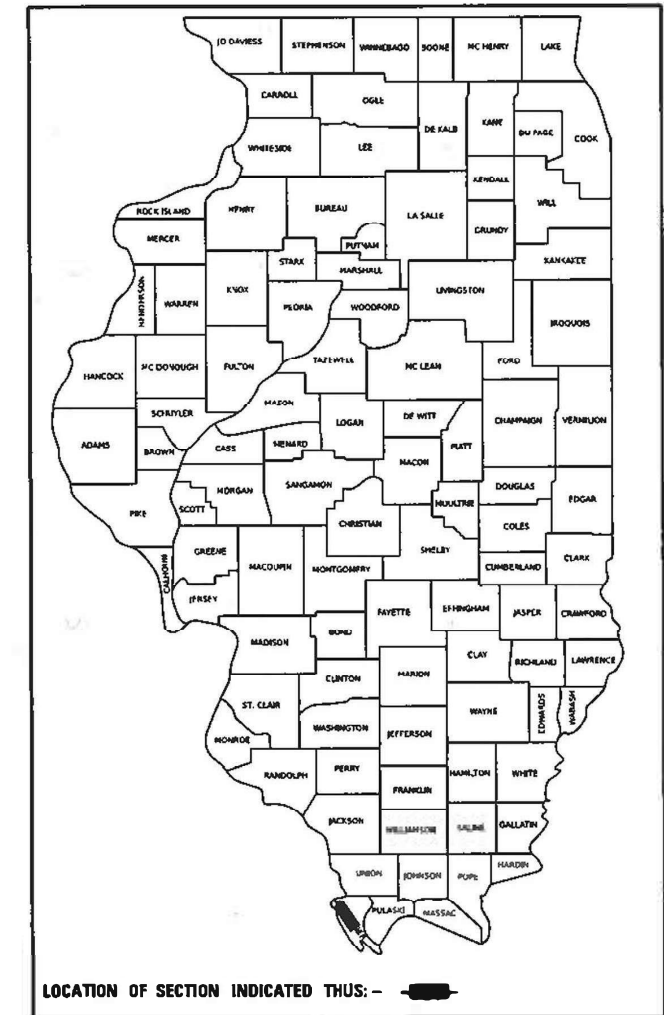

FOR INDEX OF SHEETS, SEE SHEET NO. 3
FOR SUMMARY OF QUANTITIES, SEE SHEET NO. 4-5

**PROPOSED
HIGHWAY PLANS**

FAP ROUTE 14 (US 51)
SECTION (138Z)T-1

PATCHING PAVEMENT & ADA RAMPS
ALEXANDER COUNTY

C-99-040-23

TRAFFIC DATA

2021 4,800 WITH 20.3% TRUCKS

**TOWNSHIPS
CAIRO**

COORDINATE SYSTEM: EPSG: 102671
NAD 1983 STATE PLANE ILLINOIS EAST FIPS 1201 FEET
POSTED SPEED: 30 MPH

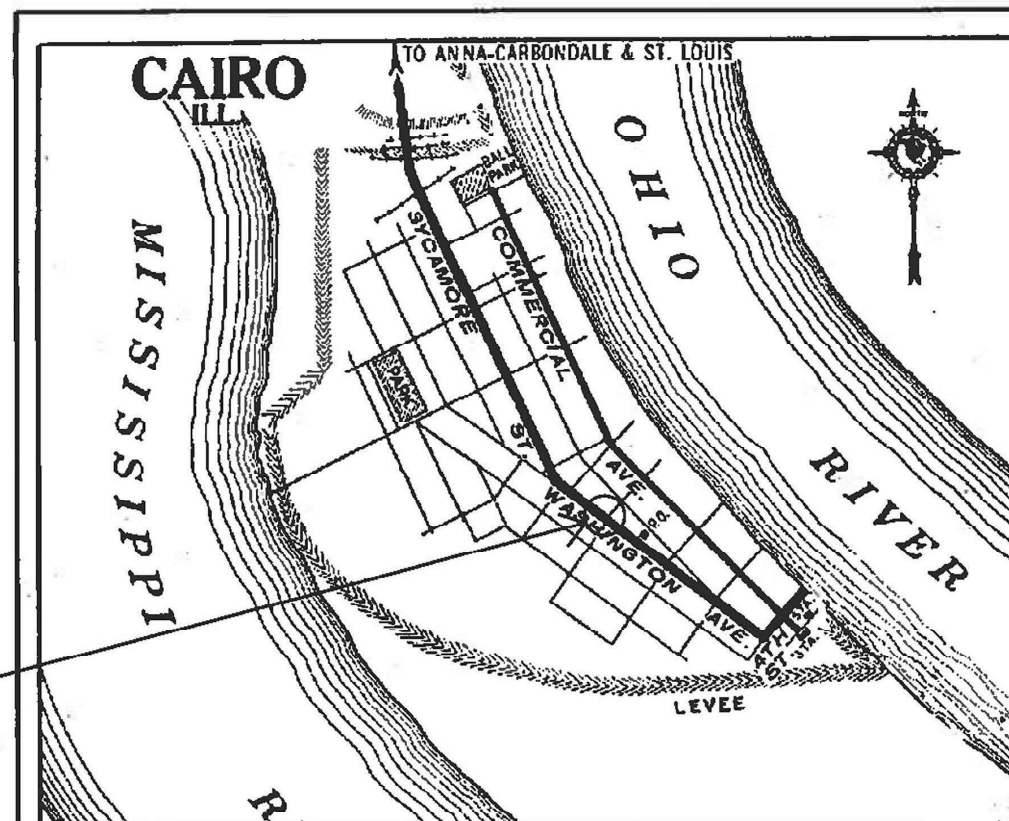

PROJECT AREA
14TH ST & WASHINGTON AVE

J.U.I.E.
JOINT UTILITY LOCATION INFORMATION FOR EXCAVATION
1-800-892-0123
OR 811

PROJECT ENGINEER: VALERIE ROLLA
PROJECT DESIGNER: ROBERT HANDY

CONTRACT NO. 78993

GROSS LENGTH = 77 FT. = 0.015 MILE
NET LENGTH = 77 FT. = 0.015 MILE

STATE OF ILLINOIS
DEPARTMENT OF TRANSPORTATION

SUBMITTED 1-30-2023
Kirk H. Brown
REGION FIVE ENGINEER

March 24, 2023
SAEA, etc
ENGINEER OF DESIGN AND ENVIRONMENT

March 24, 2023
Stephen M. ...
DIRECTOR OF HIGHWAYS PROJECT IMPLEMENTATION

PRINTED BY THE AUTHORITY
OF THE STATE OF ILLINOIS

MODEL: Signature Sheet
 FILE NAME: \\mshp\public\utility\com\PMIDOT\Documents\DOT_Online\Shared\BORD Projects\19182\CADDraw\CADDraws\19182\SUA-Cover.dwg

Prepared By: *Charles Stein*
 DISTRICT STUDIES & PLANS ENGINEER

Examined By: *Nancy [Signature]*
 DISTRICT LAND ACQUISITION ENGINEER

Examined By: *Carin Nelson*
 DISTRICT PROGRAM DEVELOPMENT ENGINEER

Examined By: *[Signature]*
 DISTRICT OPERATIONS ENGINEER

Examined By: *Douglas J. Tuckell*
 DISTRICT PROJECT IMPLEMENTATION ENGINEER

Examined By: *Douglas J. Tuckell*
 DISTRICT CONSTRUCTION ENGINEER

Examined By: *Ann Hays*
 DISTRICT MATERIALS ENGINEER

USER NAME = Robert.Handy	DESIGNED -	REVISED -
DRAWN -	CHECKED -	REVISED -
PLOT SCALE = 0.18888833 / in.		
PLOT DATE = 1/9/2023	DATE -	REVISED -

**STATE OF ILLINOIS
DEPARTMENT OF TRANSPORTATION**

SIGNATURE SHEET

SCALE:	SHEET 1	OF 1	SHEETS	STA.	TO STA.

F.A.P. RTE.	SECTION	COUNTY	TOTAL SHEETS	SHEET NO.
14	(1382)T-1	ALEXANDER	10	2
CONTRACT NO. 78993				
ILLINOIS FED. AID PROJECT				

INDEX OF SHEETS

SHEET NO	DESCRIPTION
1	COVER SHEET
2	SIGNATURE SHEET
3	INDEX OF SHEETS, GENERAL NOTES, HIGHWAY STANDARDS,
4-5	SUMMARY OF QUANTITIES
6	US 51 TYPICALS
7	PATCH PAVEMENT SCHEDULE, PAVEMENT MARKING SCHEDULE & SIDEWALK SCHEDULE
8	PROPOSED PATCH AREA
9	SIDEWALK REMOVAL DETAILS
10	SIDEWALK PLAN DETAILS

GENERAL NOTES

AT ALL LOCATIONS WHERE THE PROPOSED HOT MIX ASPHALT OR CONCRETE PAVEMENT JOINS AN EXISTING HOT MIX ASPHALT OR CONCRETE PAVEMENT, A FULL DEPTH SAWED JOINT SHALL BE CONSTRUCTED. THE COST OF THIS JOINT WILL BE INCLUDED IN THE COST OF THE TYPE OF PAVEMENT BEING CONSTRUCTED.

COMMITMENTS: NONE

HIGHWAY STANDARDS

000001-08	604001-05
001001-02	606001-08
001006	701101-05
420701-03	701611-01
424001-11	701801-06
424021-06	701901-08
442101-09	780001-05

REV. - MS

MODEL: MODEL NAMES
FILE NAME: SHEETS

USER NAME = \$USERS	DESIGNED -	REVISED -	STATE OF ILLINOIS DEPARTMENT OF TRANSPORTATION	INDEX OF SHEETS, GENERAL NOTES & HIGHWAY STANDARDS	F.A.P. RTE.	SECTION	COUNTY	TOTAL SHEETS	SHEET NO.	
DRAWN -	REVISIED -	14			(138Z)T-1	ALEXANDER	3	10		
PLOT SCALE = \$\$CALES	CHECKED -	REVISED -			CONTRACT NO. 78993					
PLOT DATE = \$DATES	DATE -	REVISED -			ILLINOIS FED. AID PROJECT					
				SCALE:	SHEET 1	OF 1	SHEETS	STA.	TO STA.	

SUMMARY OF QUANTITIES

COUNTY:	ALEXANDER
ROUTE:	FAP 14
FUNDING:	100% STATE
LOCATION:	URBAN
	ROADWAY
	0005

CODE NUMBER	ITEM DESCRIPTION	UNIT	QUANTITY
42400200	PORTLAND CEMENT CONCRETE SIDEWALK 5 INCH	SQ FT	960
42400800	DETECTABLE WARNINGS	SQ FT	85
44000500	COMBINATION CURB AND GUTTER REMOVAL	FOOT	85
44000600	SIDEWALK REMOVAL	SQ FT	970
44200050	WELDED WIRE REINFORCEMENT	SQ YD	365
44201048	CLASS B PATCHES, TYPE IV, 16 INCH	SQ YD	365
44201299	DOWEL BARS 1 1/2"	EACH	56
44213204	TIE BARS 3/4"	EACH	153
60255500	MANHOLES TO BE ADJUSTED	EACH	2
60255800	MANHOLES TO BE ADJUSTED WITH NEW TYPE 1 FRAME, CLOSED LID	EACH	1
60265700	VALVE VAULTS TO BE ADJUSTED	EACH	2

REV. - MS

MODEL: MDC01L000005
FILE NAME: SFILES

USER NAME = \$USERS PLOT SCALE = \$\$CALES PLOT DATE = \$DATES	DESIGNED - DRAWN - CHECKED - DATE -	REVISED - REVISED - REVISED - REVISED -	STATE OF ILLINOIS DEPARTMENT OF TRANSPORTATION	SUMMARY OF QUANTITIES	F.A.P. RTE. 14 SECTION (1382)T-1 COUNTY ALEXANDER TOTAL SHEETS 10 SHEET NO. 4	CONTRACT NO. 78933 ILLINOIS FED. AID PROJECT
--	--	--	---	------------------------------	---	---

SCALE: SHEET 1 OF 2 SHEETS STA. TO STA.

SUMMARY OF QUANTITIES - CONT

COUNTY:	ALEXANDER
ROUTE:	FAP 14
FUNDING:	100% STATE
LOCATION:	URBAN
	ROADWAY
	0005

CODE NUMBER	ITEM DESCRIPTION	UNIT	
60605000	COMBINATION CONCRETE CURB AND GUTTER, TYPE B-6.24	FOOT	85
67100100	MOBILIZATION	L SUM	1
70102634	TRAFFIC CONTROL AND PROTECTION, STANDARD 701611	L SUM	1
70102640	TRAFFIC CONTROL AND PROTECTION, STANDARD 701801	L SUM	1
70103815	TRAFFIC CONTROL SURVEILLANCE	CAL DA	15
70107025	CHANGEABLE MESSAGE SIGN	CAL DA	28
* 78001110	PAINT PAVEMENT MARKING - LINE 4"	FOOT	180

* SPECIALTY ITEM

MODEL: R000ELNAMES
FILENAME: S1E13

USER NAME = SUSERS	DESIGNED -	REVISED -
	DRAWN -	REVISED -
PLOT SCALE = \$SCALE\$	CHECKED -	REVISED -
PLOT DATE = \$DATES	DATE -	REVISED -

**STATE OF ILLINOIS
DEPARTMENT OF TRANSPORTATION**

SUMMARY OF QUANTITIES

SCALE: SHEET 2 OF 2 SHEETS STA. TO STA.

F.A.P. RTE.	SECTION	COUNTY	TOTAL SHEETS	SHEET NO.
14	(138Z)T-1	ALEXANDER	10	5
CONTRACT NO. 78993				
ILLINOIS FED. AID PROJECT				

TYPICAL SECTION

N.T.S

WASHINGTON AVE
FAP 14 (US 51)
REMOVAL STAGE

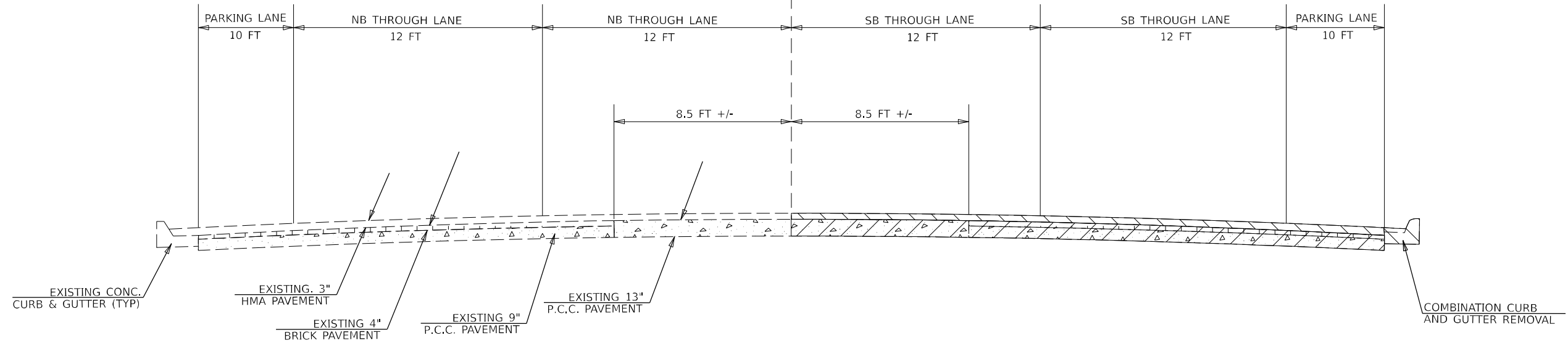

TO BE USED:
STA 900+32 TO STA 901+09

TYPICAL SECTION

N.T.S

WASHINGTON AVE
FAP 14 (US-51)
PROPOSED

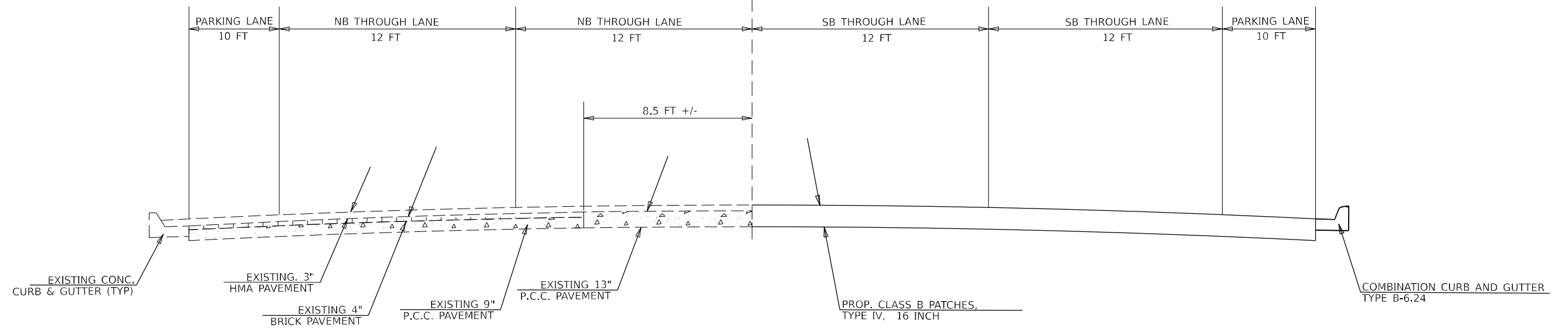

TO BE USED:
STA 900+32 TO STA 901+09

MODEL: R0001A.MXD
FILENAME: 14ST1.DWG

USER NAME = SUSER\$	DESIGNED -	REVISED -
	DRAWN -	REVISED -
PLOT SCALE = SSCALE\$	CHECKED -	REVISED -
PLOT DATE = SDATES	DATE -	REVISED -

STATE OF ILLINOIS
DEPARTMENT OF TRANSPORTATION

14TH ST & WASHINGTON AVE
TYPICALS

SCALE: SHEET 1 OF 1 SHEETS STA. TO STA.

F.A.P. RTE.	SECTION	COUNTY	TOTAL SHEETS	SHEET NO.
14	(138Z)T-1	ALEXANDER	10	6
CONTRACT NO. 78993				
ILLINOIS FED. AID PROJECT				

US 51 & 14TH ST PATCHING PAVEMENT SCHEDULE

LOCATION	WIDTH	LENGTH	CLASS B PATCHES, TYPE IV, 16 INCH	TIE BARS 3/4"	DOWEL BARS 1 1/2"	MANHOLES TO BE ADJUSTED WITH NEW FRAME AND CLOSED LID TYPE 1	MANHOLES TO BE ADJUSTED	VALVE VAULTS TO BE ADJUSTED
INFORMATION ONLY								
	FEET	FEET	SQYD	EACH	EACH	EACH	EACH	EACH
STA 900+32 TO STA 901+09	55	77	365	125	56	1	2	2
TOTAL			365	125	56	1	2	2

PAVEMENT MARKING SCHEDULE

LOCATION STATION TO STATION	LENGTH (INFO. ONLY)	PAINT PAVEMENT MARKING		NOTES
		LINE 4"	CROSSWALK 4"	
		SKIP-DASH WHITE	SOLID WHITE	
WASHINGTON AVE SOUTHBOUND LANE	FOOT	FOOT	FOOT	
900+32 TO 901+09	77	20	160	FULL LENGTH ACROSS NORTH & SOUTH BOUND LANES
SUB TOTAL		20	160	
TOTAL		180		

SIDEWALK SCHEDULE

LOCATION		COMBINATION CURB AND GUTTER REMOVAL	SIDEWALK REMOVAL	COMBINATION CURB AND GUTTER TYPE B-6.24	DETECTABLE WARNINGS	TIE BARS 3/4"	PORT CEMENT CONC SIDEWALK 5"
STREET	QUAD SECTION	FOOT	SQ FT	FOOT	SQ FT	EACH	SQ FT
14TH	NW	45	425	45	45	14	415
14TH	SW	40	545	40	40	14	545
TOTAL		85	970	85	85	28	960

MODEL: R000ELNAMES
FILE NAME: S1E13

USER NAME = SUSERS	DESIGNED -	REVISED -	
	DRAWN -	REVISED -	
PLOT SCALE = SSCALE\$	CHECKED -	REVISED -	
PLOT DATE = SDATES	DATE -	REVISED -	

**STATE OF ILLINOIS
DEPARTMENT OF TRANSPORTATION**

**PATCHING & PAVEMENT MARKING SCHEDULE
SIDEWALK SCHEDULE**

SCALE: SHEET 1 OF 1 SHEETS STA. TO STA.

F.A.P. RTE.	SECTION	COUNTY	TOTAL SHEETS	SHEET NO.
14	(138Z)T-1	ALEXANDER	10	7
CONTRACT NO. 78993				
ILLINOIS FED. AID PROJECT				

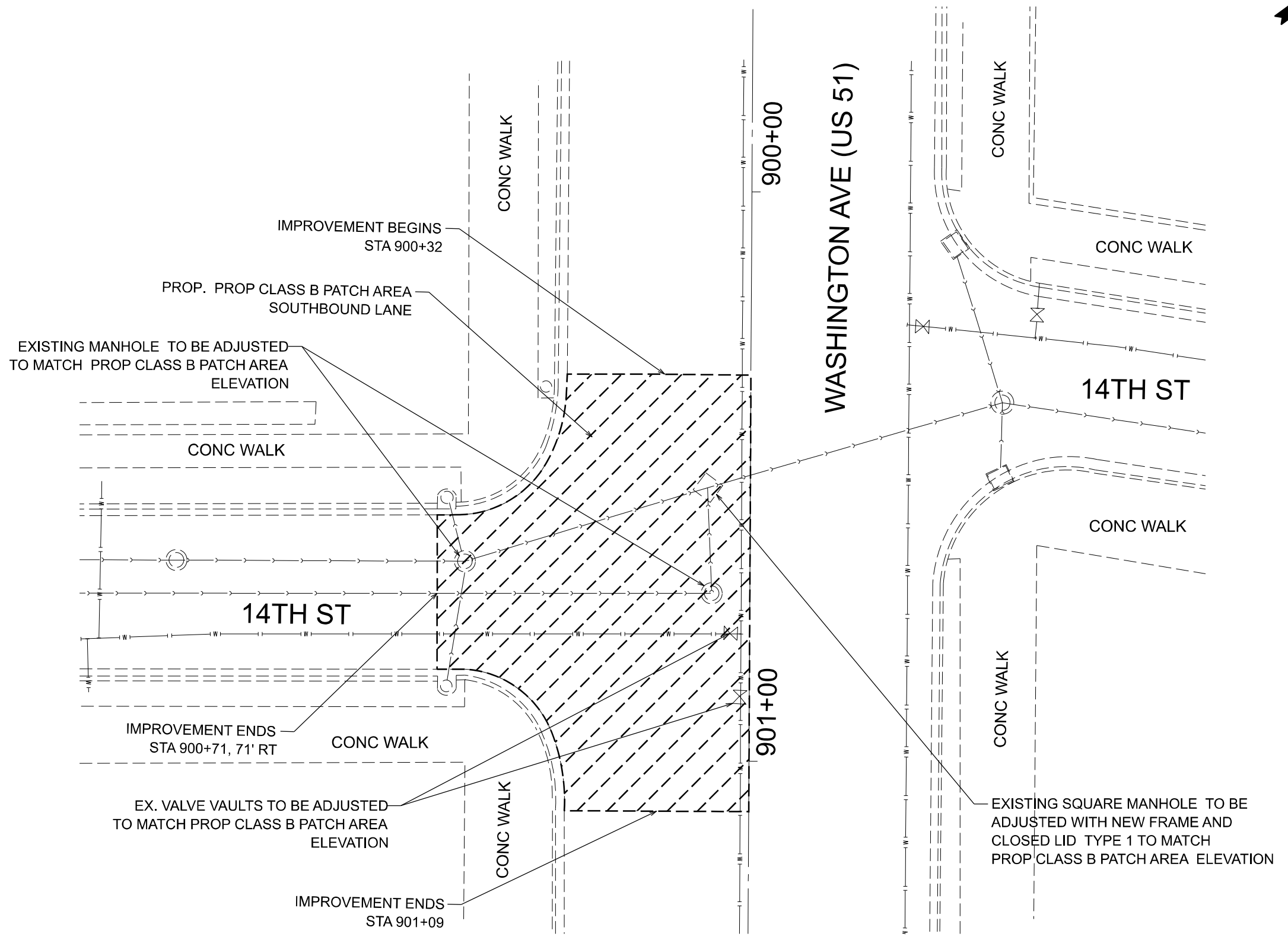
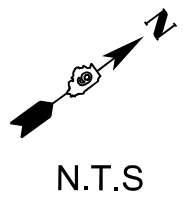

MODEL: MODELNAME\$
FILENAME: \$FILE\$

USER NAME = \$USERS	DESIGNED -	REVISED -
	DRAWN -	REVISED -
PLOT SCALE = \$\$SCALE\$	CHECKED -	REVISED -
PLOT DATE = \$DATES	DATE -	REVISED -

**STATE OF ILLINOIS
DEPARTMENT OF TRANSPORTATION**

PROPOSED PAVING AREA	
14TH ST & WASHINGTON ST	
SCALE: SCALE	SHEET 1 OF 1 SHEETS STA. TO STA.

F.A.P. RTE.	SECTION	COUNTY	TOTAL SHEETS	SHEET NO.
14	(138Z)-1	ALEXANDER	10	8
CONTRACT NO. 78993				
ILLINOIS FED. AID PROJECT				

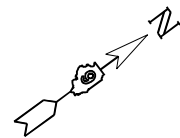

N.T.S

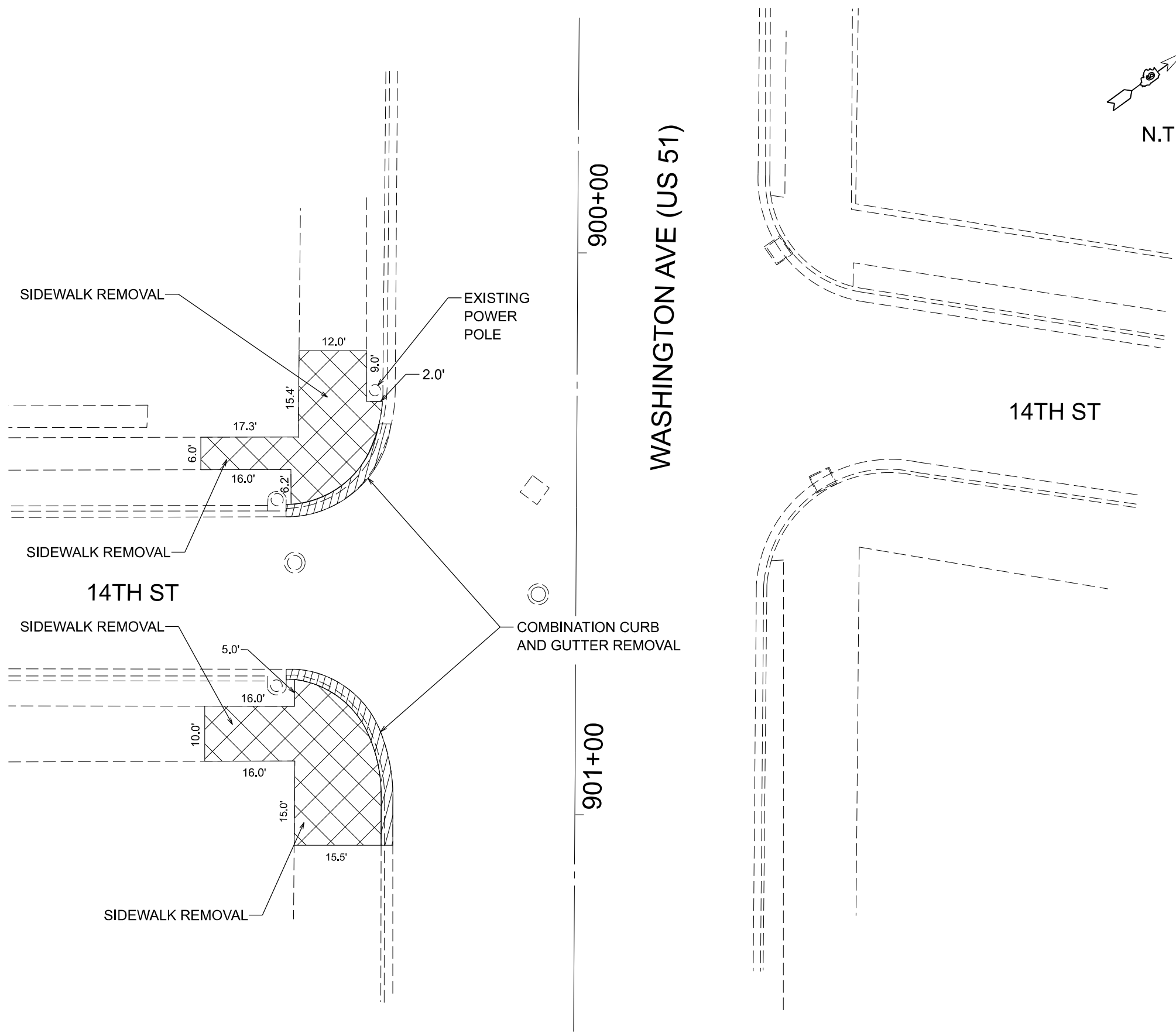

MODEL: M0001A.MXD
FILENAME: S1E1E3

USER NAME = \$USERS	DESIGNED -	REVISED -
	DRAWN -	REVISED -
PLOT SCALE = \$\$SCALE\$	CHECKED -	REVISED -
PLOT DATE = \$DATES	DATE -	REVISED -

**STATE OF ILLINOIS
DEPARTMENT OF TRANSPORTATION**

**SIDEWALK REMOVAL DETAILS
14TH ST & WASHINGTON ST**

SCALE: NTS SHEET 1 OF 2 SHEETS STA. TO STA.

F.A.P. RTE.	SECTION	COUNTY	TOTAL SHEETS	SHEET NO.
14	(138Z)T-1	ALEXANDER	10	9
CONTRACT NO. 78993				
ILLINOIS FED. AID PROJECT				

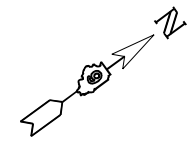

N.T.S

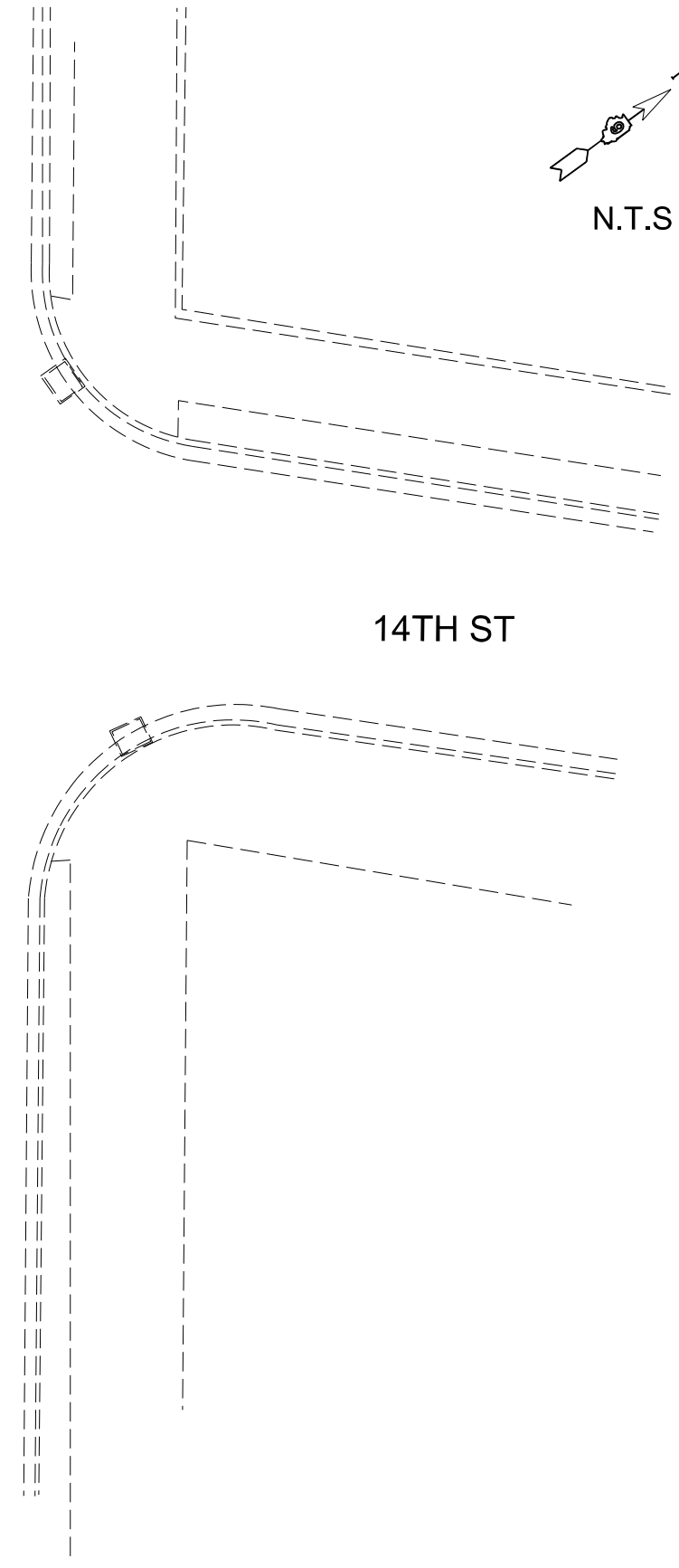
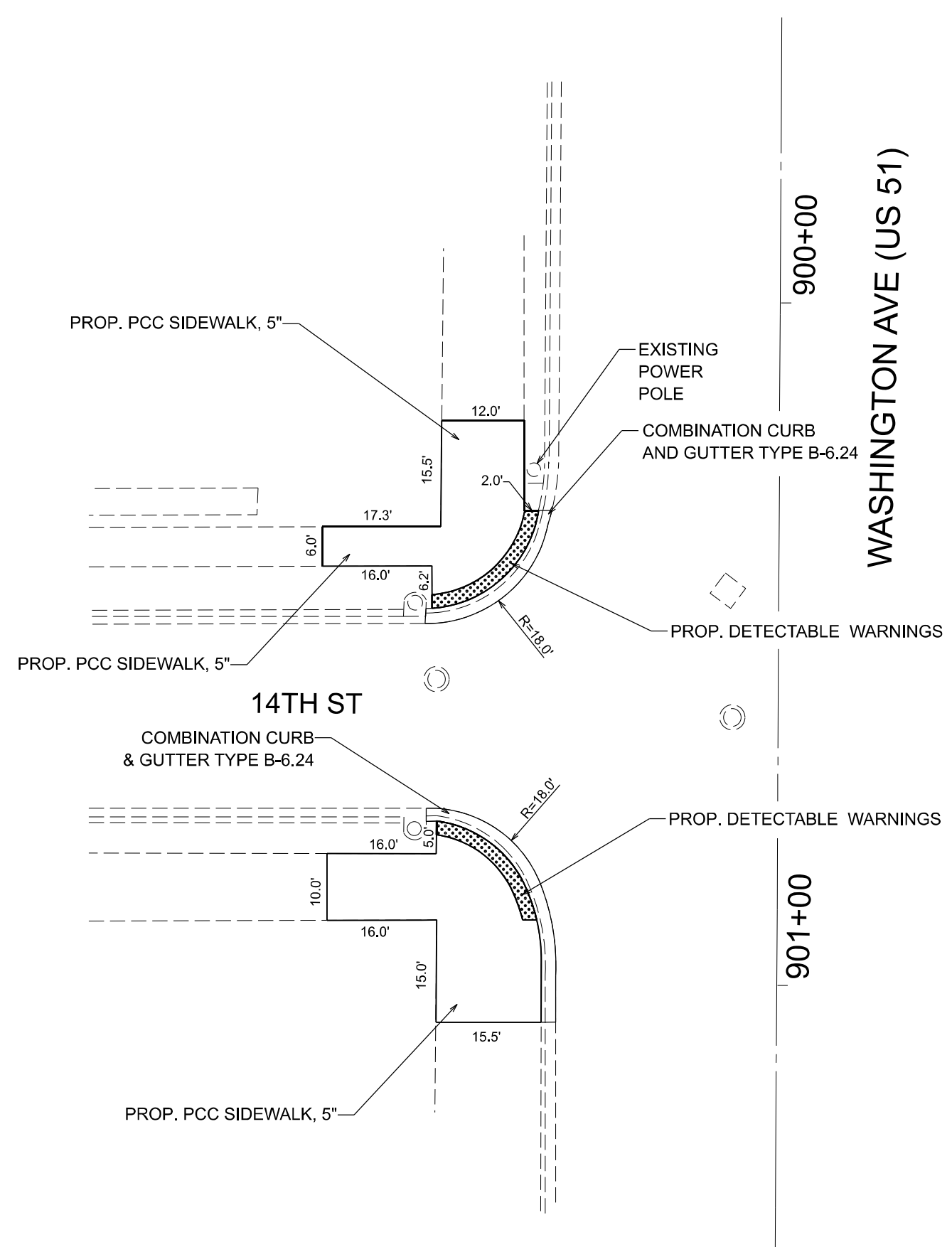

MODEL: 8/20/2015
FILE NAME: 8/20/15

USER NAME = \$USERS	DESIGNED -	REVISED -
	DRAWN -	REVISED -
PLOT SCALE = \$\$SCALE\$	CHECKED -	REVISED -
PLOT DATE = \$DATES	DATE -	REVISED -

STATE OF ILLINOIS
DEPARTMENT OF TRANSPORTATION

SIDEWALK PLAN SHEET
14TH ST & WASHINGTON ST

SCALE: NTS SHEET 2 OF 2 SHEETS STA. TO STA.

F.A.P. RTE.	SECTION	COUNTY	TOTAL SHEETS	SHEET NO.
14	(138Z)-1	ALEXANDER	10	10
CONTRACT NO. 78993				
ILLINOIS FED. AID PROJECT				