

F.A.P. RTE.	SECTION	COUNTY	TOTAL SHEETS	SHEET NO.
303	29R-T	McHENRY	88	25
STA. 0+643.40		TO STA. 1+026.98		
FED. ROAD DIST. NO. 1		ILLINOIS FED. AID PROJECT		
JOB D-91-190-01		CONTRACT NO. 62202		

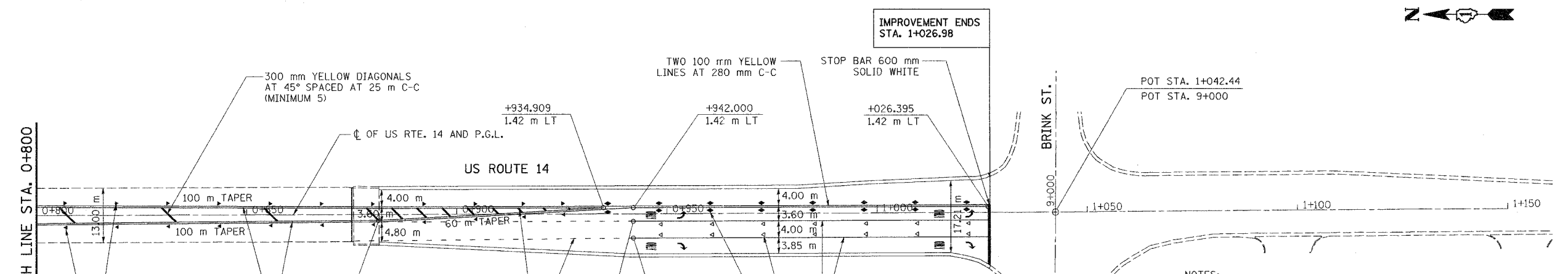
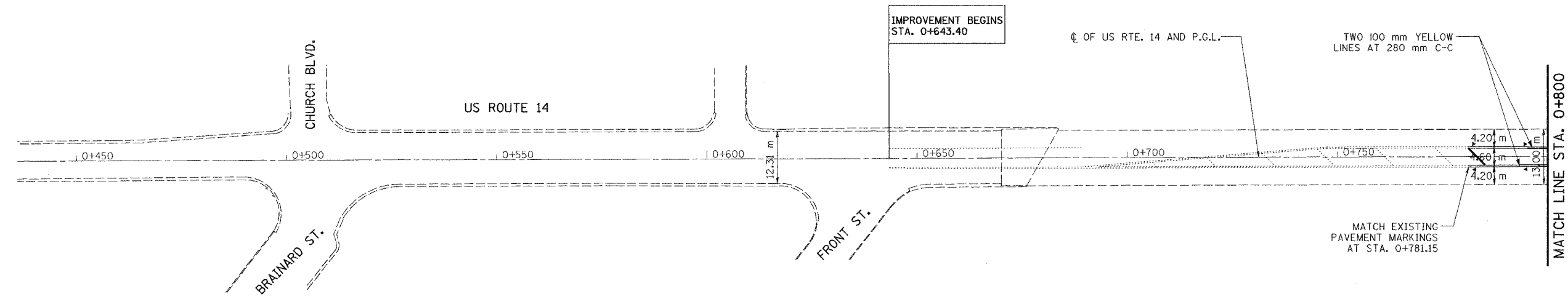

- NOTES:
- PERMANENT PAVEMENT MARKINGS SHALL BE THERMOPLASTIC (OF THE EXTRUDED TYPE) CONFORMING TO I.D.O.T. STANDARD SPECIFICATIONS. PERMANENT PAVEMENT MARKINGS SHALL BE PLACED IN ACCORDANCE WITH THE "DISTRICT ONE TYPICAL PAVEMENT MARKINGS" DETAIL (TC-13) AND USED WITH THE STATE STANDARD.
 - RAISED REFLECTIVE PAVEMENT MARKERS ARE TO BE PLACED THROUGHOUT THE IMPROVEMENT LIMITS. DOUBLE LANE LINE MARKERS SHALL BE PLACED. SEE DETAIL "TYPICAL APPLICATIONS RAISED REFLECTIVE PAVEMENT MARKERS (SLOW-PLow RESISTANT)." STANDARD 781001-2.
 - THE RESIDENT ENGINEER SHALL CONTACT THE AREA TRAFFIC FIELD ENGINEER DEBBIE HANLON (847) 438-2300 AT LEAST TWO (2) WEEKS PRIOR TO INSTALLATION OF FINAL PAVEMENT MARKINGS.
 - EXISTING SIGNING SHALL BE MAINTAINED AND PROTECTED.
 - THERMOPLASTIC PAVEMENT MARKINGS SHALL BE USED FOR BITUMINOUS PAVEMENT SURFACES.
 - PREFORMED PLASTIC PAVEMENT MARKINGS SHALL BE USED ON (BRIDGE) PORTLAND CEMENT CONCRETE SURFACES.

- SYMBOLS:
- ◀ ONE-WAY AMBER MARKER
 - ◁ ONE-WAY CRYSTAL MARKER
 - ◆ TWO-WAY AMBER MARKER

REVISIONS		ILLINOIS DEPARTMENT OF TRANSPORTATION US 14 - MOKELER CREEK TO N. OF IL. 173 AND AT UPRR PAVEMENT MARKING PLAN
NAME	DATE	

SCALE: 1:500
DATE: FEBRUARY, 2005
DRAWN BY: R.A.D.
CHECKED BY: DR, SSS

SOODAN & ASSOCIATES INC.
Architects, Engineers & Construction Consultants

Plotted by: jsingh 02/10/2005 03:38:17 PM