

F.A.P. RTE.	SECTION	COUNTY	TOTAL SHEETS	SHEET NO.
303	29-T	McHENRY	86	37
STA.	TO STA.			
FED. ROAD DIST. NO.	ILLINOIS FED. AID PROJECT		CONTRACT No. 62202	

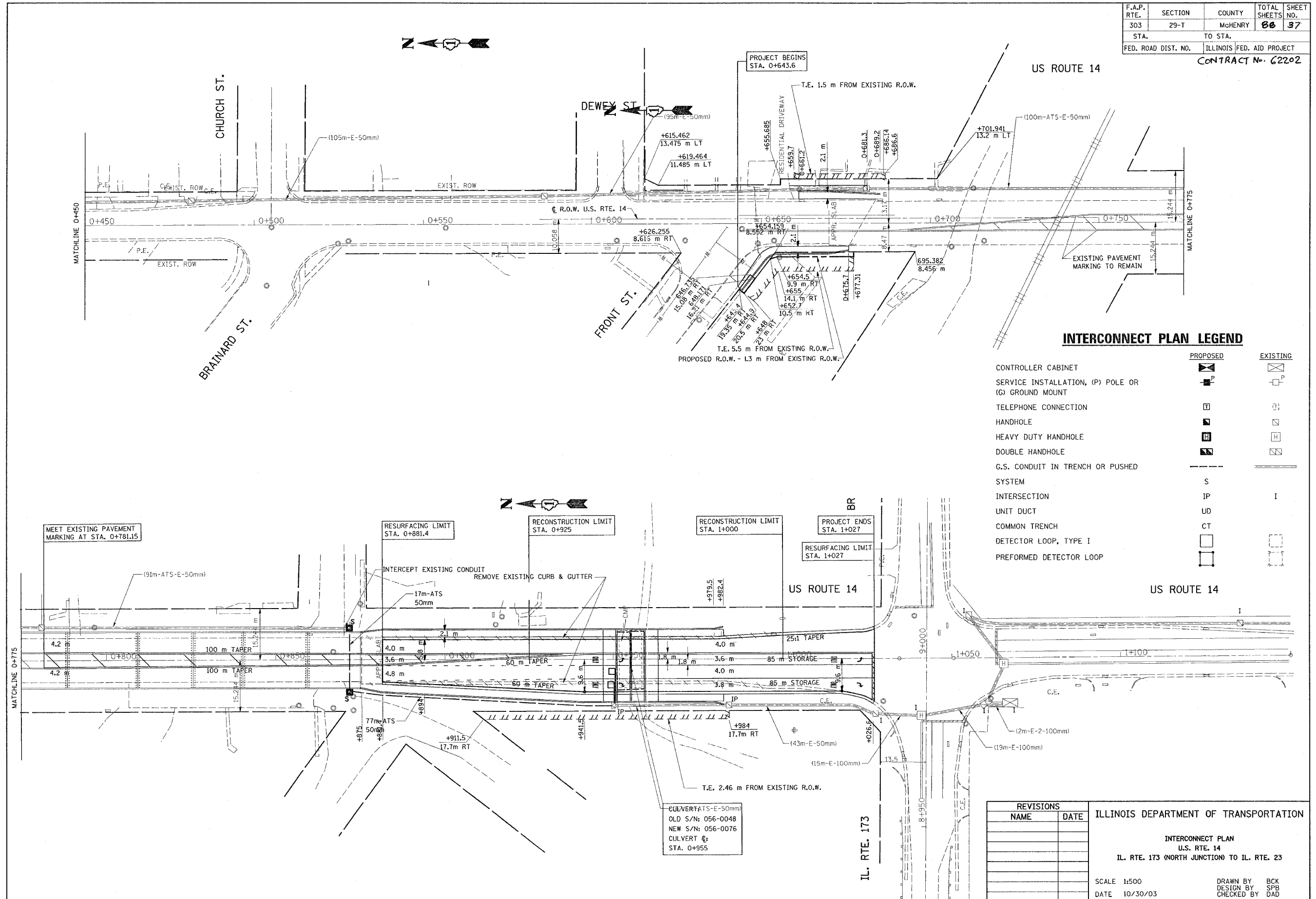

INTERCONNECT PLAN LEGEND

	PROPOSED	EXISTING
CONTROLLER CABINET	[Symbol]	[Symbol]
SERVICE INSTALLATION, (P) POLE OR (G) GROUND MOUNT	[Symbol]	[Symbol]
TELEPHONE CONNECTION	[Symbol]	[Symbol]
HANDHOLE	[Symbol]	[Symbol]
HEAVY DUTY HANDHOLE	[Symbol]	[Symbol]
DOUBLE HANDHOLE	[Symbol]	[Symbol]
G.S. CONDUIT IN TRENCH OR PUSHED	[Symbol]	[Symbol]
SYSTEM	S	
INTERSECTION	IP	I
UNIT DUCT	UD	
COMMON TRENCH	CT	
DETECTOR LOOP, TYPE I	[Symbol]	[Symbol]
PREFORMED DETECTOR LOOP	[Symbol]	[Symbol]

CULVERT AT S-E-50mm
 OLD S/N: 056-0048
 NEW S/N: 056-0076
 CULVERT @
 STA. 0+955

REVISIONS		ILLINOIS DEPARTMENT OF TRANSPORTATION
NAME	DATE	
		INTERCONNECT PLAN U.S. RTE. 14 IL. RTE. 173 (NORTH JUNCTION) TO IL. RTE. 23 SCALE 1:500 DATE 10/30/03 DRAWN BY BCK DESIGN BY SPB CHECKED BY DAD

11:16:48 08/18/2004

8/18/2004
 c:\p\jess\p44099\rd11cm32
 kathsp1.reybc