

F.A.I. SHEETS	SECTION	COUNTY	TOTAL SHEETS	SHEET NO.
90/94	2003-0311	COOK	976	89
STA. 1295+00		TO STA. 1308+00		
FED. ROAD DIST. NO.	ILLINOIS	FED. AID PROJECT		

62583

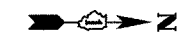

NOTES:

- SEE DRAWINGS ME-01 AND ME-02 FOR ELECTRICAL SYMBOLS AND ABBREVIATIONS.
- UNLESS NOTED OTHERWISE, ALL ITEMS AND WORK SHOWN IN HEAVY LINE WEIGHT ON THIS DRAWING ARE PROPOSED NEW ITEMS OF WORK.
- THE EXISTING ROADWAY LIGHTING SYSTEM SHALL REMAIN IN OPERATION UNTIL THE PROPOSED ROADWAY LIGHTING SYSTEM HAS BEEN INSTALLED, ENERGIZED, TESTED, AND ACCEPTED BY THE ENGINEER, UNLESS OTHERWISE DIRECTED BY THE ENGINEER.

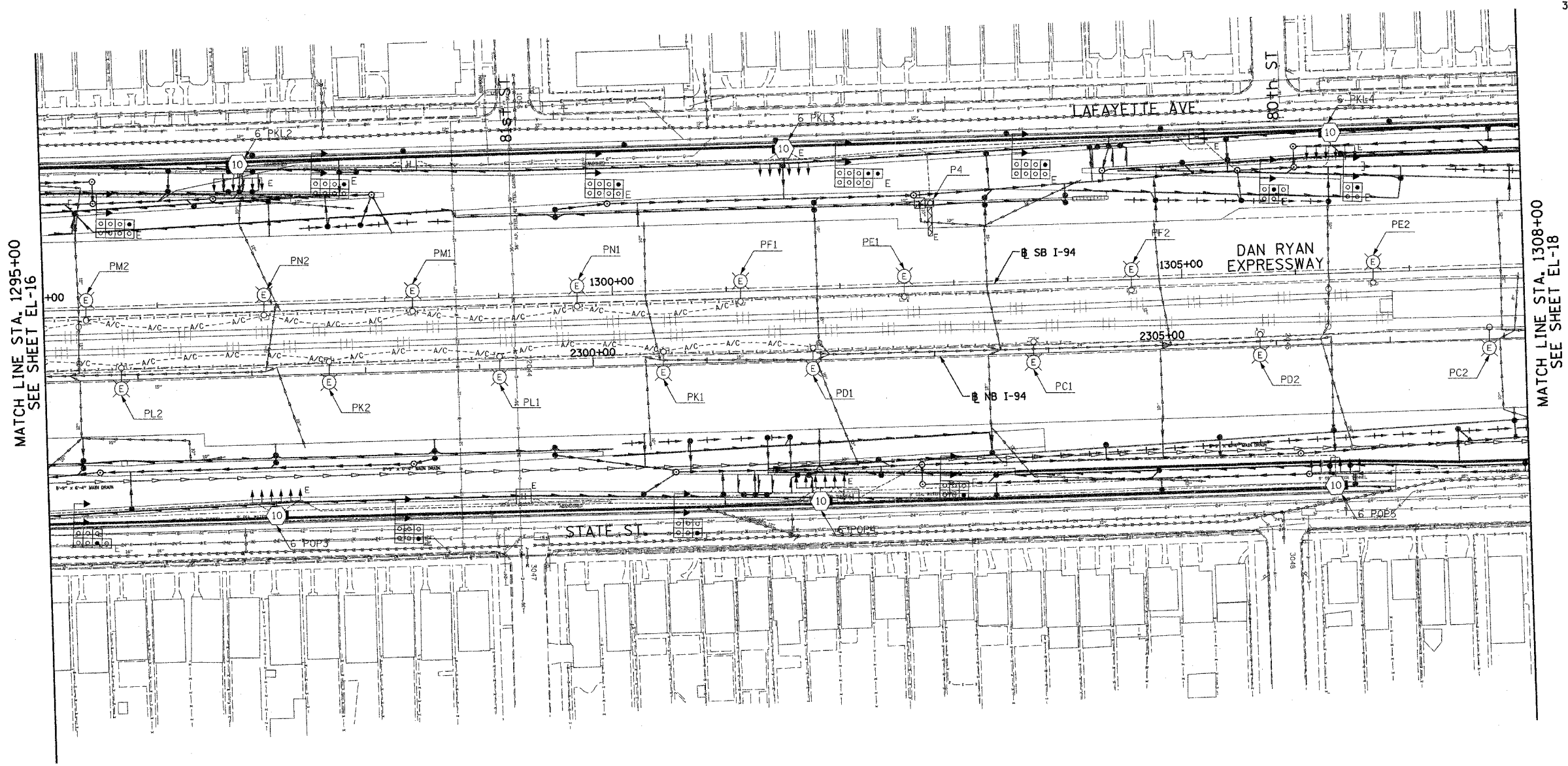

MATCH LINE STA. 1295+00
SEE SHEET EL-16

MATCH LINE STA. 1308+00
SEE SHEET EL-18



EL-17

NO ELECTRICAL WORK THIS SHEET
FOR REFERENCE ONLY

SINGH 300 W. ADAMS ST.
SINGH & ASSOCIATES, INC. CHICAGO, IL 60608
CONSULTING ENGINEERS TEL: (312) 628-0240 FAX: (312) 628-8449

REVISIONS	
NAME	DATE

ILLINOIS DEPARTMENT OF TRANSPORTATION
F.A.I. 90/94 (DAN RYAN EXPRESSWAY)
31st STREET TO I-57

ROADWAY LIGHTING PLANS EXISTING
CONDITIONS, TEMPORARY AND REMOVAL

SCALE: 1"=50' DRAWN BY: SP
DATE: OCTOBER 29, 2004 CHECKED BY: TM

10/20/2004 6:21:13 PM