

| | | | | |
|---------------------|-----------|---------------------------|--------------|-----------|
| F.A.I. RTE. | SECTION | COUNTY | TOTAL SHEETS | SHEET NO. |
| 90/94 | 2003-0311 | COOK | 976 | 132 |
| STA. 1230+00 | | TO STA. 1243+00 | | |
| FED. ROAD DIST. NO. | | ILLINOIS FED. AID PROJECT | | |

62583

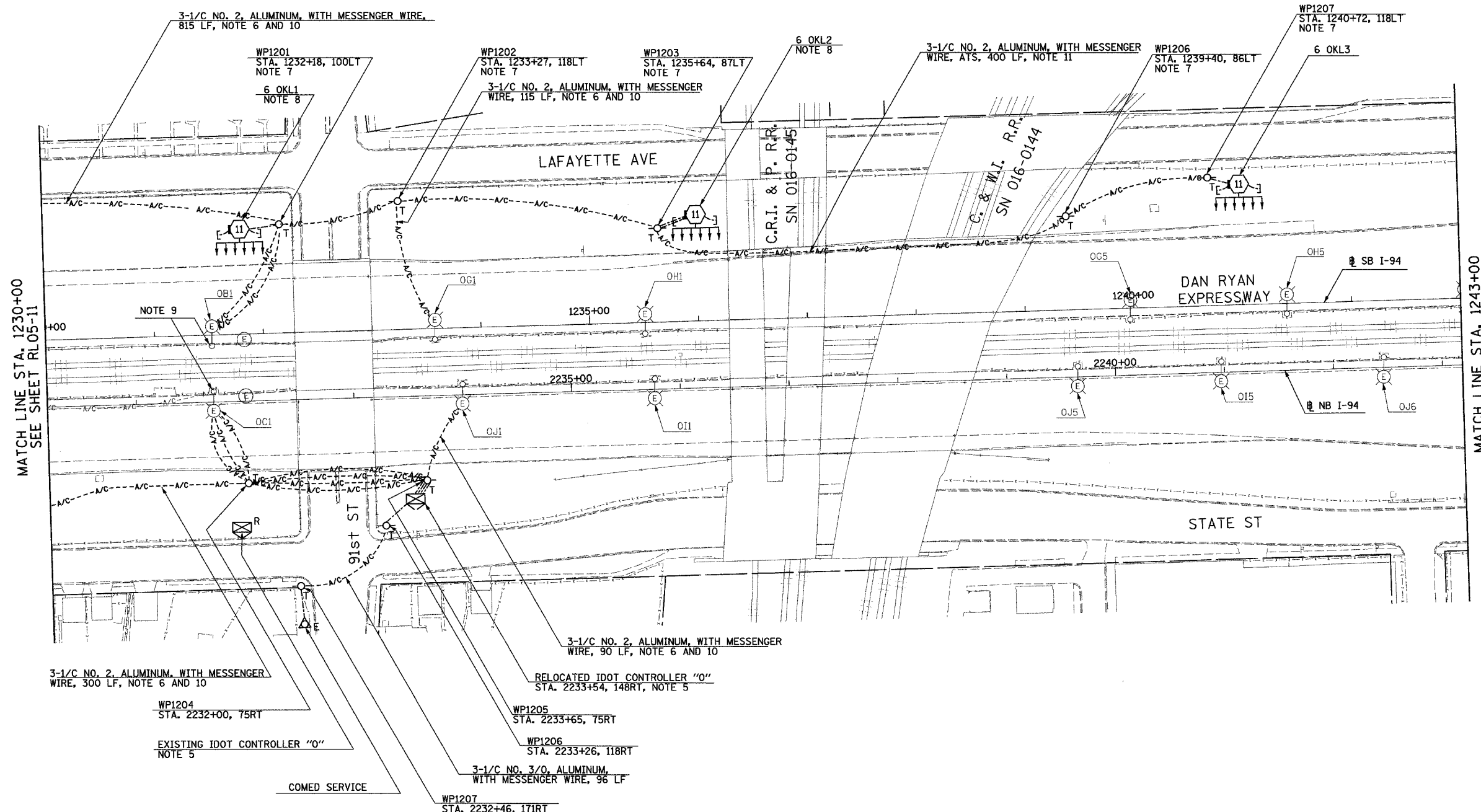

- NOTES:
- SEE DRAWINGS ME-01 AND ME-02 FOR ELECTRICAL SYMBOLS AND ABBREVIATIONS.
 - UNLESS NOTED OTHERWISE, ALL ITEMS AND WORK SHOWN IN HEAVY LINE WEIGHT ON THIS DRAWING ARE PROPOSED NEW ITEMS OF WORK.
 - SEE DRAWING ES-02 FOR HIGH MAST LIGHT TOWER SCHEDULE.
 - THE EXISTING ROADWAY LIGHTING SYSTEM SHALL REMAIN IN OPERATION UNTIL THE PROPOSED ROADWAY LIGHTING SYSTEM HAS BEEN INSTALLED, ENERGIZED, TESTED, AND ACCEPTED BY THE ENGINEER, UNLESS OTHERWISE DIRECTED BY THE ENGINEER.
 - CONTRACTOR TO COORDINATE RELOCATION OF LIGHTING CONTROLLER WITH CIVIL CONTRACT 62594 OR AS DIRECTED BY THE ENGINEER. CONTRACTOR TO COORDINATE WITH COMED TO PROVIDE TEMPORARY ELECTRIC SERVICE TO LIGHTING CONTROLLER. CONCRETE FOUNDATION SHALL BE PROVIDED FOR THE LIGHTING CONTROLLER.
 - AERIAL CABLE AND TEMPORARY WOOD POLES SHALL BE REMOVED AFTER HIGH MAST LIGHT TOWERS ARE PERMANENTLY WIRED AND ACCEPTED BY THE ENGINEER.
 - TEMPORARY WOOD POLES SHALL BE INSERTED IN GROUND TO ACCOMMODATE PROPOSED GRADING.
 - REFER SHEET ME-25 FOR TEMPORARY WIRING TO TOWER DETAIL.
 - UTILIZE EXISTING CONDUIT UNDER CTA TRACKS TO ROUTE (2) AERIAL CABLES FROM OC1 TO OBI.
 - TEMPORARY AERIAL CABLE TO PROVIDE POWER FOR EXISTING MEDIAN LIGHTING AND PROPOSED HIGH MAST LIGHT TOWERS UNTIL PERMANENT LIGHTING CONTROLLER IS INSTALLED.
 - SEE SHEET ME-25 FOR AERIAL CABLE ATTACHED TO BRIDGE DETAIL.

MATCH LINE STA. 1230+00
SEE SHEET RL05-11

MATCH LINE STA. 1243+00
SEE SHEET RL05-13

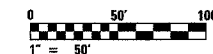

RL05-12

| REVISIONS | |
|-----------|------|
| NAME | DATE |
| | |
| | |
| | |
| | |
| | |
| | |
| | |
| | |
| | |
| | |

ILLINOIS DEPARTMENT OF TRANSPORTATION
F.A.I. 90/94 (DAN RYAN EXPRESSWAY)
31st STREET TO I-57
ROADWAY LIGHTING PLANS
PROPOSED IMPROVEMENTS 2005

SCALE: 1"=50'
DATE: OCTOBER 29, 2004

DRAWN BY: VRK
CHECKED BY: TM

SINGH 300 W. ADAMS ST.
CHICAGO, IL 60606
SINGH & ASSOCIATES, INC. TEL: (312) 629-0240
CONSULTING ENGINEERS FAX: (312) 629-8449

11/22/2004 6:27:39 PM