

F.A.I. RTE.	SECTION	COUNTY	TOTAL SHEETS	SHEET NO.
94/90	2003-0311	COOK	976	152
STA. 1536+00		TO STA. 1548+00		
FED. ROAD DIST. NO.		ILLINOIS	FED. AID PROJECT	

62583



NOTES:

- SEE DRAWINGS ME-01 AND ME-02 FOR ELECTRICAL SYMBOLS AND ABBREVIATIONS.
- UNLESS NOTED OTHERWISE, ALL ITEMS AND WORK SHOWN IN HEAVY LINE WEIGHT ON THIS DRAWING ARE PROPOSED NEW ITEMS AND WORK.
- SEE DRAWING ES-07 FOR HIGH MAST LIGHT TOWER SCHEDULE.
- PROPOSED HIGH MAST TOWERS SHALL BE INSTALLED AS INDICATED. THE TOWERS SHALL BE CONNECTED TO THE PROPOSED LIGHTING CONTROLLERS.
- AERIAL CABLE AND TEMPORARY WOOD POLES SHALL BE INSTALLED TO PROVIDE TEMPORARY CONNECTIONS FOR THE PROPOSED HIGH MAST TOWERS.
- EXISTING LIGHTING SHALL REMAIN OPERATIONAL UNTIL THE PROPOSED HIGH MAST TOWERS OR TEMPORARY LIGHTING ARE INSTALLED AND OPERATIONAL.
- TEMPORARY LIGHTING SHALL BE INSTALLED AS SHOWN, BUT NOT OPERATIONAL.
- THE HIGH MAST TOWER SHALL BE AFFIXED WITH AN EASILY REMOVABLE TEMPORARY IDENTIFICATION DECAL. PERMANENT IDENTIFICATION DECALS TO BE ADDED AT A LATER DATE.

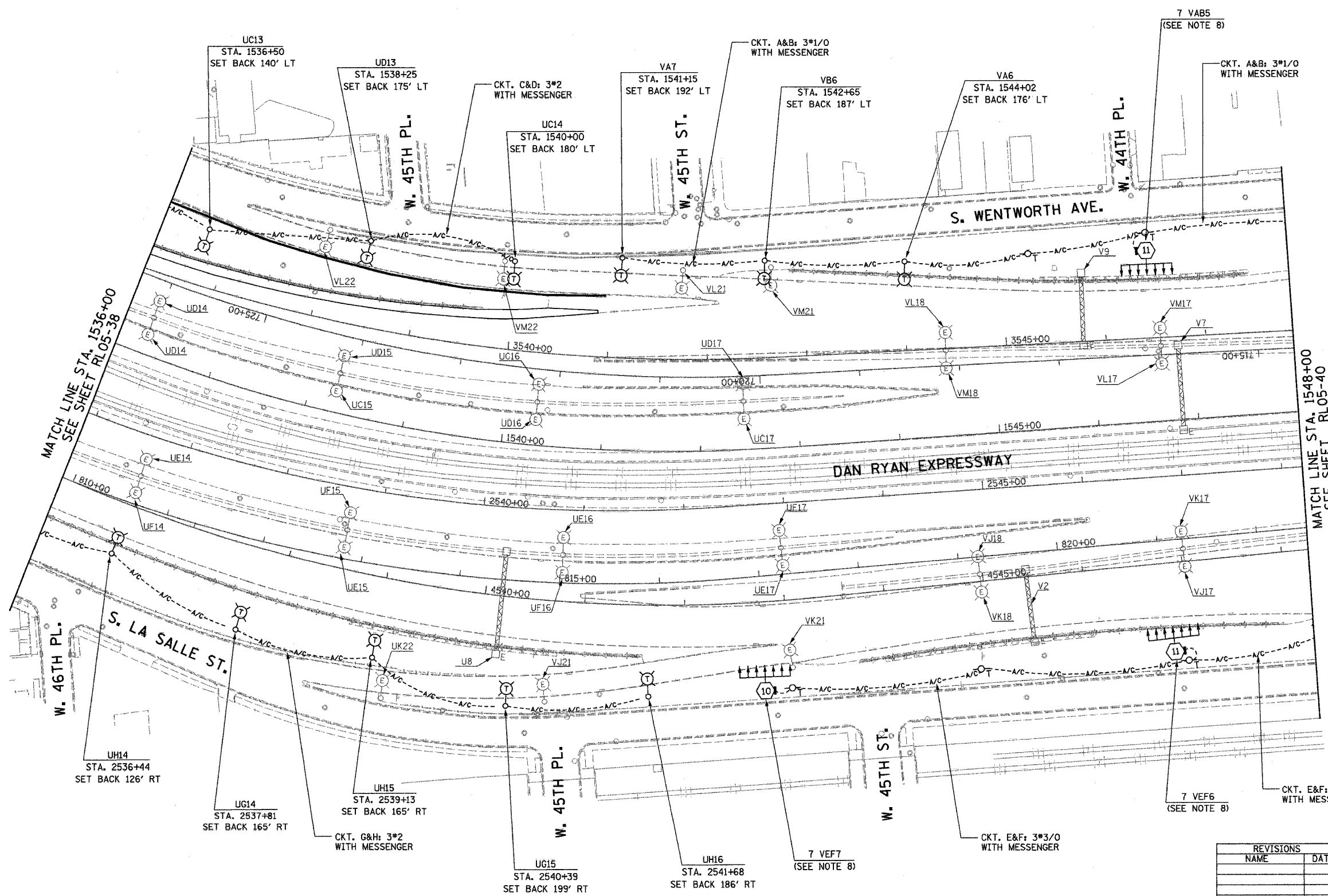

MATCH LINE STA. 1536+00
SEE SHEET RL05-38

MATCH LINE STA. 1548+00
SEE SHEET RL05-40

K&E KAM ENGINEERING, INC.
CONSULTING ENGINEERS
707A Davis Road, Suite 205
Elgin, Illinois 60123-1369

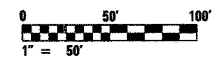

REVISIONS	
NAME	DATE

ILLINOIS DEPARTMENT OF TRANSPORTATION
F.A.I. 94/90 (DAN RYAN EXPRESSWAY)
31st STREET TO I-57

**ROADWAY LIGHTING PLANS
PROPOSED IMPROVEMENTS 2005**

SCALE: 1"=50' DRAWN BY: BL
DATE: OCTOBER 29, 2004 CHECKED BY: SM

RL05-39

10/15/2004 10:21 AM