

F.A.I. RTE.	SECTION	COUNTY	TOTAL SHEETS	SHEET NO.
90/94	2003-0311	COOK	976	164
STA. 116+00		TO STA. 129+00		
FED. ROAD DIST. NO.	ILLINOIS FED. AID PROJECT			

62583

**NOTES:**

- SEE DRAWINGS ME-01 AND ME-02 FOR ELECTRICAL SYMBOLS AND ABBREVIATIONS.
- UNLESS NOTED OTHERWISE, ALL ITEMS AND WORK SHOWN IN HEAVY LINE WEIGHT ON THIS DRAWING ARE PROPOSED NEW ITEMS OF WORK.
- THE EXISTING ROADWAY LIGHTING SYSTEM SHALL REMAIN IN OPERATION UNTIL THE PROPOSED ROADWAY LIGHTING SYSTEM HAS BEEN INSTALLED, ENERGIZED, TESTED, AND ACCEPTED BY THE ENGINEER, UNLESS OTHERWISE DIRECTED BY THE ENGINEER.
- SEE DRAWING UL-02 FOR C. & W.I. RAILROAD UNDERPASS LIGHTING PLANS.
- ALL JUNCTION BOXES MOUNTED ON OVERPASS STRUCTURES SHALL BE INSTALLED AS SHOWN ON DRAWING ME-06, UNLESS OTHERWISE NOTED.
- SIGN LUMINAIRES, DISCONNECT SWITCH AND WIRING SHALL BE PROVIDED UNDER THIS CONTRACT. SIGN STRUCTURE SHALL BE INSTALLED UNDER SEPARATE CONTRACT.  
NOTE: PROPOSED SIGN A3 SHALL BE INSTALLED AND OPERATIONAL BEFORE EXISTING SIGN A4 IS REMOVED.
- CONCRETE ENCASED DUCTBANK SHALL BE PROVIDED UNDER SEPARATE CONTRACT. UNIT DUCT SHALL BE PULLED THROUGH DUCTBANK TO HIGH MAST TOWERS IN CONTINUOUS LENGTHS WITHOUT SPLICES. REFER TO SHEET ME-11 FOR DUCTBANK DEPTH UNDER ROAD.

**NOTES CONTINUED:**

- ROUTE AERIAL CABLE ACROSS FACE OF BRIDGE ABUTMENT TO AVOID CONFLICT WITH PROPOSED CONSTRUCTION. SEE SHEET ME-25.
- AERIAL CABLE AND TEMPORARY WOOD POLES SHALL BE INSTALLED TO ALLOW HALSTED RAMP TO REMAIN OPEN DURING MAINLINE CONSTRUCTION. AERIAL CABLE AND WOOD POLES SHALL BE REMOVED AFTER PROPOSED LIGHTING IS INSTALLED, ENERGIZED AND ACCEPTED BY ENGINEER.
- REFER SHEET ME-16 FOR TEMPORARY AERIAL CABLE CONNECTION.

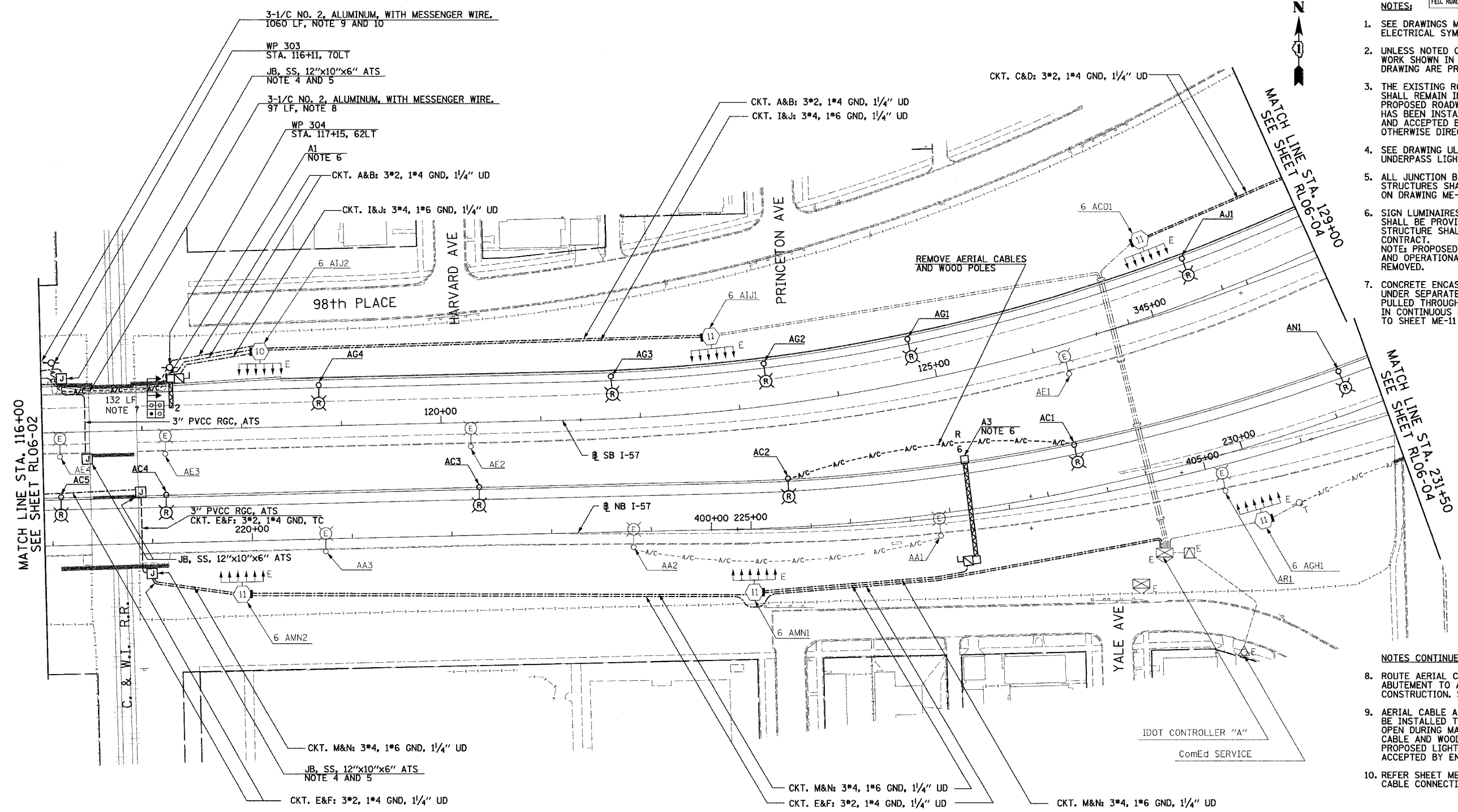

MATCH LINE STA. 116+00  
SEE SHEET RLO6-02

MATCH LINE STA. 129+00  
SEE SHEET RLO6-04

MATCH LINE STA. 231+50  
SEE SHEET RLO6-05

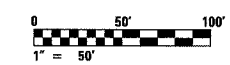

RLO6-03

**SINGH**  
SINGH & ASSOCIATES, INC.  
CONSULTING ENGINEERS

300 W. ADAMS ST.  
CHICAGO, IL 60606  
TEL: (312) 629-0240  
FAX: (312) 629-8449

REVISIONS	
NAME	DATE

ILLINOIS DEPARTMENT OF TRANSPORTATION  
F.A.I. 90/94 (DAN RYAN EXPRESSWAY)  
31st STREET TO I-57  
ROADWAY LIGHTING PLANS  
PROPOSED IMPROVEMENTS 2006

SCALE: 1"=50' DRAWN BY: VG  
DATE: OCTOBER 29, 2004 CHECKED BY: TM

11/22/2004 9:24:23 AM