

F.A.I. RTE.	SECTION	COUNTY	TOTAL SHEETS	SHEET NO.
90/94	2003-0311	COOK	976	295
STA. 1426+00.00 TO STA. 1436+00.00				
FED. ROAD DIST. NO. 1		ILLINOIS FED. AID PROJECT		

62583

**NOTES:**

1. SEE DRAWINGS ME-01 AND ME-02 FOR ELECTRICAL SYMBOLS AND ABBREVIATIONS.
2. SEE DRAWINGS ES-04 & ES-05 FOR HIGH MAST LIGHT TOWER SCHEDULE.
3. SEE DRAWING UL-26 FOR THE P. FT. W. & C. RAILROAD UNDERPASS LIGHTING PLANS.

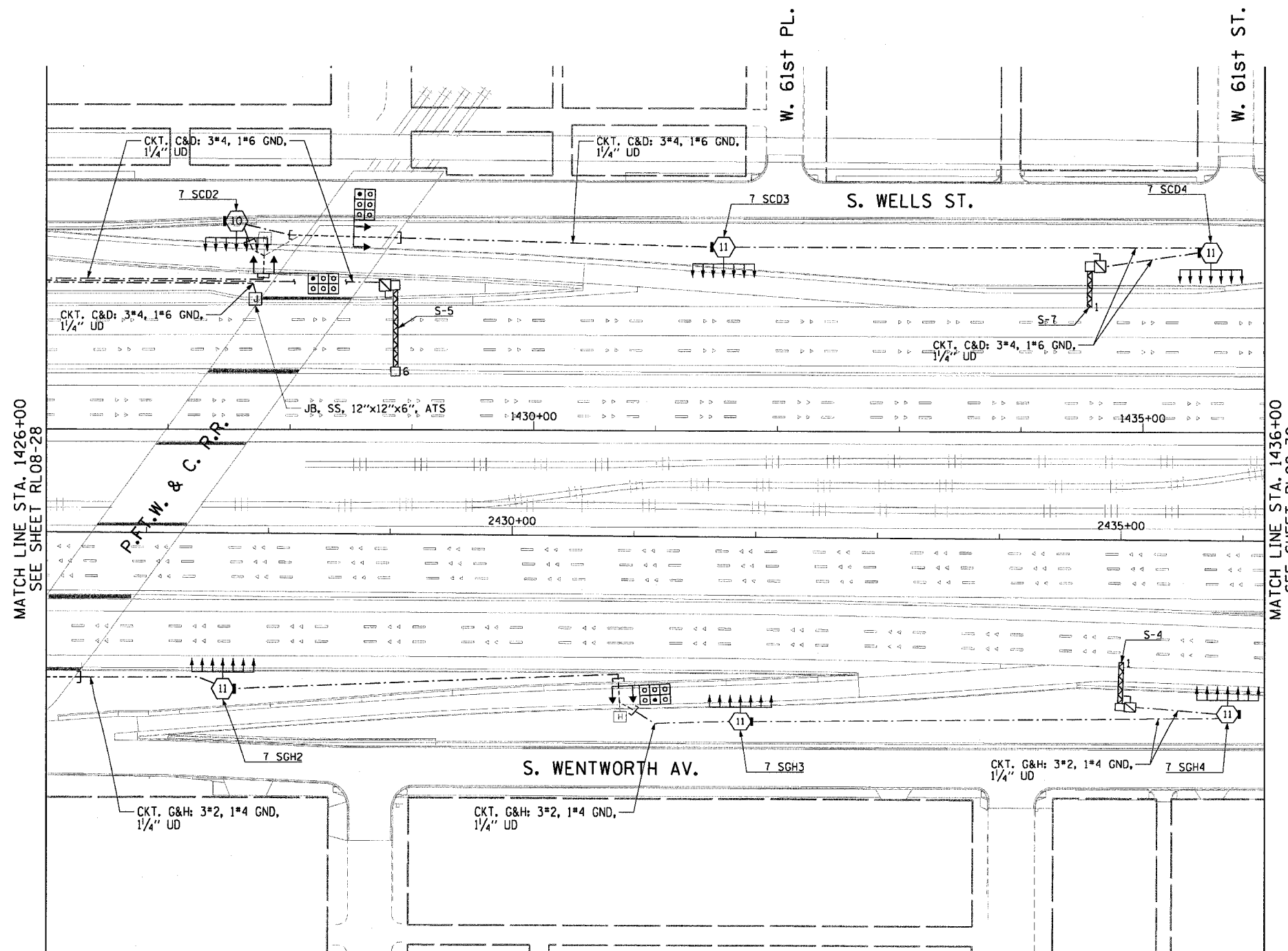
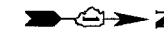

MATCH LINE STA. 1426+00  
SEE SHEET RLO8-28

MATCH LINE STA. 1436+00  
SEE SHEET RLO8-30



RLO8-29



REVISIONS	
NAME	DATE

ILLINOIS DEPARTMENT OF TRANSPORTATION  
F.A.I. 90/94 (DAN RYAN EXPRESSWAY)  
31st STREET TO I-57  
**ROADWAY LIGHTING PLANS  
FINAL CONDITIONS**

SCALE: 1"=50'  
DATE: October 29, 2004

DRAWN BY: CJM  
CHECKED BY: WDS

11/19/2004 01:05:00 PM