

F.A.I. RTE.	SECTION	COUNTY	TOTAL SHEETS	SHEET NO.
94/90	2003-0311	COOK	976	303
STA. 1632+00		TO STA. 1644+00		
FED. ROAD DIST. NO.	ILLINOIS	FED. AID PROJECT		
62583				

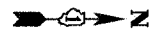

**NOTES:**  
 1. SEE SHEET ME-01 FOR ELECTRICAL SYMBOLS, ABBREVIATIONS, AND NOTES.

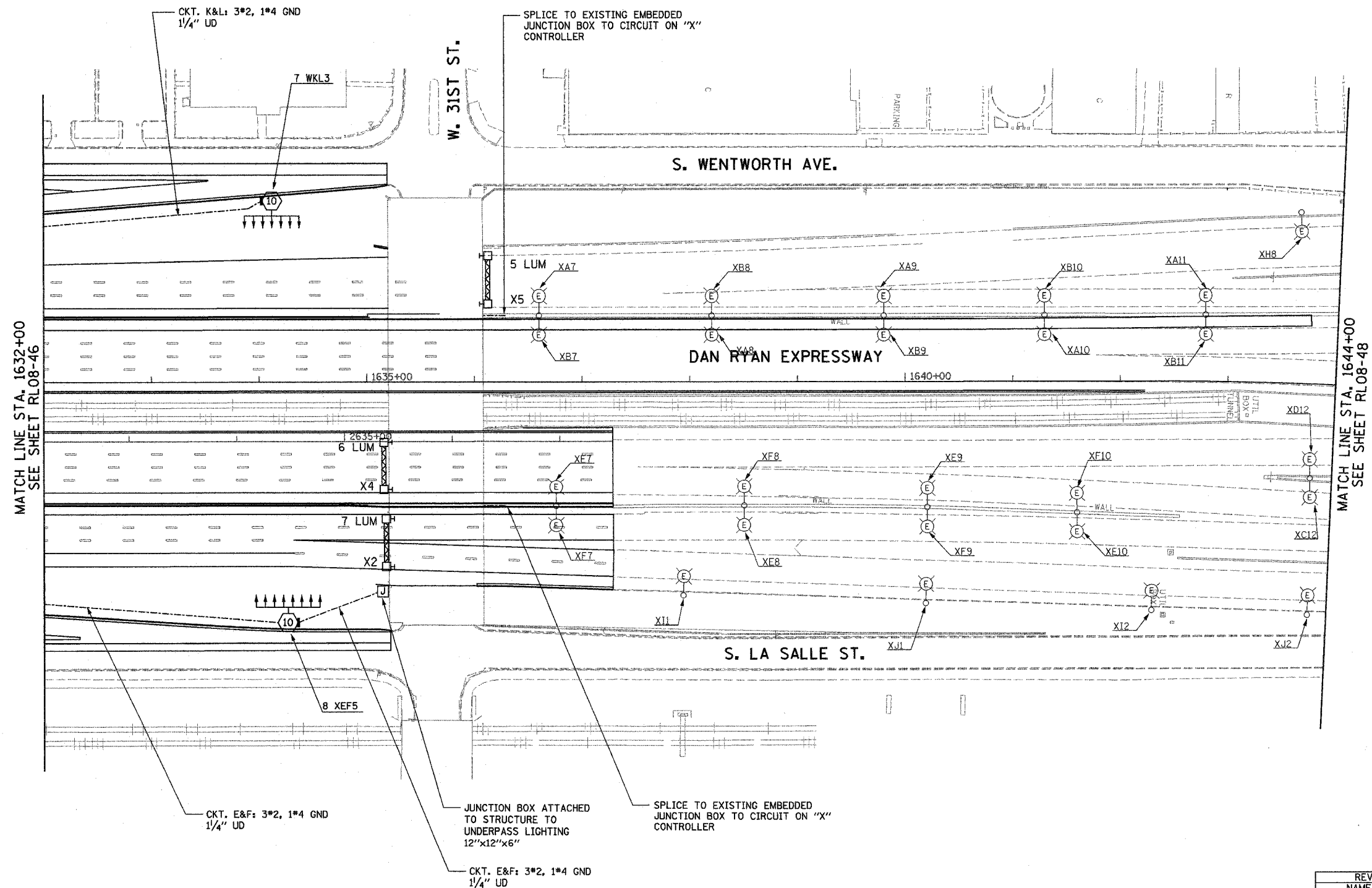

MATCH LINE STA. 1632+00  
SEE SHEET RL08-46

MATCH LINE STA. 1644+00  
SEE SHEET RL08-48

CKT. K&L: 3\*2, 1\*4 GND  
1/4" UD

SPLICE TO EXISTING EMBEDDED  
JUNCTION BOX TO CIRCUIT ON "X"  
CONTROLLER

CKT. E&F: 3\*2, 1\*4 GND  
1/4" UD

JUNCTION BOX ATTACHED  
TO STRUCTURE TO  
UNDERPASS LIGHTING  
12"x12"x6"

SPLICE TO EXISTING EMBEDDED  
JUNCTION BOX TO CIRCUIT ON "X"  
CONTROLLER

CKT. E&F: 3\*2, 1\*4 GND  
1/4" UD

**K&E** KAM ENGINEERING, INC.  
CONSULTING ENGINEERS  
707A Davis Road, Suite 205  
Elgin, Illinois 60123-1369



REVISIONS	
NAME	DATE

ILLINOIS DEPARTMENT OF TRANSPORTATION  
 F.A.I. 94/90 (DAN RYAN EXPRESSWAY)  
 31st STREET TO I-57

**ROADWAY LIGHTING PLANS  
 FINAL IMPROVEMENTS**

SCALE: 1"=50'  
 DATE: OCTOBER 29, 2004  
 DRAWN BY: BL  
 CHECKED BY: SM

RL08-47

03/25/2004 10/15/2004