

F.A.I. RTE.	SECTION	COUNTY	TOTAL SHEETS	SHEET NO.
90/94	2003-0311	COOK	176	442
STA.	TO STA.			
FED. ROAD DIST. NO.	ILLINOIS FED. AID PROJECT			

62583

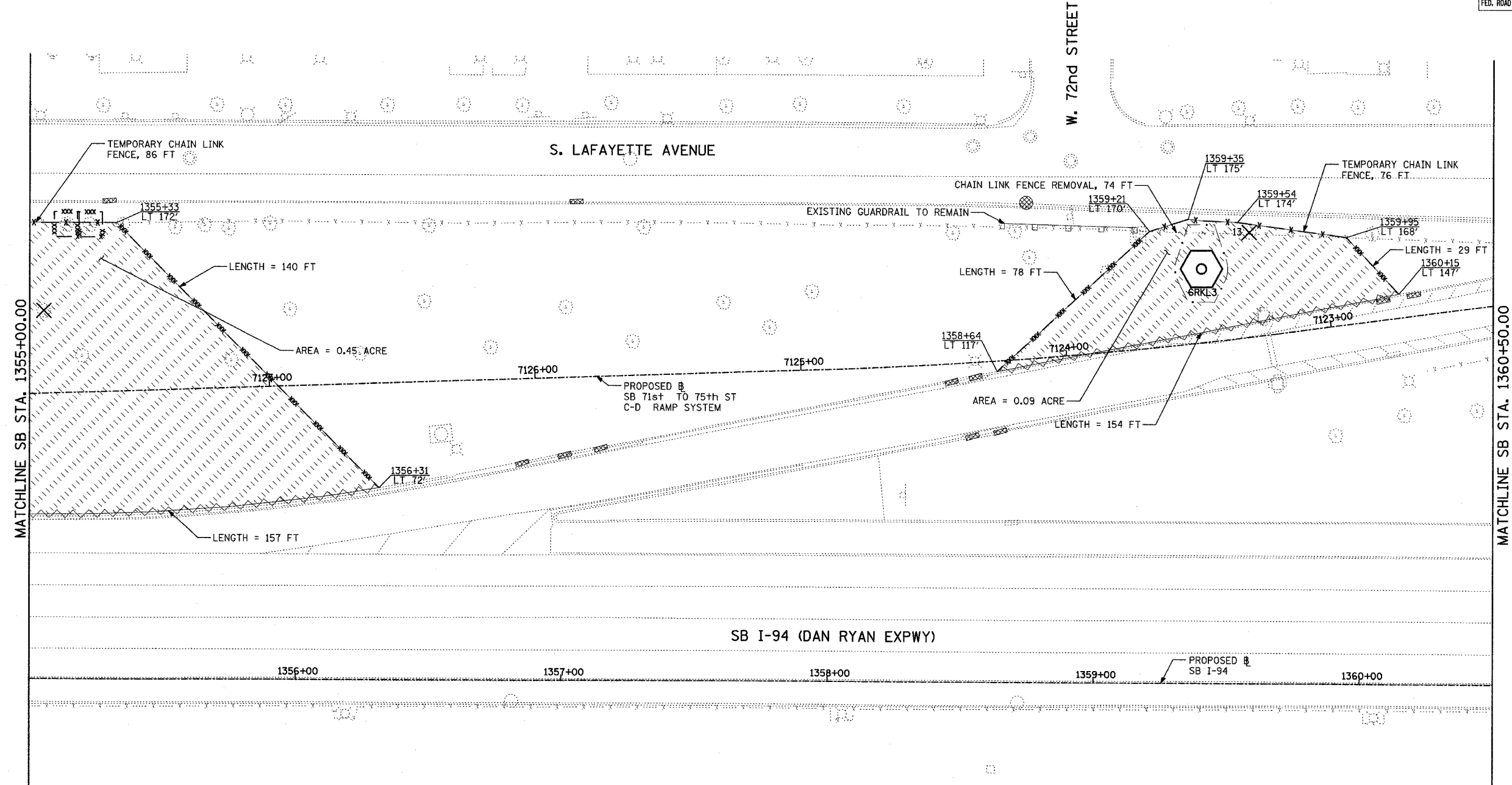
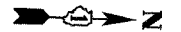

MATCHLINE SB STA. 1355+00.00

MATCHLINE SB STA. 1360+50.00

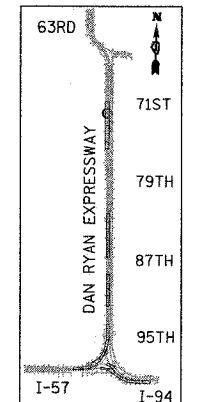

LOCATION MAP



SCALE: 1" = 20'-0"

- LEGEND:**
- TEMPORARY EROSION CONTROL SEEDING
  - PERIMETER EROSION BARRIER
  - INLET FILTER, TO BE INSTALLED IN OFF PROJECT DRAINAGE STRUCTURES ACCEPTING STORMWATER RUNOFF
  - TEMPORARY FENCE (60' PER TREE)
  - LIMITS OF GRADING
  - TREE REMOVAL (UNIT) (NO UNIT SHOWN = <6)

REVISIONS	
NAME	DATE

ILLINOIS DEPARTMENT OF TRANSPORTATION  
 F.A.I. 90/94 (DAN RYAN EXPRESSWAY)  
 31st STREET TO I-57  
 EROSION CONTROL PLAN  
 SB I-94 STA. 1355+00.00 TO 1360+50.00

SCALE: 1"=20'  
 DATE: OCTOBER 29, 2004  
 DRAWN BY: RTM, JPA  
 CHECKED BY: JPM, MAG

SHEET 31 OF 41

**TYLIN** INTERNATIONAL

P:\02373\9094\02\60281813\31.dwg 10/22/2004 10:28:59 AM