

PROFILE  
 GRADES CHECKED  
 SIGN NOTED  
 STRUCTURE NOTATIONS OK'G  
 NO.

F.A.I. RTE.	SECTION	COUNTY	TOTAL SHEETS	SHEET NO.
90/94	2003-0311	COOK	976	498
STA. 2200+00.00 TO STA. 2362+00.00		FED. ROAD DIST. NO. ILLINOIS FED. AID PROJECT		
				62583

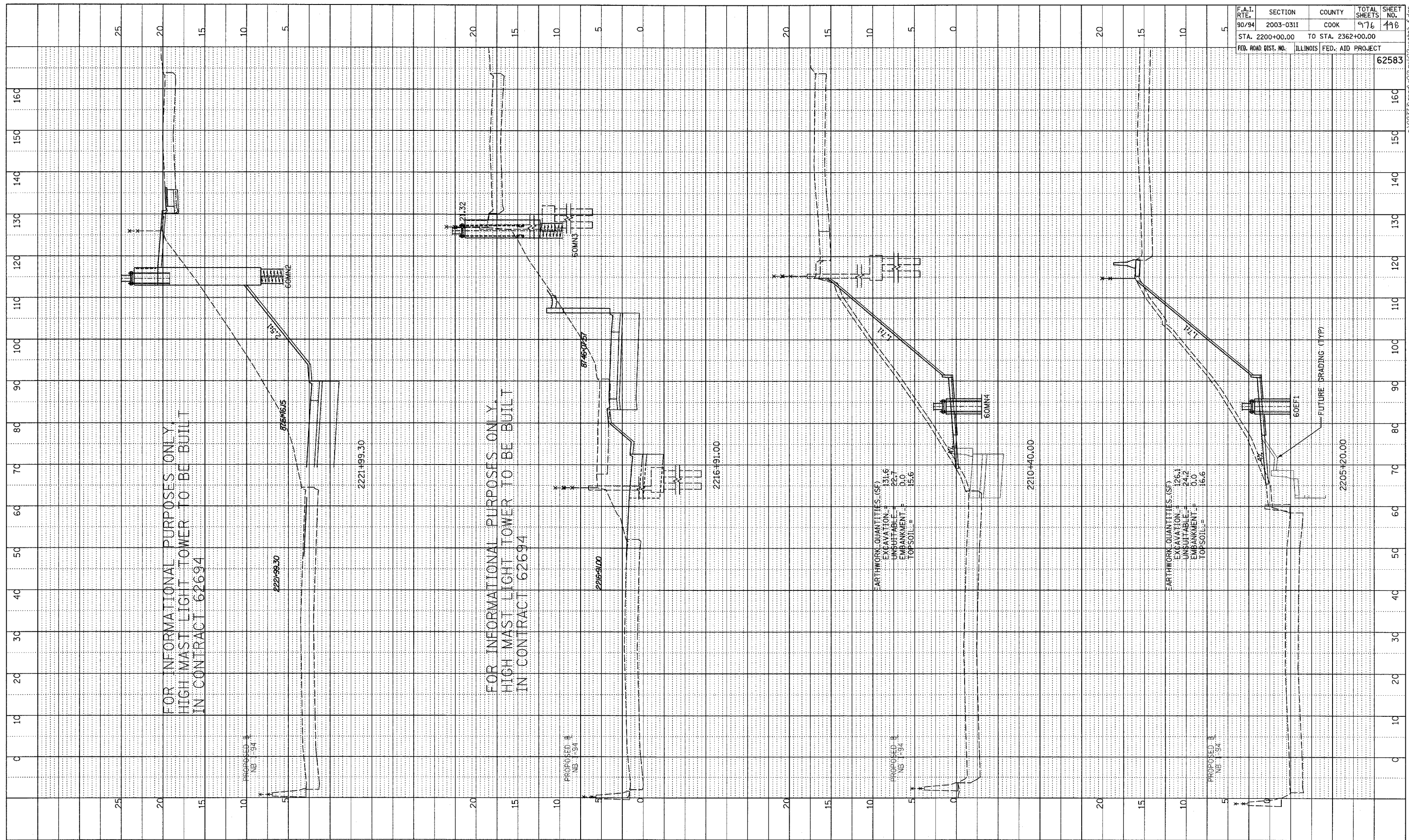

FOR INFORMATIONAL PURPOSES ONLY.  
 HIGH MAST LIGHT TOWER TO BE BUILT  
 IN CONTRACT 62694

FOR INFORMATIONAL PURPOSES ONLY.  
 HIGH MAST LIGHT TOWER TO BE BUILT  
 IN CONTRACT 62694

EARTHWORK QUANTITIES (SF)  
 EXCAVATION = 131.6  
 UNSUITABLE = 22.7  
 EMBANKMENT = 0.0  
 TOPSOIL = 15.6

EARTHWORK QUANTITIES (SF)  
 EXCAVATION = 126.1  
 UNSUITABLE = 24.2  
 EMBANKMENT = 0.0  
 TOPSOIL = 16.6

TYLIN INTERNATIONAL

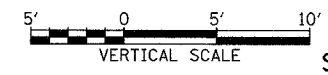
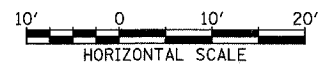

NB I-94 (DAN RYAN EXPRESSWAY)  
 STA. 2205+20 TO STA. 2221+99.30

PA023737000v02.dwg/02583.mw\_f.dgn