

NOTE BOOK
 NO. _____
 PLOTTED
 CHECKED
 STRUCTURE NOTATIONS CHKD

F.A.I. RTE.	SECTION	COUNTY	TOTAL SHEETS	SHEET NO.
90/94	2003-0311	COOK	976	501
STA. 2200+00.00 TO STA. 2362+00.00		ILLINOIS FED. AID PROJECT		
FED. ROAD DIST. NO.		62583		

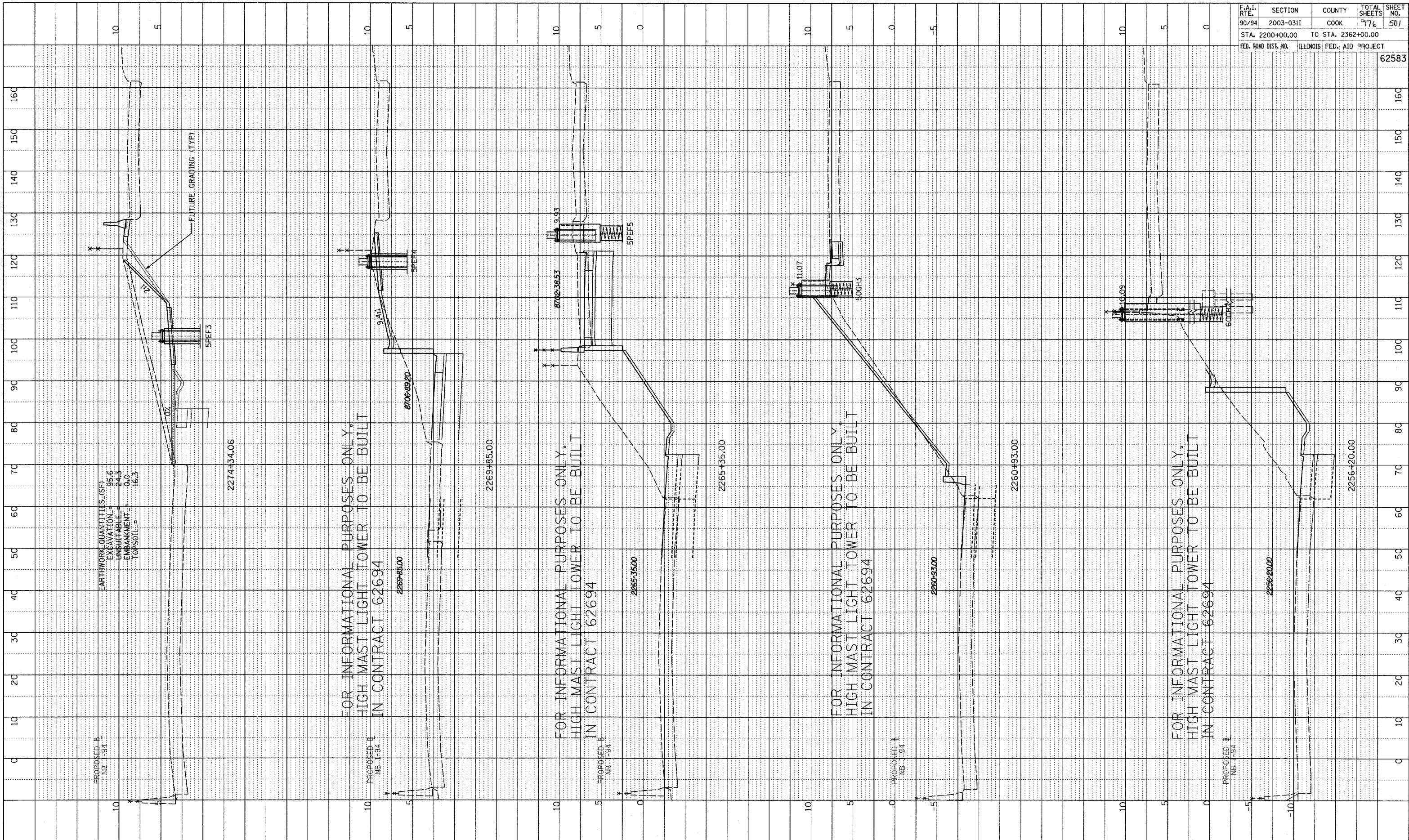

TYLIN INTERNATIONAL

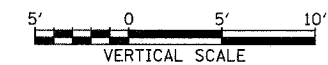

NB I-94 (DAN RYAN EXPRESSWAY)
 STA. 2256+20 TO 2274+34.06