

SURVEYED
 GRADES CHECKED
 B.M. NOTED
 STRUCTURE NOTATIONS OK'D
 NO. _____

F.A.I. RTE.	SECTION	COUNTY	TOTAL SHEETS	SHEET NO.
90/94	2003-0311	COOK	976	502
STA. 2200+00.00 TO STA. 2362+00.00		FED. ROAD DIST. NO. ILLINOIS FED. AID PROJECT		
				62583

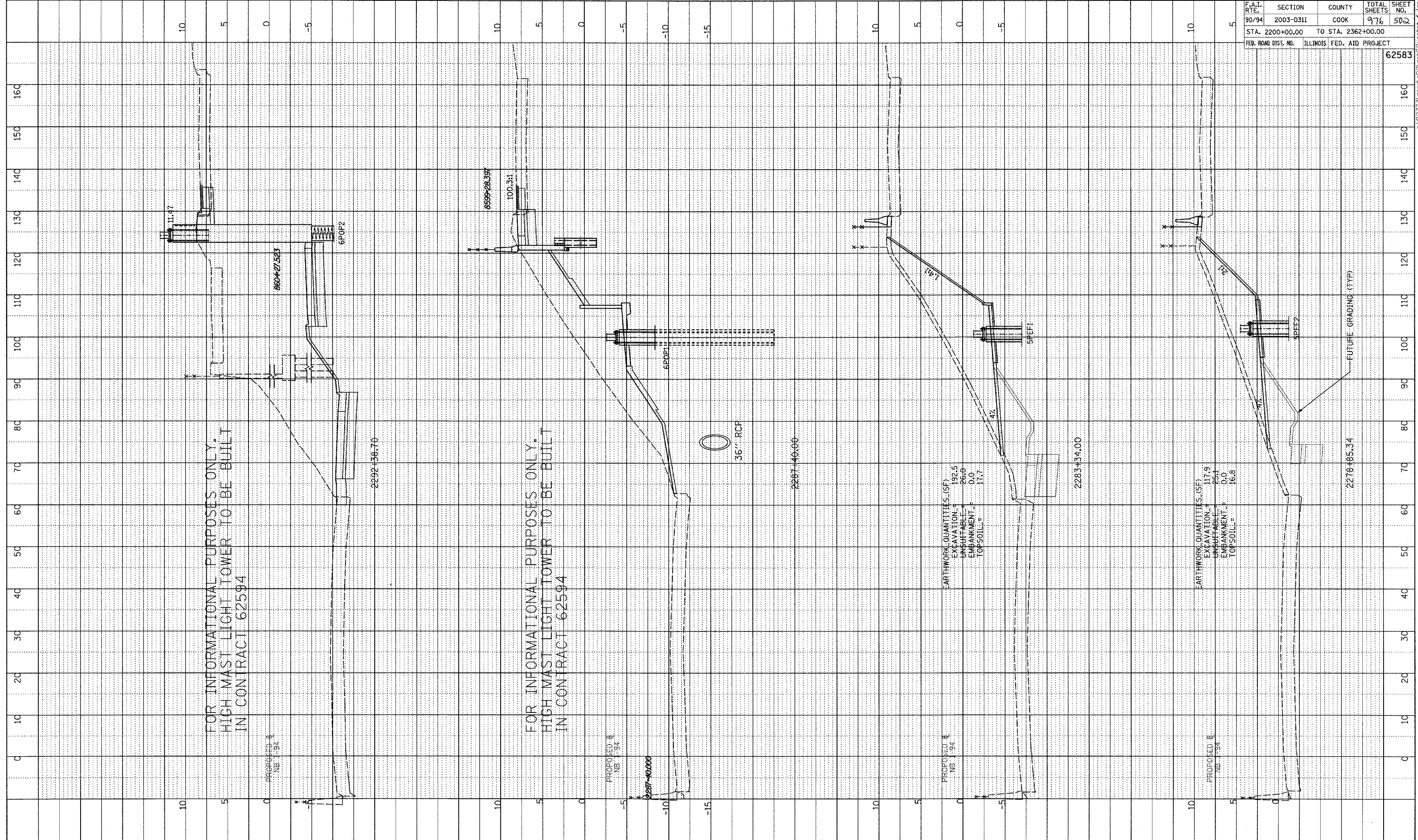

TYLIN INTERNATIONAL

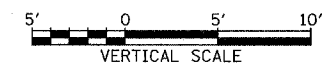
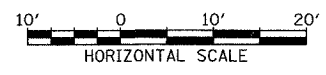

NB I-94 (DAN RYAN EXPRESSWAY)
 STA. 2278+85.34 TO 2292+38.70

P:\0231\3\road\02\gpr\02\ssmb_f.dgn