

PROFILE
 DRAWING NO. 1274-15-86
 DATE 11/15/94
 DRAWN BY J. W. HARRIS
 CHECKED BY J. W. HARRIS
 IN CHARGE BY J. W. HARRIS

F.A.I. RTE.	SECTION	COUNTY	TOTAL SHEETS	SHEET NO.
90/94	2003-0311	COOK	976	512
STA. 2200+00.00 TO STA. 2362+00.00		FED. ROAD DIST. NO. ILLINOIS FED. AID PROJECT		
				62583

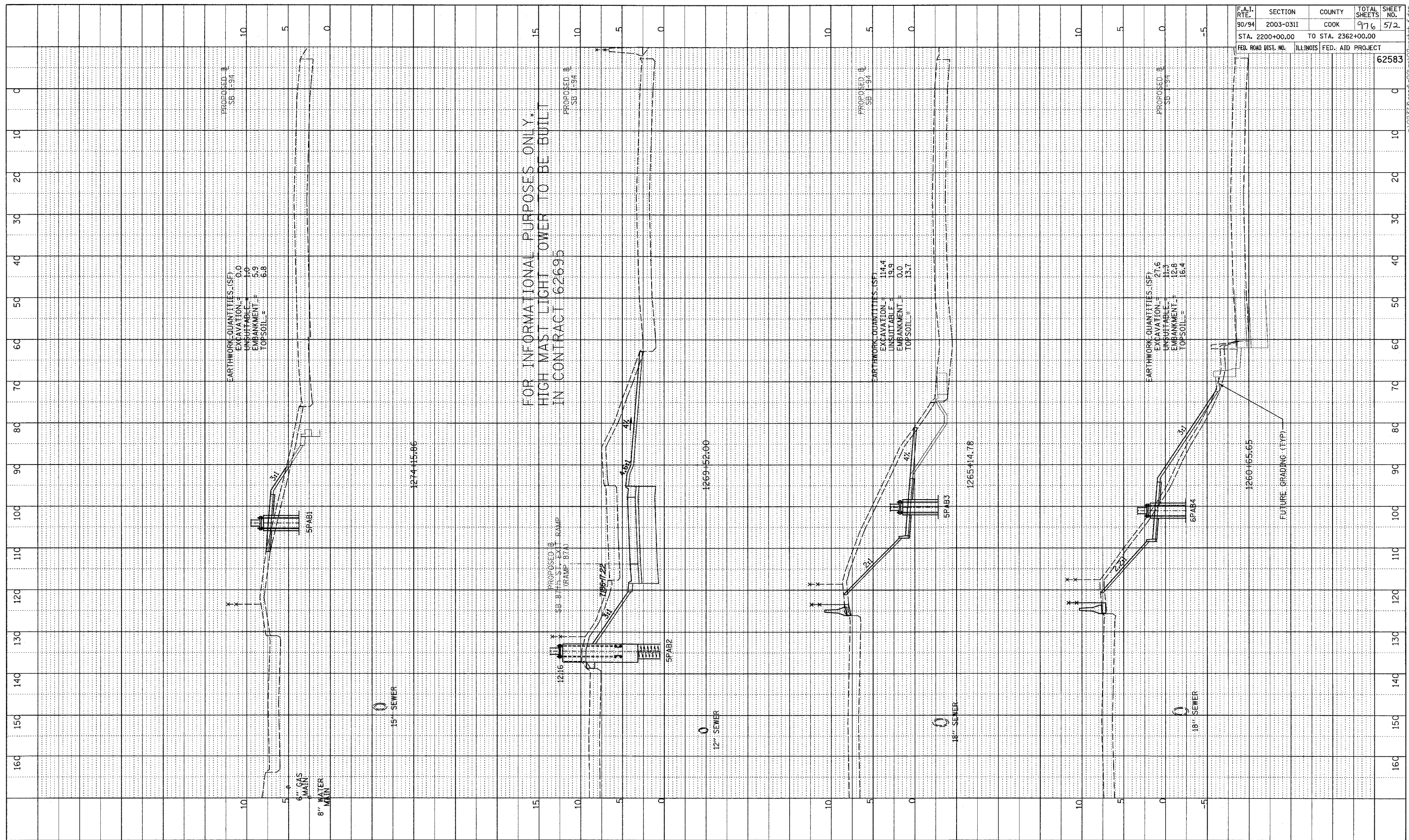

TYLIN INTERNATIONAL

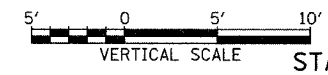
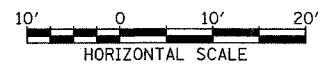

SB I-94 (DAN RYAN EXPRESSWAY)
 STA. 1260+65.65 TO STA. 1274+15.86

1274-15-86-512.dwg