

| | | | |
|------------------------------|--------|---------------------------|-----------|
| SECTION | COUNTY | TOTAL SHEETS | SHEET NO. |
| 2003-03II | COOK | 976 | 698 |
| STA. 1548+00 TO STA. 1560+00 | | ILLINOIS FED. AID PROJECT | |
| FED. ROAD DIST. NO. 62583 | | | |

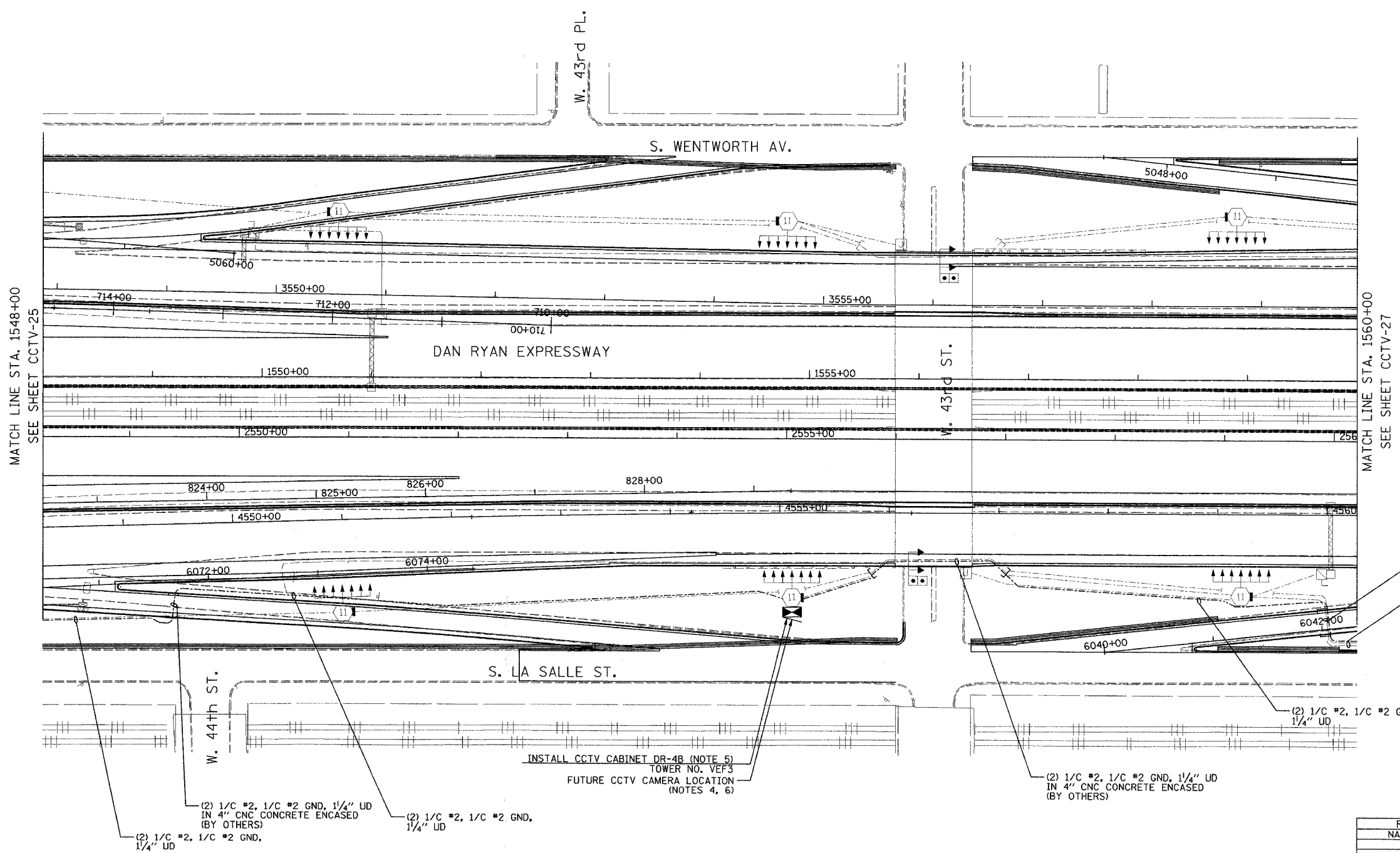

- NOTES:**
1. SEE DRAWINGS ME-01 AND ME-02 FOR ELECTRICAL SYMBOLS AND ABBREVIATIONS.
 2. UNLESS OTHERWISE STATED, ALL CONDUIT TO BE FURNISHED AND INSTALLED UNDER THIS CONTRACT.
 3. UNLESS OTHERWISE STATED, ALL ELECTRIC CABLE TO BE FURNISHED AND INSTALLED UNDER THIS CONTRACT.
 4. SEE DRAWING COMM-40 FOR CCTV COMMUNICATIONS SYSTEM CONDUIT AND CABLE LAYOUT.
 5. SEE DRAWING DT-17 FOR CCTV CABINET MOUNTING DETAILS ON A HIGH-MAST LIGHT TOWER.
 6. CONTRACTOR SHALL SPLICE (2) 1/C #2, 1/C #2 GND IN CCTV CABINET DR-4B FOR CABINET DR-4C POWER FEED. SEE DRAWING CCTV-25 FOR CONTINUATION.

(2) 1/C #2, 1/C #2 GND, 1/4" UD IN 4" CNC CONCRETE ENCASED (BY OTHERS)

(2) 1/C #2, 1/C #2 GND, 1/4" UD

(2) 1/C #2, 1/C #2 GND, 1/4" UD

(2) 1/C #2, 1/C #2 GND, 1/4" UD IN 4" CNC CONCRETE ENCASED (BY OTHERS)

(2) 1/C #2, 1/C #2 GND, 1/4" UD IN 4" CNC CONCRETE ENCASED (BY OTHERS)

(2) 1/C #2, 1/C #2 GND, 1/4" UD

INSTALL CCTV CABINET DR-4B (NOTE 5)
TOWER NO. VEF3
FUTURE CCTV CAMERA LOCATION
(NOTES 4, 6)

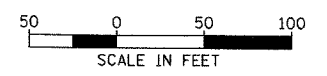

| REVISIONS | |
|-----------|------|
| NAME | DATE |
| | |
| | |
| | |
| | |
| | |
| | |
| | |
| | |
| | |
| | |

ILLINOIS DEPARTMENT OF TRANSPORTATION
F.A.I. 94/90 (DAN RYAN EXPRESSWAY)
31st STREET TO I-57
CLOSED CIRCUIT TELEVISION
SITE LAYOUT
CAMERA DR-4C (SHEET 2 OF 3)
CAMERA DR-4B (SHEET 1 OF 2)
SCALE: 1"=50'
DATE: October 29, 2004
DRAWN BY: DHI
CHECKED BY: MJL

Edwards AND Kelcey
ONE NORTH FRANKLIN
CHICAGO, IL 60606
PHONE: (312) 251-3000
FAX: (312) 251-3015
WEB: WWW.EXCORP.COM

10/14/2004 09:23:33 AM