

62806

F. A. RTE	SECTION	COUNTY	TOTAL SHEETS	SHEET NO.
90/94	*	COOK	35	23
STA. 565+60		TO STA. 581+95		
FED. ROAD DIST. NO. 1		ILLINOIS		FED AID PROJECTS



FOR INSTALLATION PLAN SEE SHEET 04-018  
FOR REMOVAL PLAN SEE SHEET 04-025

\* 2004-067L

MATCH LINE  
STATION 565+60  
SEE SHEET 04-004

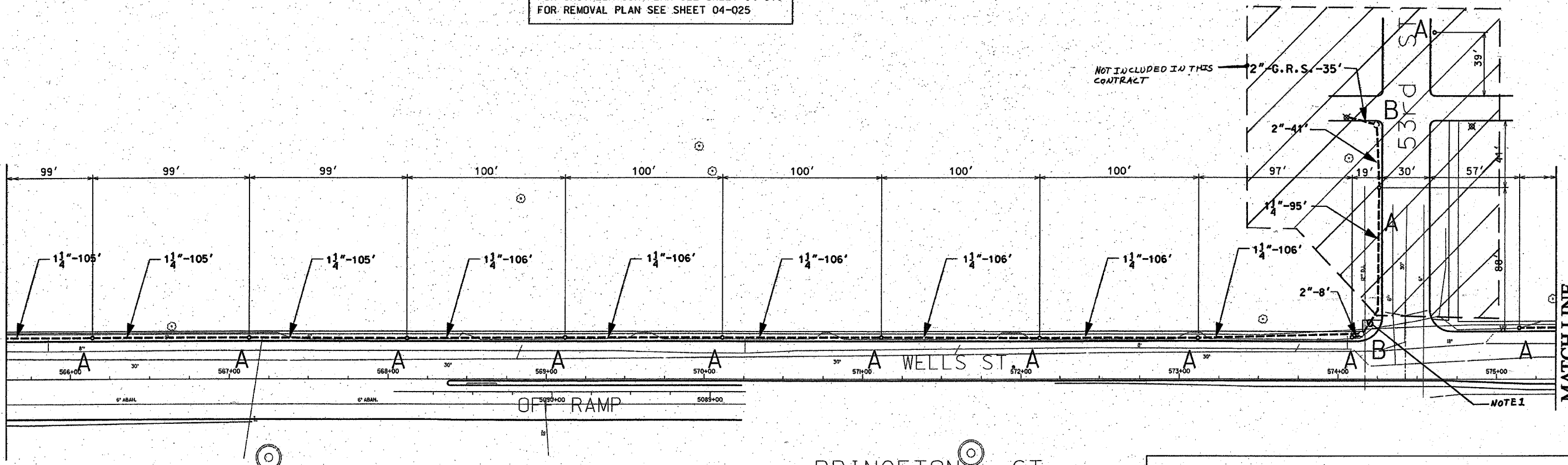

MATCH LINE  
STATION 575+35

- 1 1/4" DIRECT BORED CONDUIT SCHEDULE #80 AS PER IDOT ARTICLE 810.03
- 2" DIRECT BORED CONDUIT SCHEDULE #80 AS PER IDOT ARTICLE 810.03
- 2" CONDUIT SCHEDULE #40 INSTALLED IN TRENCH AS PER IDOT ARTICLE 810.03
- 2" GALVANIZED RIGID STEEL ELBOW ON STRUCTURE
- 2" GALVANIZED RIGID STEEL CONDUIT INSTALLED IN TRENCH AS PER IDOT ARTICLE 810.03
- HAND HOLE - 30" x 36" WITH 24" FRAME AND COVER
- CONCRETE FOUNDATION - 5' x 20", 10" B.C., 1" ANCHOR RODS

NOTES: CONTRACTOR IS TO INSTALL UNDERGROUND CONDUIT AND PULL ROPE BETWEEN FOUNDATIONS AS WELL AS PERFORM THE FOLLOWING WORK ITEMS ACCORDING TO BUREAU OF ELECTRICITY SPECIFICATIONS:  
"A" - INSTALL 20" x 5' FOUNDATION, 10" B.C., 1" ANCHOR RODS AS PER DRAWING NO. 565, 2' OFF FACE OF CURB, UNLESS NOTED OTHERWISE. BUILD FOUNDATIONS FLUSH WITH SIDEWALK SURFACE.  
"B" - INSTALL 30" HANDHOLE AS PER DRAWING NO. 867 WITH 24" FRAME AND COVER.

MATCH LINE  
STATION 575+35

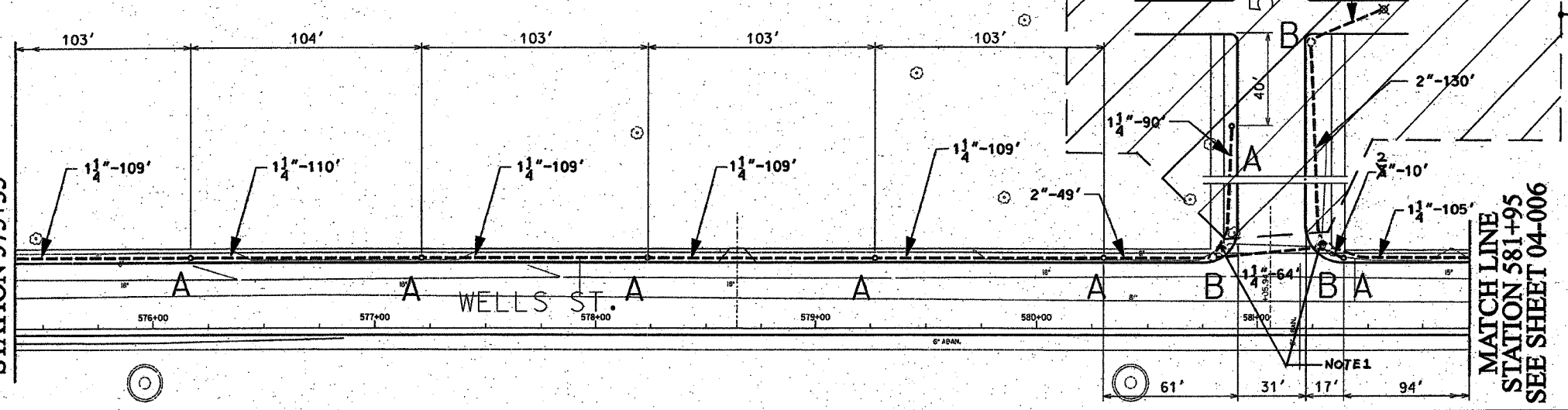

MATCH LINE  
STATION 581+95  
SEE SHEET 04-006

NOT INCLUDED IN THIS CONTRACT

NOTES:  
1. PROVIDE A CONDUIT STOP AT HANDHOLE, EXTENDING TO ONE FOOT PAST THE LIMITS OF SIDEWALK REPLACEMENT. PROVIDE A CONDUIT CAP FOR THE CONDUIT STOP. THE CONDUIT CAP WILL BE INCLUDED IN THE UNIT PRICE FOR THE CONDUIT OF SPECIFIED TYPE AND DIAMETER. NO SEPARATE PAYMENT WILL BE MADE. SEE IDOT CONTRACT NOS. 62586 AND 62795 FOR LIMITS OF SIDEWALK REPLACEMENT.

REVISIONS	
NAME	DATE

CITY OF CHICAGO  
DEPT. OF STREETS AND SANITATION  
BUREAU OF ELECTRICITY  
DIVISION OF ELECTRICAL ENGINEERING

DRAFTSMAN B. GARNSEY	CHIEF DRAFTSMAN ROBERT CARTER	ENGINEER B. GARNSEY
SUPERVISING ENGINEER	ELEC. DESIGN ENGR.	DWG. NO. <b>04-005</b>
ENGINEER OF ELECTRICITY		DATE: 1/20/04
GEN'L Supt. OF ELECTRICITY		
DEPUTY COMMISSIONER		

ILLINOIS DEPARTMENT OF TRANSPORTATION  
F.A.I. 90/94 (DAN RYAN EXPRESSWAY)  
59th St. TO 47th St. (FRONTAGE ROADS)

STREET LIGHTING  
UNDERGROUND CONDUIT FACILITIES

SCALE: 1" = 30'  
DATE: February 11, 2005  
DRAWN BY: B.T.G.  
CHECKED BY: O.L.