

STATE OF ILLINOIS  
DEPARTMENT OF TRANSPORTATION

|                       |         |           |                  |       |                 |
|-----------------------|---------|-----------|------------------|-------|-----------------|
| ROUTE NO.             | SECTION | COUNTY    | SHEET NO.        | SHEET | SHEET NO. 1     |
|                       | 7       | Winnebago | 36               | 18    | 9 SHEETS        |
| FED. ROAD DIST. NO. 7 |         | ILLINOIS  | FED. AID PROJECT |       |                 |
| * (5VB, 5HB, 1-2HB)M  |         |           |                  |       | CONTRACT #64A88 |

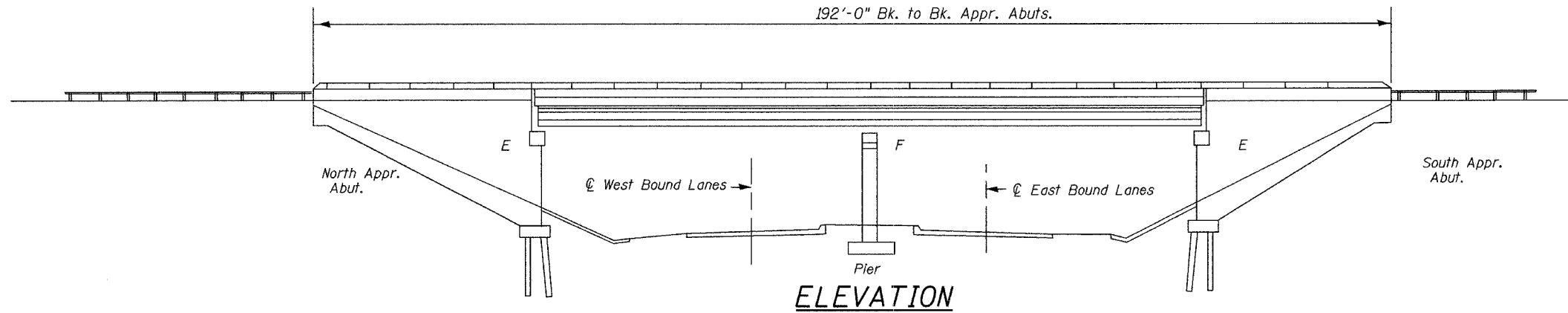

**GENERAL NOTES**

All new structural steel shall conform to AASHTO Classification M-270, Gr. 36 unless otherwise noted.

Reinforcement bars shall conform to the requirements of AASHTO M-31 or M-322, Grade 60.

Prior to pouring the new concrete, all loose rust, loose mill scale, and other loose potentially detrimental foreign material shall be removed from the surfaces of the beams or girders in contact with concrete. The cost of this work will be included in the bid item covering removal of the existing concrete. All heavy rust and other tightly adhered potentially detrimental foreign matter shall also be removed from the surfaces of the beams or girders in contact with concrete. Tightly adhered paint may remain unless otherwise noted. This removal shall be accomplished by methods that will not damage the steel. The cost of this work will be paid for according to article 109.04 of the standard specifications.

Any reinforcement bars that are damaged during concrete removal shall be replaced with an approved bar splicer or anchorage system. Cost shall be included in the cost of "Concrete Removal".

Existing longitudinal reinforcement extending into the removed area shall be cleaned, straightened and incorporated into the new construction. Existing transverse reinforcement may be cut as shown and removed.

All new structural steel shall be shop painted with the inorganic zinc rich primer per AASHTO M 300, Type 1. Cost included with Furnishing and Erecting Structural Steel.

During construction operations, the Contractor shall provide temporary shielding from shoulder to shoulder of the roadway crossed. See Special Provisions.

Joint openings shall be adjusted according to Article 503.10(c) of the Standard Specifications when the deck is poured at an ambient temperature other than 50° F.

These structures will retain the same numbers 101-0031 & 101-0032.

Plan dimensions and details relative to existing structure have been taken from existing plans and are subject to nominal construction variations. It shall be the Contractor's responsibility to verify such dimensions and details in the field and make necessary approved adjustments prior to construction or ordering of materials. Such variations shall not be cause for additional compensation for a change in the scope of work; however, the Contractor will be paid for the quantity actually furnished at the unit price bid for the work.

The existing structural steel coating contains lead. The contractor should take appropriate precautions to deal with the presence of lead on this project.

The Contractor shall use extreme care during concrete removal so as not to damage the PPC I-Beam.

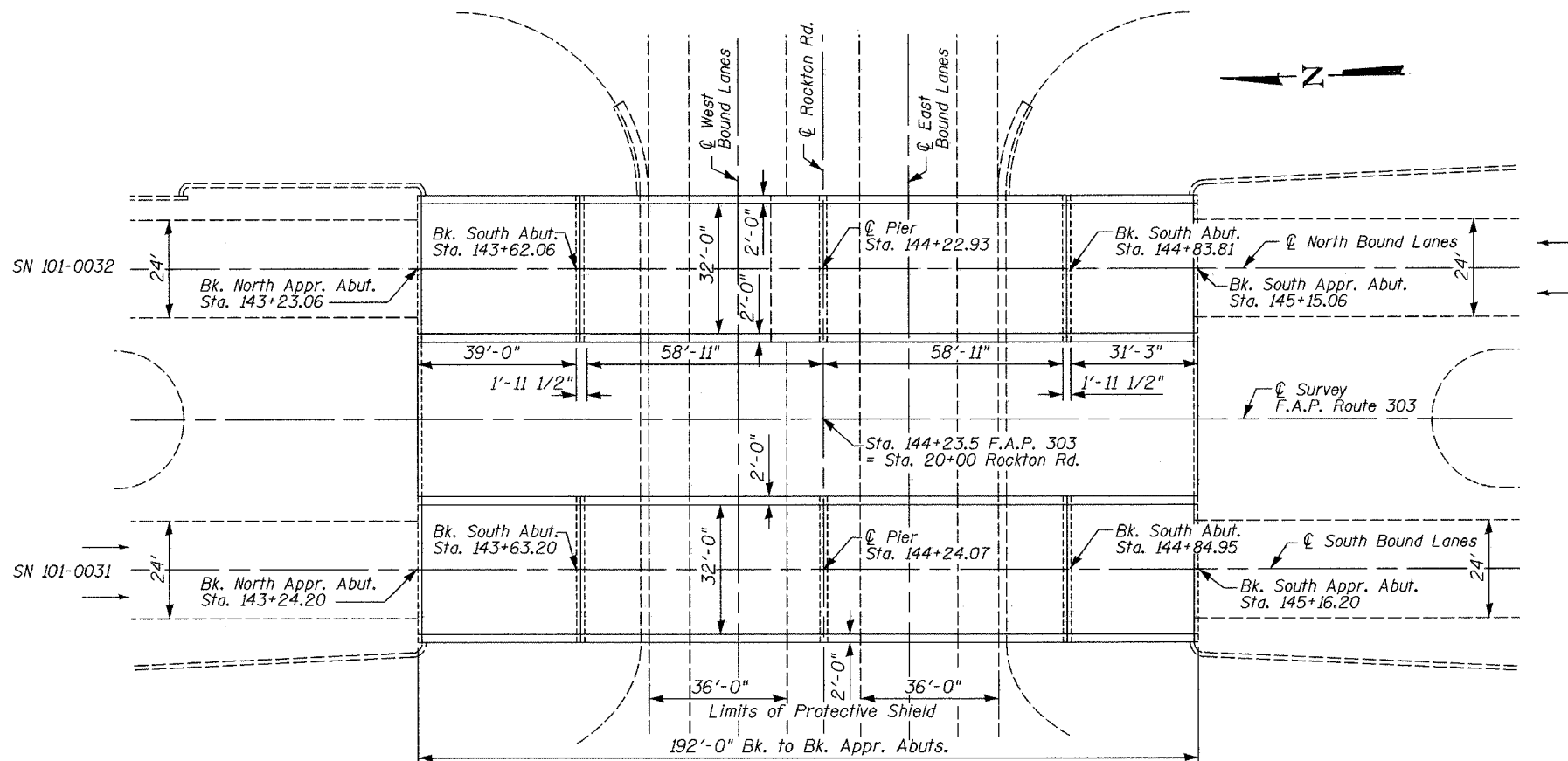

**TOTAL BILL OF MATERIAL - 2 BRIDGES**

| ITEM   | UNIT    | TOTAL |
|--|---------|-------|
| Bituminous Concrete Removal (Deck)                         | Sq Yd   | 1380  |
| Bituminous Concrete Surface Course, Superpave, Mix "D" N90 | TON     | 150   |
| Deck Slab Repair (Full Depth, Type 1)                      | Sq Yd   | 20    |
| Deck Slab Repair (Full Depth, Type 2)                      | Sq Yd   | 20    |
| Deck Slab Repair (Partial)                                 | Sq Yd   | 130   |
| Protective Shield  | Sq. Yd. | 480   |
| Silicone Joint Sealer 1"                                   | Foot    | 72    |
| Concrete Removal   | Cu Yd   | 40    |
| Concrete Superstructure                                    | Cu Yd   | 44.4  |
| Reinforcement Bars, Epoxy Coated                           | Pound   | 7660  |
| Remove and Re-erect Existing Bridge Rail                   | Foot    | 768   |
| Bar Splicers   | Each    | 60    |
| Polymer Concrete   | Cu Ft   | 15.2  |
| Bridge Joint System Expansion 1"                           | Foot    | 134   |
| Sheet Waterproofing Membrane System                        | Sq Yd   | 1304  |
| Formed Concrete Repair (Depth Equal to or Less Than 5")    | Sq Ft   | 15    |
| Epoxy Crack Sealing  | Foot    | 15    |

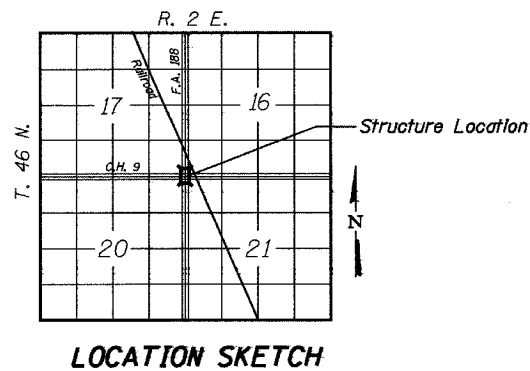

|          |        |
|----------|--------|
| DESIGNED | SB, DP |
| CHECKED  | SB     |
| DRAWN    | BH, BS |
| CHECKED  | SB     |



Scott A. Brown 3/10/2005  
LICENSE EXPIRES 11/30/2006

**GENERAL PLAN AND ELEVATION  
F.A.P. Route 303 & F.A.P. Route 738  
(IL 251) OVER Rockton Road  
SECTION (5VB, 5HB, 1-2HB)M  
WINNEBAGO COUNTY  
SN 101-0031 & 101-0032**