

F.A.P. RTE.	SECTION	COUNTY	TOTAL SHEETS	SHEET NO.
317	•	LIVINGSTON	205	68
STA. 232+50.00		TO STA. 233+00.00		
CONTRACT NO. 66261				
• 25 RS-2 & 26 RS-4				

FINAL SURVEY	SURVEYED	DATE
NOTY BOOK	PLOTTED	BY
NO.	AREAS CHECKED	

ORIGINAL SURVEY	SURVEYED	DATE
NOTE BOOK	PLOTTED	BY
NO.	AREAS CHECKED	

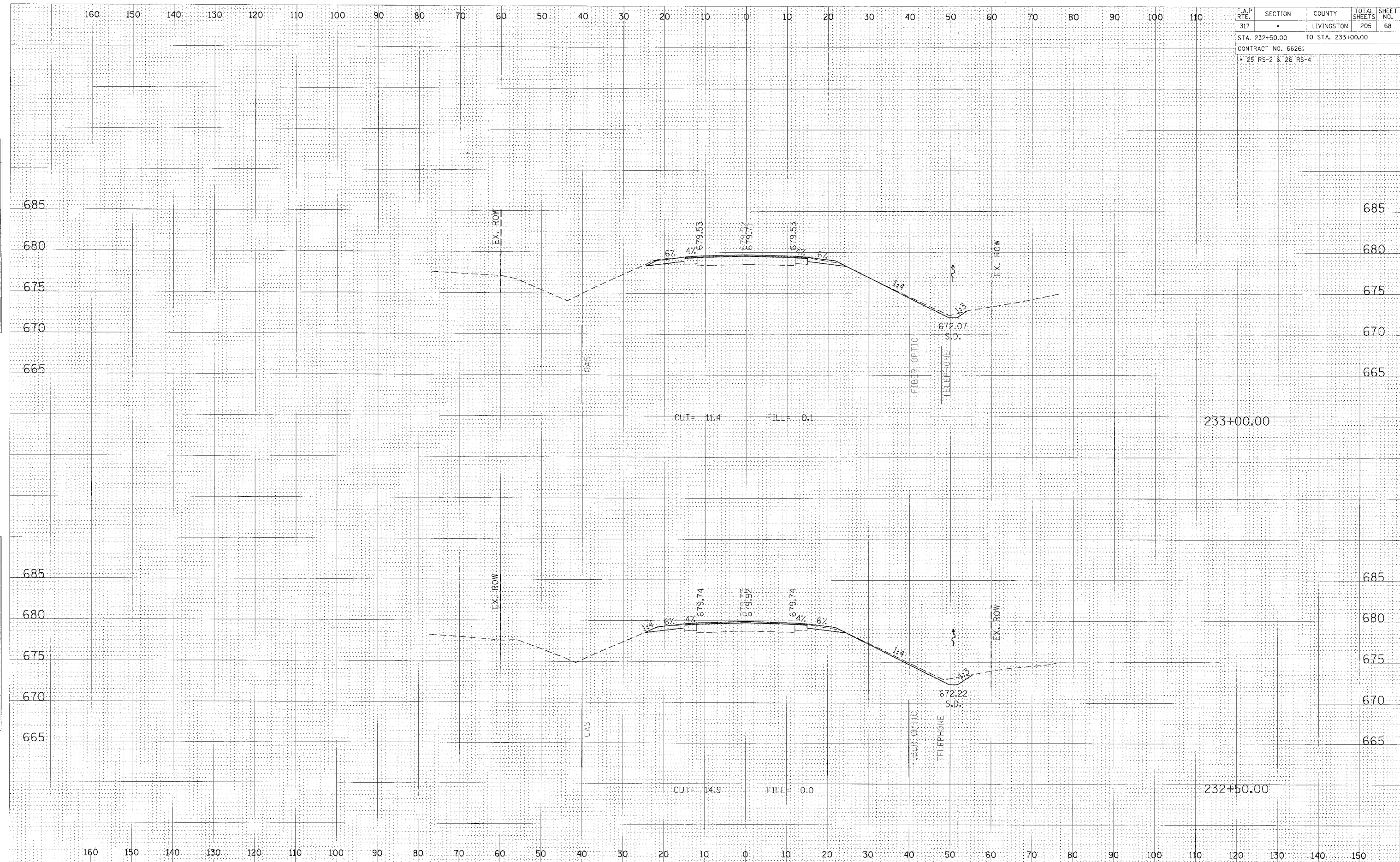

CROSS SECTION, STA 232+50.00 TO 233+00.00, FAP 317 (US ROUTE 24)