

F.A.P. RTE.	SECTION	COUNTY	TOTAL SHEETS	SHEET NO.
317	•	LIVINGSTON	205	80
STA. 244+50.00 TO STA. 245+00.00				
CONTRACT NO. 66261				
• 25 RS-2 & 26 RS-4				

FINAL SURVEY	DATE
BY _____	_____
NO. _____	_____

ORIGINAL SURVEY	DATE
BY _____	_____
NO. _____	_____

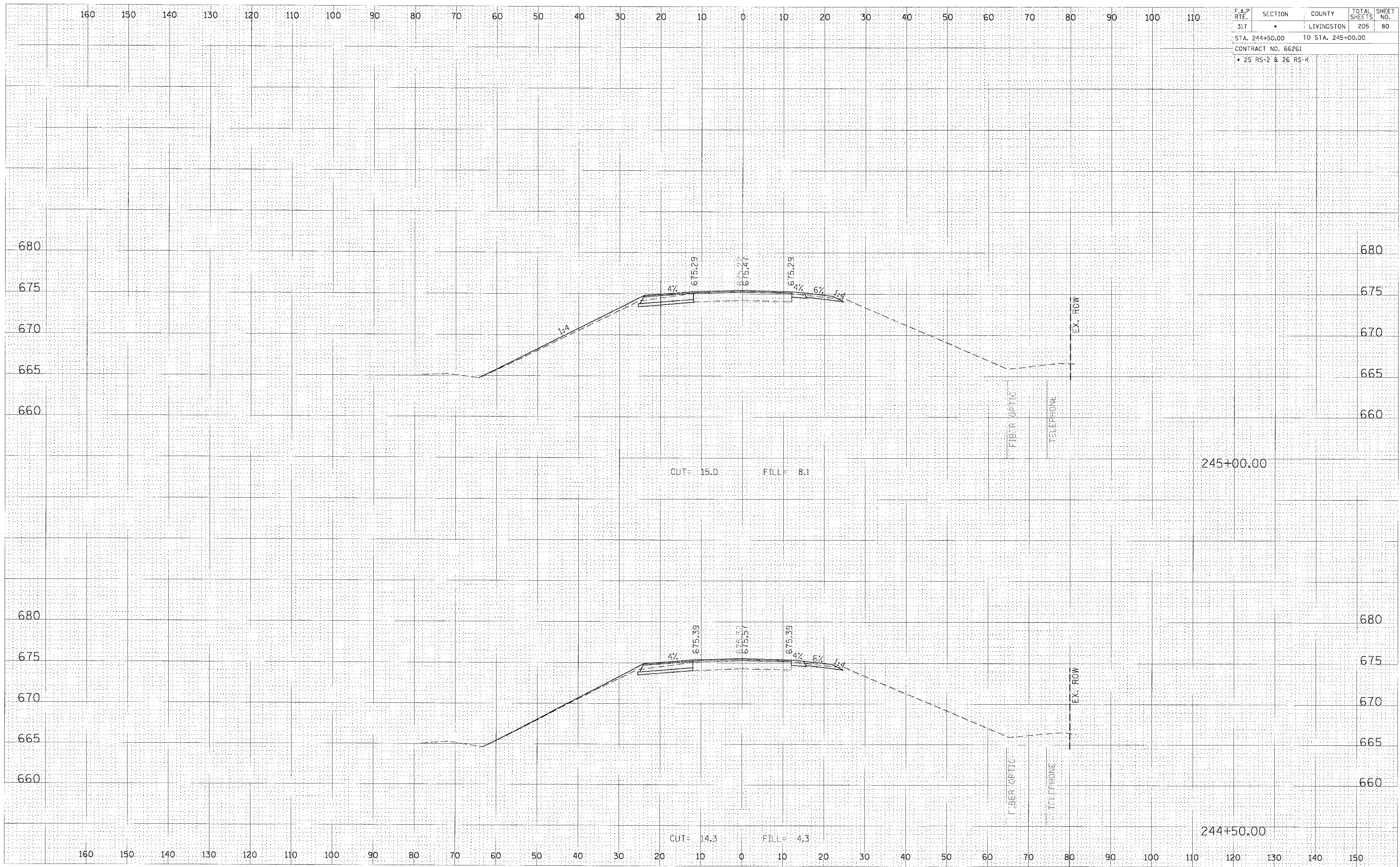

CROSS SECTION, STA 244+50.00 TO 245+00.00, FAP 317 (US ROUTE 24)