

F.A.P. RTE.	SECTION	COUNTY	TOTAL SHEETS	SHEET NO.
317	-	LIVINGSTON	205	104
STA. 267+75.06 TO STA. 268+15.00				
CONTRACT NO. 66261				
• 25 RS-2 & 26 RS-4				

FINAL SURV. NO.	SURVEYED BY	DATE

ORIGINAL SURV. NO.	SURVEYED BY	DATE

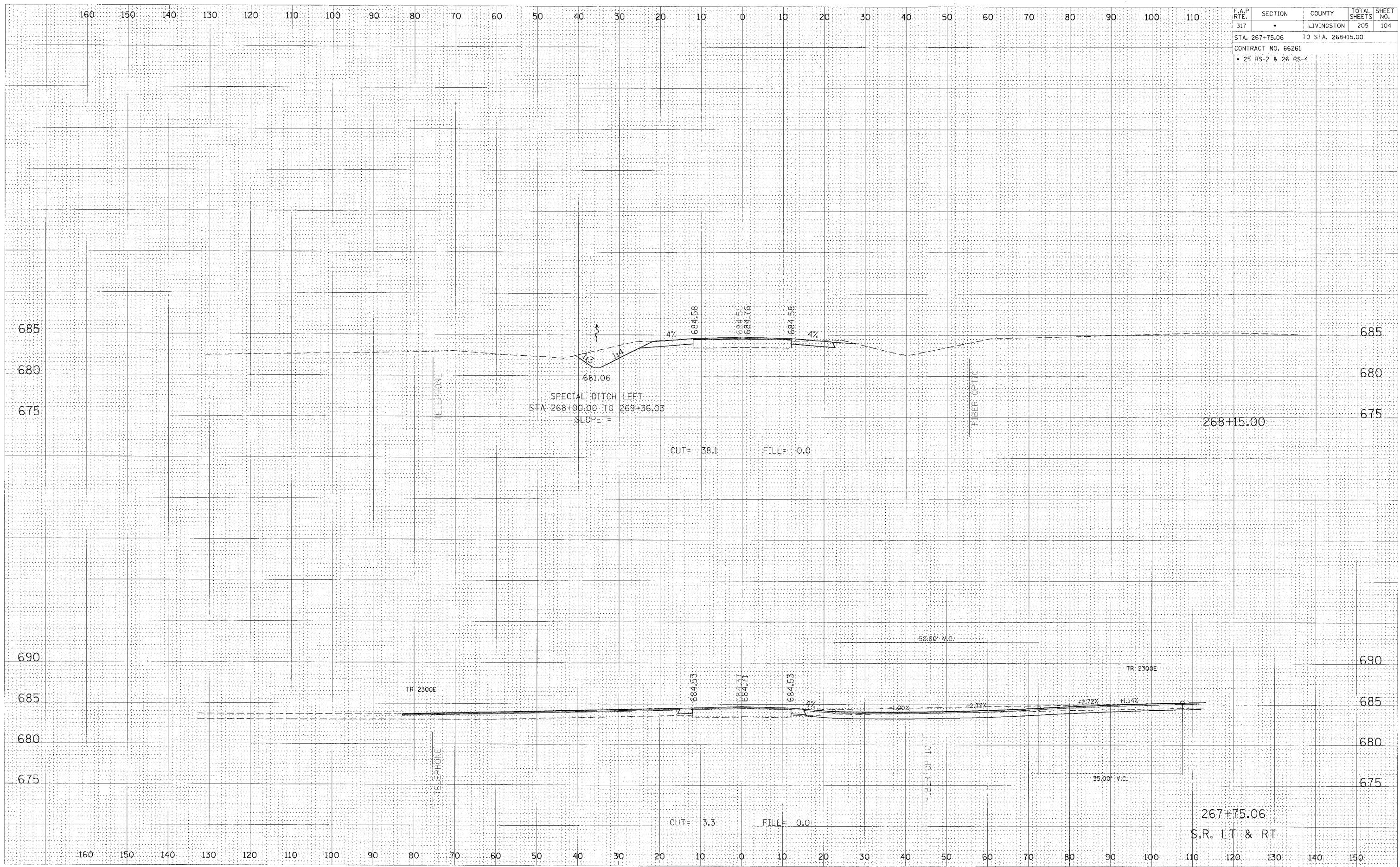

CROSS SECTION, STA 267+75.06 TO 268+15.00, FAP 317 (US ROUTE 24)