

F.A.P. RTE.	SECTION	COUNTY	TOTAL SHEETS	SHEET NO.
317		LIVINGSTON	205	161
STA. 317+50.00 TO STA. 317+97.31				
CONTRACT NO. 66261				
• 25 RS-2 & 26 RS-4				

FINAL SURVEY	DATE
SURVEYED	BY
PLOTTED	
DATE	
NO. OF COPIES	
AREAS CHECKED	

ORIGINAL SURVEY	DATE
SURVEYED	BY
PLOTTED	
DATE	
NO. OF COPIES	
AREAS CHECKED	

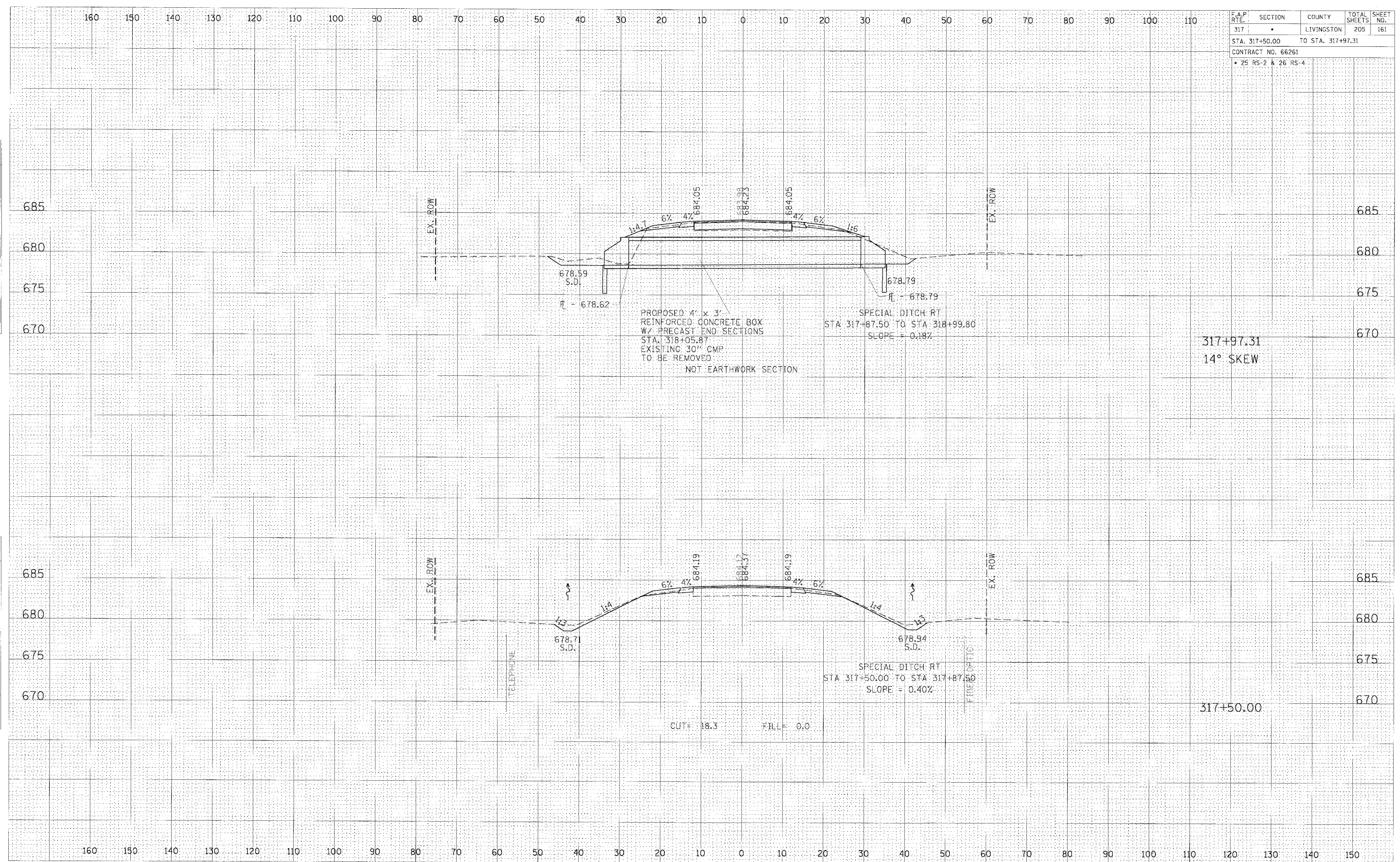

317+97.31
14° SKEW

317+50.00

CROSS SECTION, STA 317+50.00 TO 317+97.31, FAP 317 (US ROUTE 24)