

F.A.P. RTE.	SECTION	COUNTY	TOTAL SHEETS	SHEET NO.
317		LIVINGSTON	205	162
STA. 318+50.00		TO STA.		
CONTRACT NO. 66261				
• 25 RS-2 & 26 RS-4				

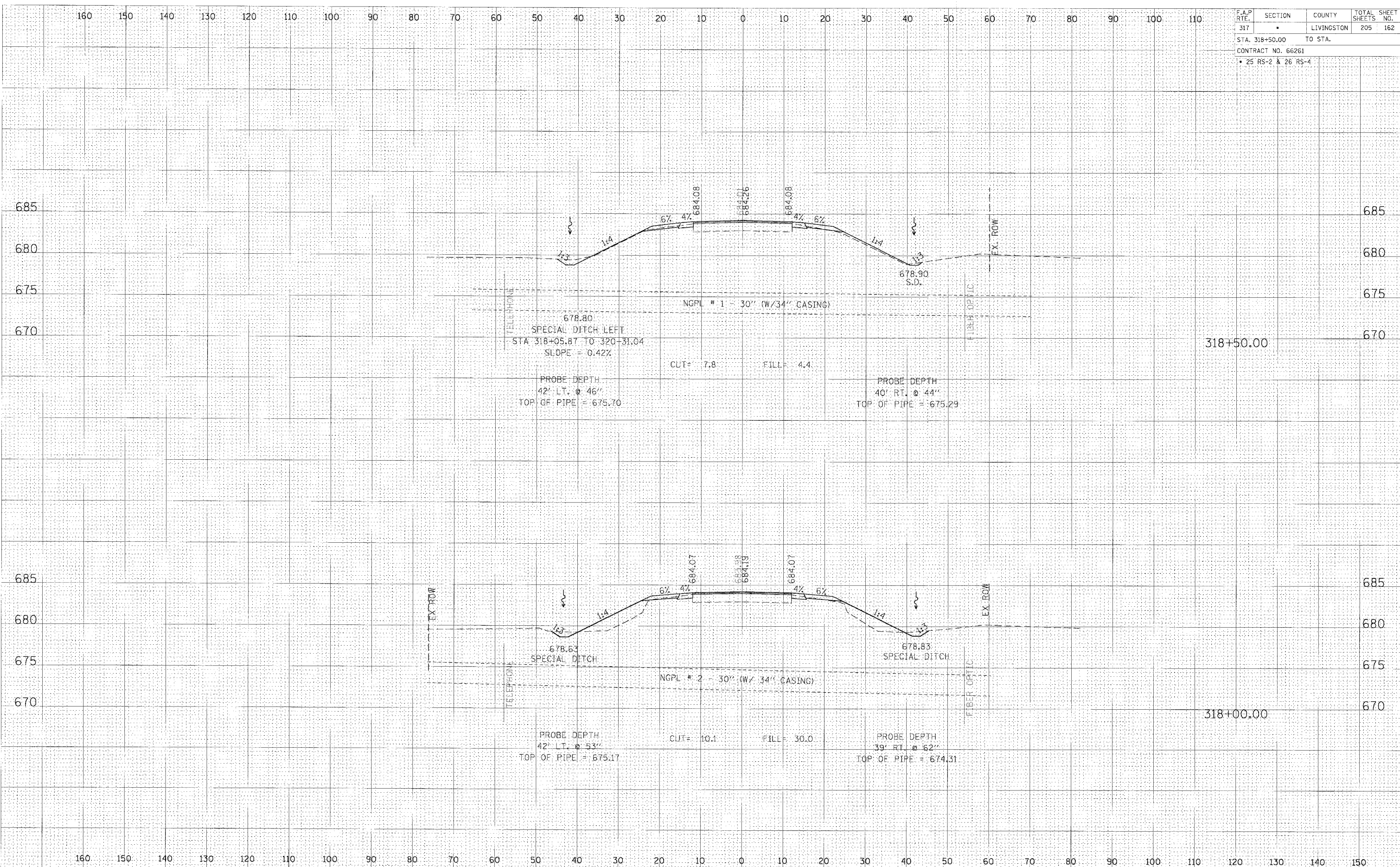

BY: _____ DATE: _____
 SURVEYED: _____ PLOTTED: _____
 NOTE BOOK: _____ TEMPLATE: _____
 AREAS CHECKED: _____

BY: _____ DATE: _____
 SURVEYED: _____ PLOTTED: _____
 NOTE BOOK: _____ TEMPLATE: _____
 AREAS CHECKED: _____

CROSS SECTION, STA 318+50.00, FAP 317 (US ROUTE 24)