

F.A.P. RTE.	SECTION	COUNTY	TOTAL SHEETS	SHEET NO.
317	*	LIVINGSTON	205	163
STA. 319+00.00 TO STA. 319+50.00				
CONTRACT NO. 66261				
• 25 RS-2 & 26 RS-4				

E.W.M. SURVEYED BY
 SURVEY PLOTTED BY
 NOTE BOOK NO. DATE
 AREAS CHECKED

ORIGINAL SURVEYED BY
 SURVEY PLOTTED BY
 NOTE BOOK NO. DATE
 AREAS CHECKED

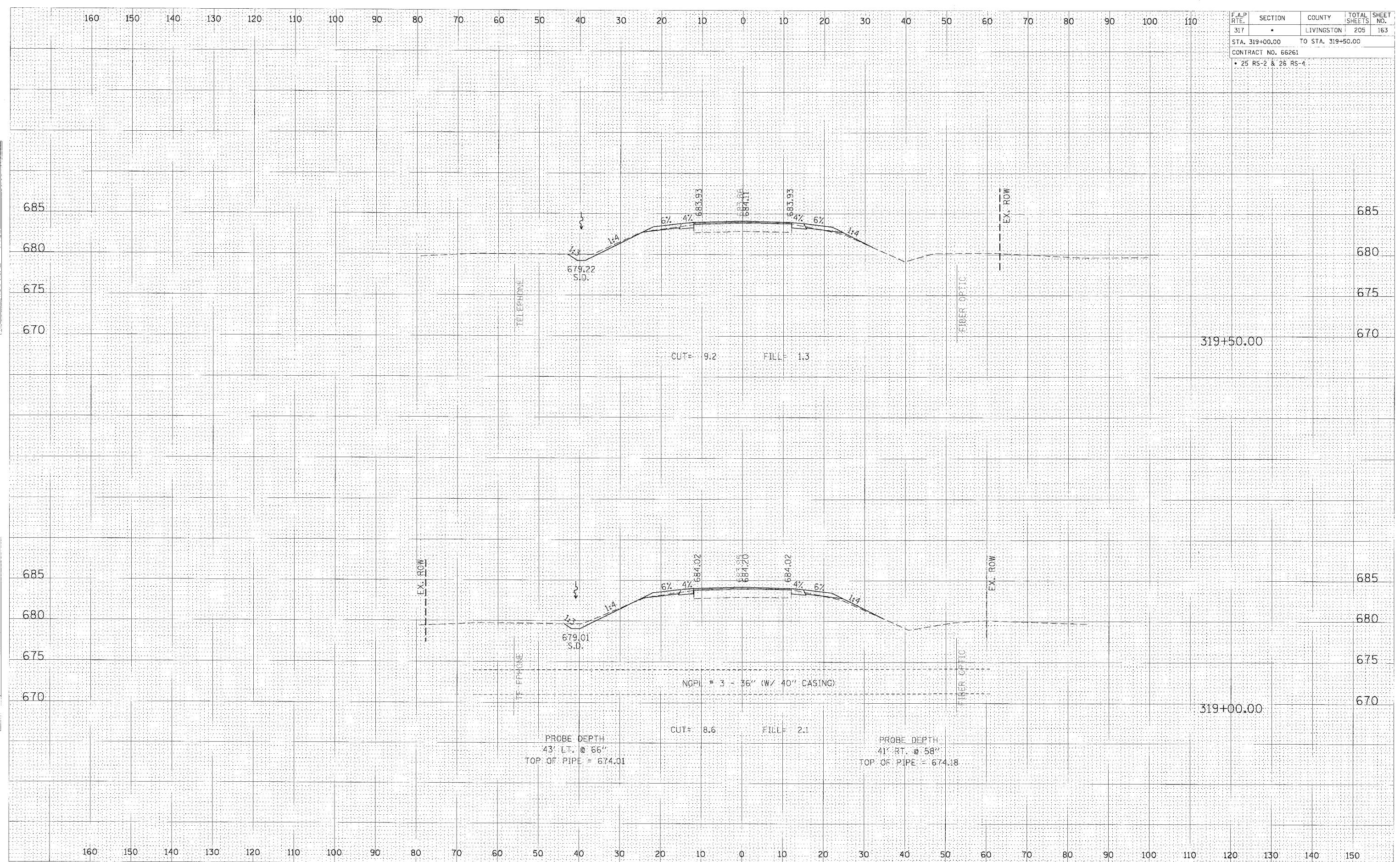

CROSS SECTION, STA 319+00.00 TO 319+50.00, FAP 317 (US ROUTE 24)