

F.A.I. RTE.	SECTION	COUNTY	TOTAL SHEETS	SHEET NO.
74	(72-71R-3)	PEORIA	1360	767
STA. 146+070		TO STA. 146+410		
FED. ROAD DIST. NO.	ILLINOIS	FED. AID PROJECT		

NOTES:

1. SEE PERMANENT SIGNING PLANS FOR ADDITIONAL INFORMATION.
2. SEE APPLICABLE MAINTENANCE OF TRAFFIC STANDARDS FOR ADDITIONAL SIGNING REQUIREMENTS.
3. ALL PERMANENT SIGNING FOR WB I-74 SHALL BE INSTALLED PRIOR TO SHIFTING TRAFFIC AT THE CONCLUSION OF STAGE 3-4.

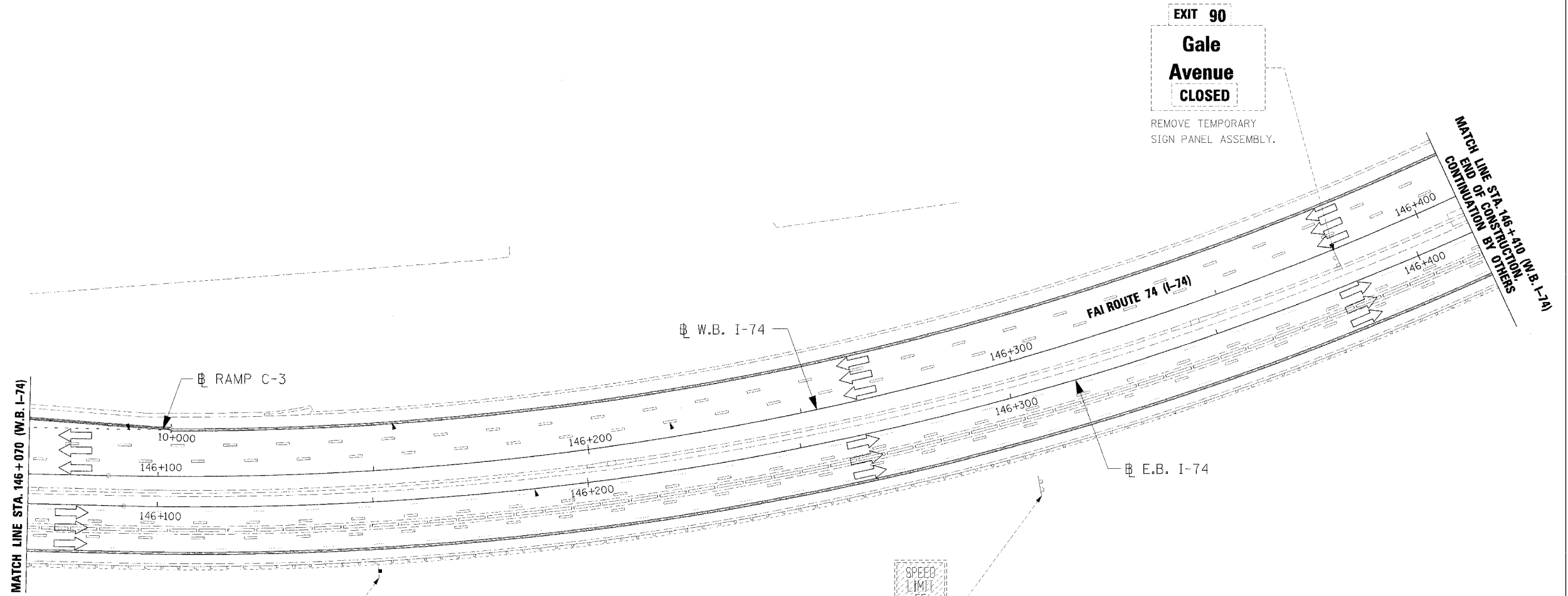

**EXIT 90**  
**Gale**  
**Avenue**  
**CLOSED**  
 REMOVE TEMPORARY SIGN PANEL ASSEMBLY.

SPEED LIMIT  
 55  
 MINIMUM  
 45  
 REMOVE SIGN PANEL OVERLAY, SPECIAL.

**WORK ZONE**  
 SPEED LIMIT  
 55  
 200 FT. MINIMUM  
 REMOVE AT END OF STAGE.

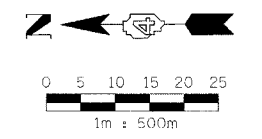

REVISIONS		ILLINOIS DEPARTMENT OF TRANSPORTATION
NAME	DATE	
		TEMPORARY INFORMATION SIGNING STAGE 3-4 WB STA. 146+070 - STA. 146+410
DATE 11/23/04		DRAWN BY RDY CHECKED BY LSA

