

| | | | | |
|---------------------|---------------------------|--------|--------------|-----------|
| F.A.I. RTE. | SECTION | COUNTY | TOTAL SHEETS | SHEET NO. |
| 74 | (72-70R-3) | PEORIA | 1360 | 772 |
| STA. 145+390 | TO STA. 145+730 | | | |
| FED. ROAD DIST. NO. | ILLINOIS FED. AID PROJECT | | | |

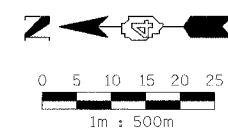

- NOTES:
1. ALL STATIONS INDICATED ON PLANS ARE WESTBOUND EXCEPT WHERE NOTED OTHERWISE.
 2. SEE MAINTENANCE OF TRAFFIC SHEETS FOR REMOVAL, RELOCATION AND INSTALLATION OF TEMPORARY CONCRETE BARRIERS.

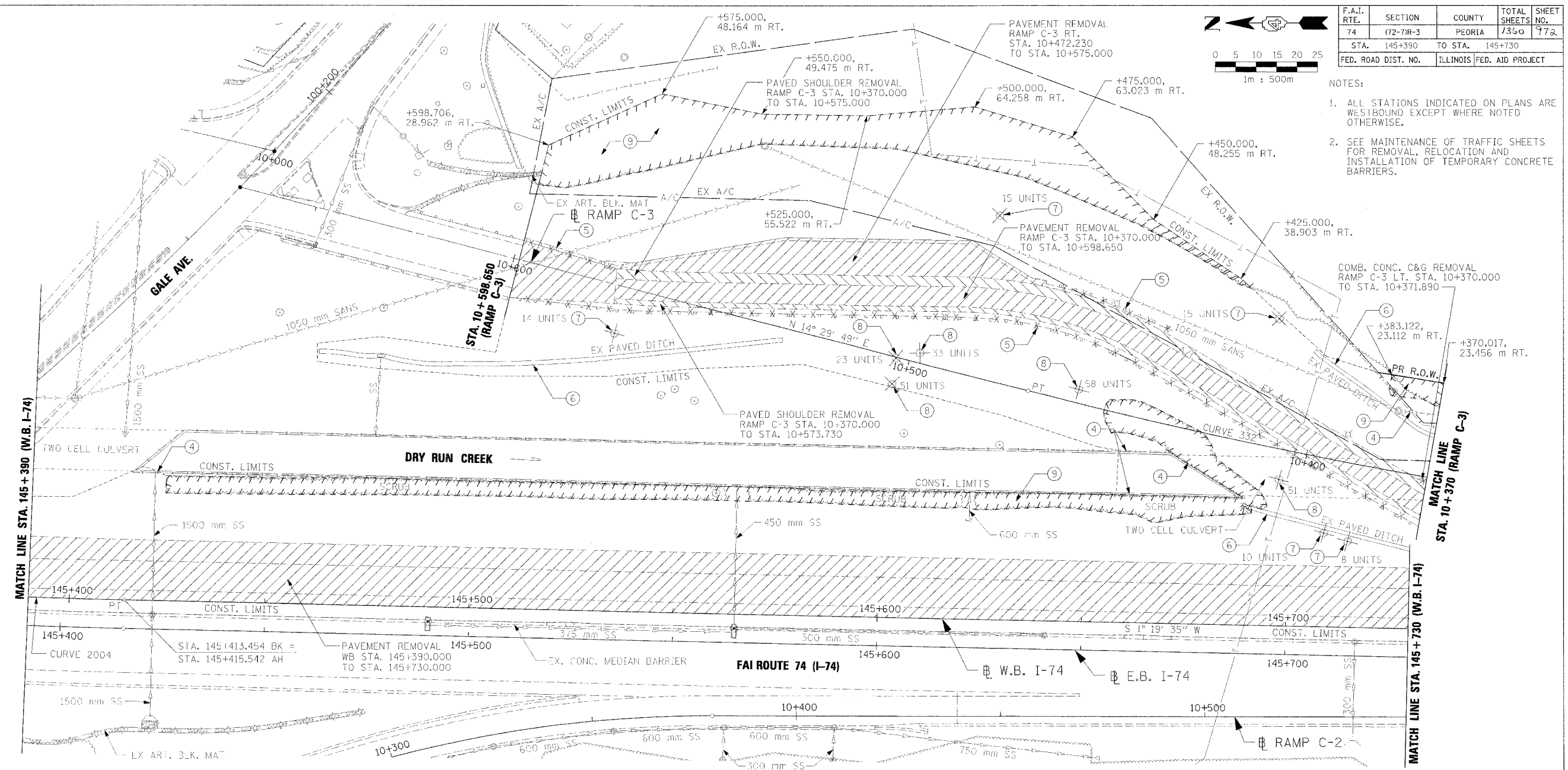

REMOVAL LEGEND AND KEY

| | | | | | | | | | |
|--|------------------------------------|---|---|-------|--------------------------------|---|--------------------------------|---|---------------------------------------|
| | PAVEMENT REMOVAL | ① | LIGHTING FIXTURE & FOUNDATION REMOVAL | [A] | FRAME AND GRATE TO BE ADJUSTED | ④ | FENCE REMOVAL | ⑧ | TREE REMOVAL - OVER 15 UNITS DIAMETER |
| | SHOULDER REMOVAL | ② | COMBINATION CONCRETE CURB AND GUTTER REMOVAL | [A] | FRAME AND LID TO BE ADJUSTED | ⑤ | GUARDRAIL REMOVAL | ⑨ | TREE REMOVAL (HECTARES) |
| | DRIVEWAY PAVEMENT REMOVAL | ③ | BITUMINOUS SURFACE REMOVAL 300mm WIDTH x 40mm DEPTH | [ADJ] | STRUCTURE TO BE ADJUSTED | ⑥ | PAVED DITCH REMOVAL | | |
| | SIDEWALK REMOVAL | ④ | FENCE REMOVAL | [AB] | ITEM TO BE ABANDONED | ⑦ | TREE REMOVAL (6-15 UNITS DIA.) | | |
| | CURB & GUTTER REMOVAL | ⑤ | GUARDRAIL REMOVAL | [M] | ITEM TO BE MOVED | | | | |
| | GUARDRAIL REMOVAL | ⑥ | PAVED DITCH REMOVAL | [C] | STRUCTURE TO BE CLEANED | | | | |
| | BITUMINOUS SURFACE REMOVAL | ⑦ | TREE REMOVAL (6-15 UNITS DIA.) | [F] | STRUCTURE TO BE FILLED | | | | |
| | BITUMINOUS TAPER (FOR BUTT JOINTS) | ⑧ | TREE REMOVAL (OVER 15 UNITS DIA.) | [R] | STRUCTURE TO BE REMOVED | | | | |
| | | ⑨ | TREE REMOVAL (HECTARES) | [REC] | STRUCTURE TO BE RECONSTRUCTED | | | | |
| | | | | [SSR] | STORM SEWER REMOVAL | | | | |
| | | | | [SP] | SPECIAL ADJUSTMENT | | | | |

- ④ FENCE REMOVAL
WB LT. STA. 145+416.847 TO STA. 145+422.500
WB LT. STA. 145+659.925 TO STA. 145+671.005
WB LT. STA. 145+659.925 TO STA. 145+689.525
WB LT. STA. 145+671.005 TO STA. 145+689.525
RAMP C-3 STA. 10+370.000 TO STA. 10+387.285
- ⑤ GUARDRAIL REMOVAL
RAMP C-3 STA. 10+370.000 TO STA. 10+598.650
RAMP C-3 RT. STA. 10+438.840 TO STA. 10+472.265
RAMP C-3 LT. STA. 10+575.000 TO STA. 10+598.650
- ⑥ PAVED DITCH REMOVAL
WB LT. STA. 145+688.703 TO STA. 145+730.000
RAMP C-3 RT. STA. 10+370.000 TO STA. 10+403.035
RAMP C-3 LT. STA. 10+531.355 TO STA. 10+640.515
- ⑦ TREE REMOVAL (6-15 UNITS DIA.)
WB STA. 145+714.702, 21.292 m LT.
WB STA. 145+708.855, 23.230 m LT.
RAMP C-3 STA. 10+413.490, 31.300 m RT.
RAMP C-3 STA. 10+487.410, 39.970 m RT.
RAMP C-3 STA. 10+571.585, 11.625 m LT.
- ⑧ TREE REMOVAL - OVER 15 UNITS DIAMETER
RAMP C-3 STA. 10+405.445, 7.335 m LT.
RAMP C-3 STA. 10+457.985, 3.325 m RT.
RAMP C-3 STA. 10+497.975, 2.455 m RT.
RAMP C-3 STA. 10+502.665, 6.635 m LT.
RAMP C-3 STA. 10+503.315, 0.210 m LT.
- ⑨ TREE REMOVAL (HECTARES)
WB LT. STA. 145+425.200 TO STA. 145+694.854
RAMP C-3 RT. STA. 10+370.000 TO STA. 10+383.125
RAMP C-3 RT. STA. 10+421.800 TO STA. 10+598.650

| REVISIONS | | ILLINOIS DEPARTMENT OF TRANSPORTATION |
|-----------|------|--|
| NAME | DATE | |
| | | EXISTING ROADWAY PLAN FAI ROUTE 74 (I-74) WB STA. 145+390 - STA. 145+730 |
| | | |
| | | |
| | | |
| | | |



DATE 11/23/04
DRAWN BY CAM
CHECKED BY LSA