

All Dimensions are in millimeters (mm) unless noted otherwise.

STATE OF ILLINOIS  
DEPARTMENT OF TRANSPORTATION

ROUTE NO.	SECTION	COUNTY	TOTAL SHEETS	SHEET NO.
F.A.I. 74	*	PEORIA	1360	1032
FED. ROAD DIST. NO. 7	ILLINOIS	FED. AID PROJECT		

SHEET NO. 10  
of 15 SHEETS

\* (72-TIR-3) Contract 68200

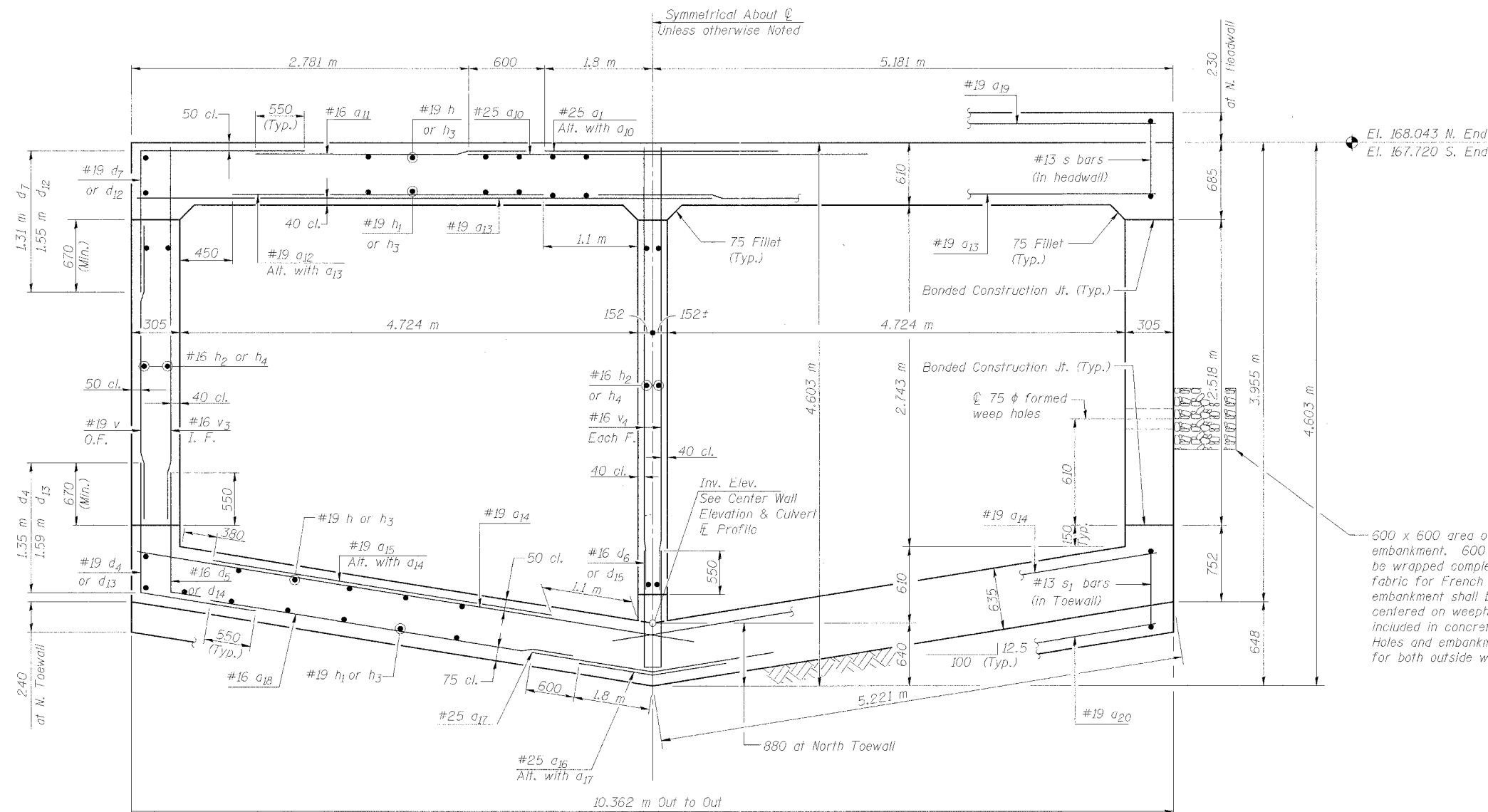

El. 168.043 N. End  
El. 167.720 S. End

600 x 600 area of porous granular embankment. 600 x 600 area shall be wrapped completely in geotechnical fabric for French drains. Length of embankment shall be ±31.5 m and centered on weepholes. Cast is included in concrete box culverts. Holes and embankment are typical for both outside walls.

**SECTION A-A THRU NORTH CULVERT EXTENSION**  
(Looking North)

**SECTION A-A THRU  
NORTH CULVERT EXTENSION  
RAMP C-3 OVER DRY RUN CREEK  
F.A.I. ROUTE 74(I-74) SECTION (72-7)R-3  
PEORIA COUNTY  
STATION 10+277.51 TO  
STA. 10+441.66 (RAMP C-3)  
STRUCTURE NUMBER 072-2005**

DESIGNED	LLV
CHECKED	PJL
DRAWN	MGM
CHECKED	LLV

**CE**  
**CLARK ENGINEERS, INC.**

111 NE Jefferson Ave.  
Peoria, Illinois 61602  
Ph(309)676-8464  
FAX(309)676-5445

... 10/10/07-2005-001 10/27/05 07:15:30 AM