

F.A.P. RTE.	SECTION	COUNTY	TOTAL SHEETS	SHEET NO.
71	13RIRS-5	SANGAMON	25	15
STA.		TO STA.		
FED. ROAD DIST. NO.		ILLINOIS FED. AID PROJECT		
CONTRACT NO. 72614				

RADIUS STAKING CONTROL POINTS

- ① - 224+46.34, 11.00' RT.
- ② - 224+76.40, 41.06' RT.
- ③ - 224+72.09, 72.13' RT.
- ④ - 225+02.37, 63.74' RT.
- ⑤ - 225+41.37, 26.86' RT.
- ⑥ - 226+20.57, 11.00' RT.

PLAN	DATE
SURVEYED	
DESIGNED	
CHECKED	
BY	
DATE	

PROFILE	DATE
SURVEYED	
DESIGNED	
CHECKED	
BY	
DATE	

projects\ed52981\del_f.mal.12-20-04\allendr.dgn
2/10/2005
REF B1

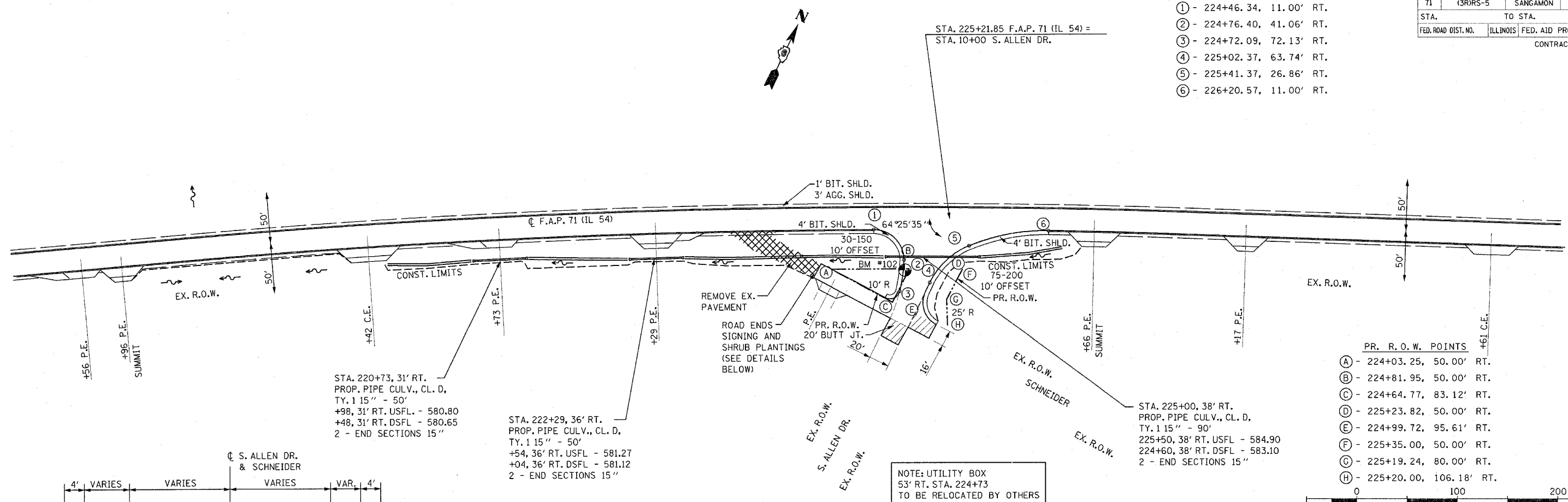

PR. R. O. W. POINTS

A	- 224+03.25, 50.00' RT.
B	- 224+81.95, 50.00' RT.
C	- 224+64.77, 83.12' RT.
D	- 225+23.82, 50.00' RT.
E	- 224+99.72, 95.61' RT.
F	- 225+35.00, 50.00' RT.
G	- 225+19.24, 80.00' RT.
H	- 225+20.00, 106.18' RT.

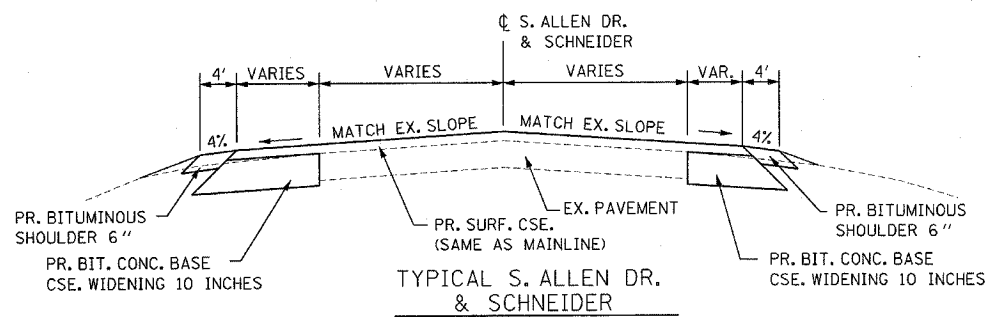
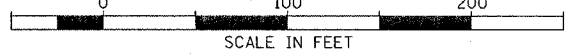

BM #102 FOUND CHSLD SQUARE IN N.E. COR. OF TELEPHONE BOX FOUNDATION AT N.W. COR. OF ALLEN AND SCHNEIDER ST. - ELEV. 584.772

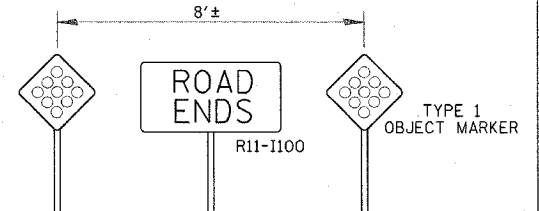

LOW VOLUME ROAD CLOSURE

