

F.A.P. RTE.	SECTION	COUNTY	TOTAL SHEETS	SHEET NO.
502		ADAMS	315	27
STA.		TO STA.		
FED. ROAD DIST. NO.		ILLINOIS	FED. AID PROJECT	
[53RS-7, PIRS-2]N, TS CONTRACT NO. 72897				

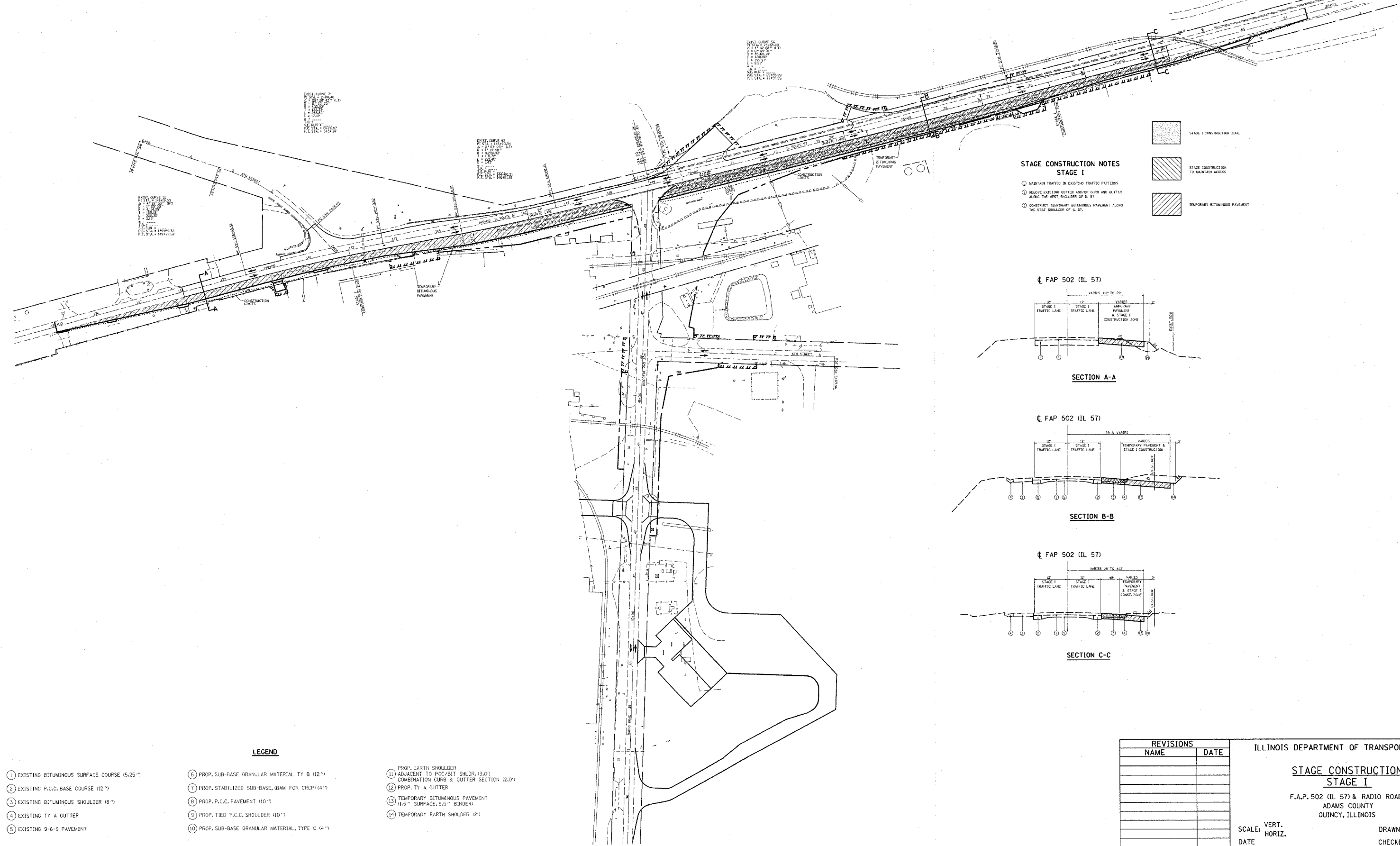

- STAGE CONSTRUCTION NOTES**
STAGE I
- MAINTAIN TRAFFIC IN EXISTING TRAFFIC PATTERNS
 - REMOVE EXISTING GUTTER AND/OR CURB AND GUTTER ALONG THE WEST SHOULDER OF E ST.
 - CONSTRUCT TEMPORARY BITUMINOUS PAVEMENT ALONG THE WEST SHOULDER OF E ST.

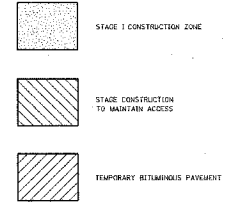

CL FAP 502 (IL 57)

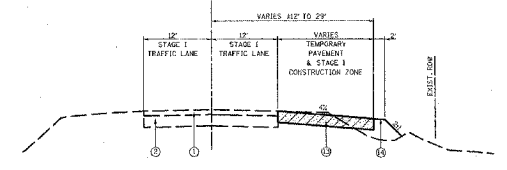

SECTION A-A

CL FAP 502 (IL 57)

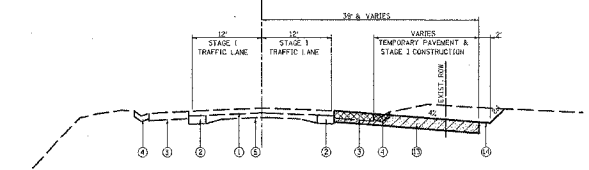

SECTION B-B

CL FAP 502 (IL 57)

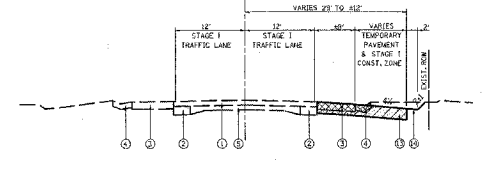

SECTION C-C

LEGEND

- | | | |
|--|--|--|
| 1 EXISTING BITUMINOUS SURFACE COURSE (5.25") | 6 PROP. SUB-BASE GRANULAR MATERIAL TY B (12") | 11 PROP. EARTH SHOULDER ADJACENT TO PCC/BIT SHLDR. (3.0') COMBINATION CURB & GUTTER SECTION (2.0') |
| 2 EXISTING P.C.C. BASE COURSE (12") | 7 PROP. STABILIZED SUB-BASE (BAM FOR CRCP) (4") | 12 PROP. TY A GUTTER |
| 3 EXISTING BITUMINOUS SHOULDER (8") | 8 PROP. P.C.C. PAVEMENT (10") | 13 TEMPORARY BITUMINOUS PAVEMENT (1.5" SURFACE, 9.5" BINDER) |
| 4 EXISTING TY A GUTTER | 9 PROP. TIED P.C.C. SHOULDER (10") | 14 TEMPORARY EARTH SHOULDER (2') |
| 5 EXISTING 9-6-9 PAVEMENT | 10 PROP. SUB-BASE GRANULAR MATERIAL, TYPE C (4") | |

REVISIONS	
NAME	DATE

ILLINOIS DEPARTMENT OF TRANSPORTATION

STAGE CONSTRUCTION
STAGE I

F.A.P. 502 (IL 57) & RADIO ROAD
ADAMS COUNTY
QUINCY, ILLINOIS

SCALE: VERT. _____
HORIZ. _____

DATE _____ DRAWN BY _____
CHECKED BY _____

c:\projects\d653004\woolpert_080204\radio rd stage 1.dgn
 2/2/2005
 REF:01