

F.A.P. RTE.	SECTION	COUNTY	TOTAL SHEETS	SHEET NO.
502	*	ADAMS	3/5	53
STA.		TO STA.		
FED. ROAD DIST. NO.		ILLINOIS FED. AID PROJECT		
* [53RS-7, P[RS-2]N, TS				
CONTRACT NO. 72897				

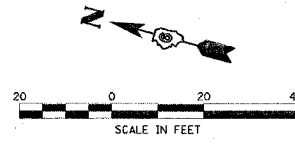

EXIST. CURVE 51
 PI STA. = 141+19.50
 $\Delta = 4^\circ 27' 33''$ (RT)
 $D = 1^\circ 23' 33''$
 $R = 4,114.29'$
 $T = 160.18'$
 $L = 320.20'$
 $E = 3.12'$
 $e = \text{---}$
 $T.R. = \text{---}$
 $S.E. RUN = \text{---}$
 $P.C. STA. = 139+59.32$
 $P.T. STA. = 142+79.52$

STA. 138+73.00 BEGIN
 SEC. [53RS-7, P[RS-2]N, TS
 IMPROVEMENTS

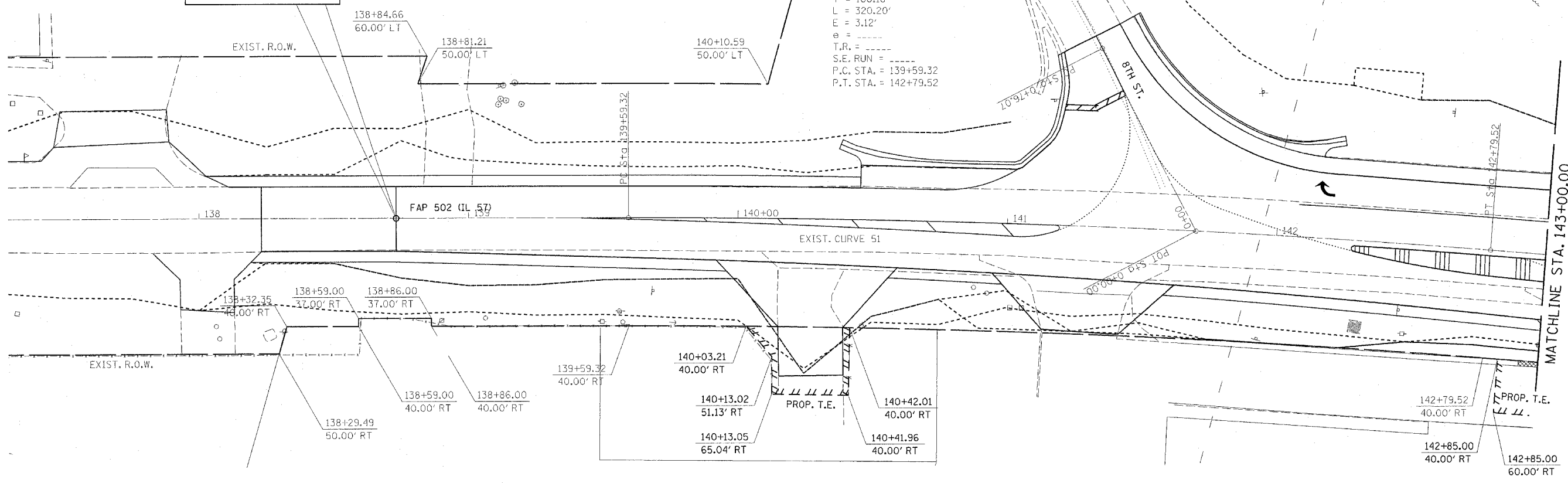

MATCHLINE STA. 143+00.00

MATCHLINE STA. 148+50.00

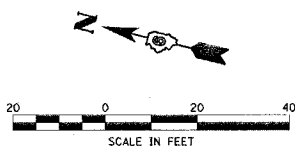

EXIST. CURVE 52
 PI STA. = 145+70.94
 $\Delta = 2^\circ 57' 03''$ (LT)
 $D = 1^\circ 19' 58''$
 $R = 4,298.93'$
 $T = 110.72'$
 $L = 221.40'$
 $E = 1.43'$
 $e = \text{---}$
 $T.R. = \text{---}$
 $S.E. RUN = \text{---}$
 $P.C. STA. = 144+60.21$
 $P.T. STA. = 146+81.61$

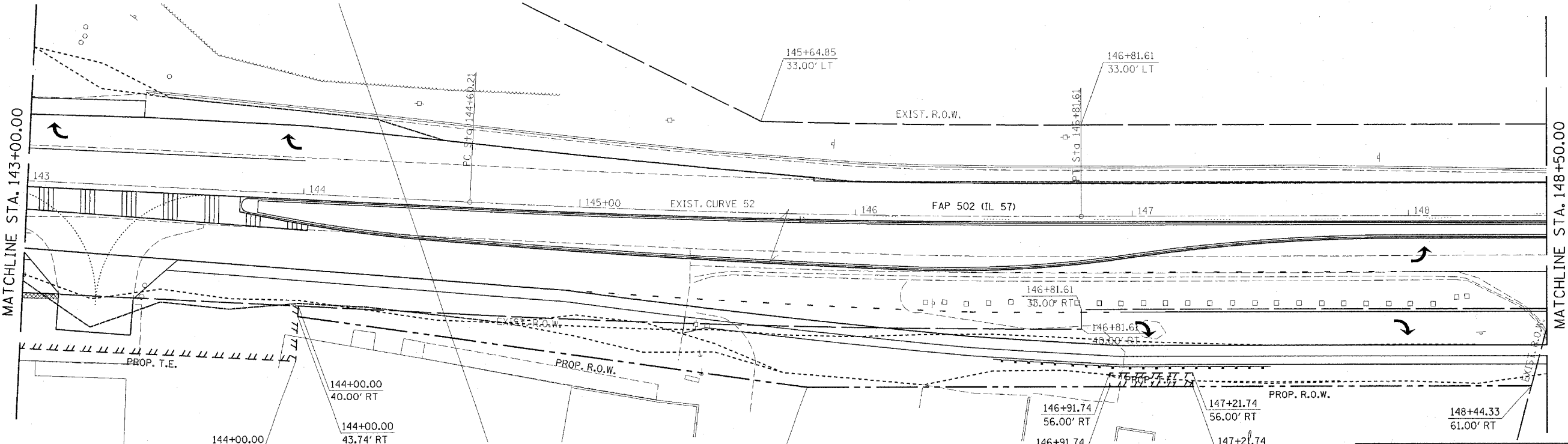

REVISIONS	
NAME	DATE

ILLINOIS DEPARTMENT OF TRANSPORTATION
RIGHT OF WAY DETAILS
 FAP 502 (IL 57) & RADIO ROAD
 SEC. [53RS-7, P[RS-2]N, TS
 ADAMS COUNTY
 QUINCY, IL.
 SCALE: VERT. _____
 HORIZ. _____
 DATE 08-02-04
 DRAWN BY TMJ
 CHECKED BY MEB

c:\projects\d653004\prowf\psheets.dgn
 2/3/2005
 *REF01