

| | | | | |
|--------------------------|----------|------------------|--------------|-----------|
| F.A.P. RTE. | SECTION | COUNTY | TOTAL SHEETS | SHEET NO. |
| 502 | * | ADAMS | 315 | 62 |
| STA. | | TO STA. | | |
| FED. ROAD DIST. NO. | ILLINOIS | FED. AID PROJECT | | |
| * (53RS-7, PIRS-2)JN, TS | | | | |
| CONTRACT NO. 72897 | | | | |

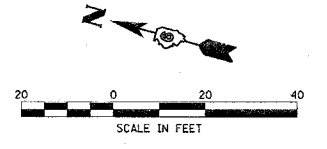

EXIST. CURVE 51
 PI STA. = 141+19.50
 $\Delta = 4^\circ 27' 33''$ (RT)
 $D = 1^\circ 23' 33''$
 $R = 4,114.29'$
 $T = 160.18'$
 $L = 320.20'$
 $E = 3.12'$
 $e =$
 $T.R. =$
 $S.E. RUN =$
 $P.C. STA. = 139+59.32$
 $P.T. STA. = 142+79.52$

STA. 138+73.00 BEGIN
 SEC. (53RS-7, PIRS-2)JN, TS
 IMPROVEMENTS

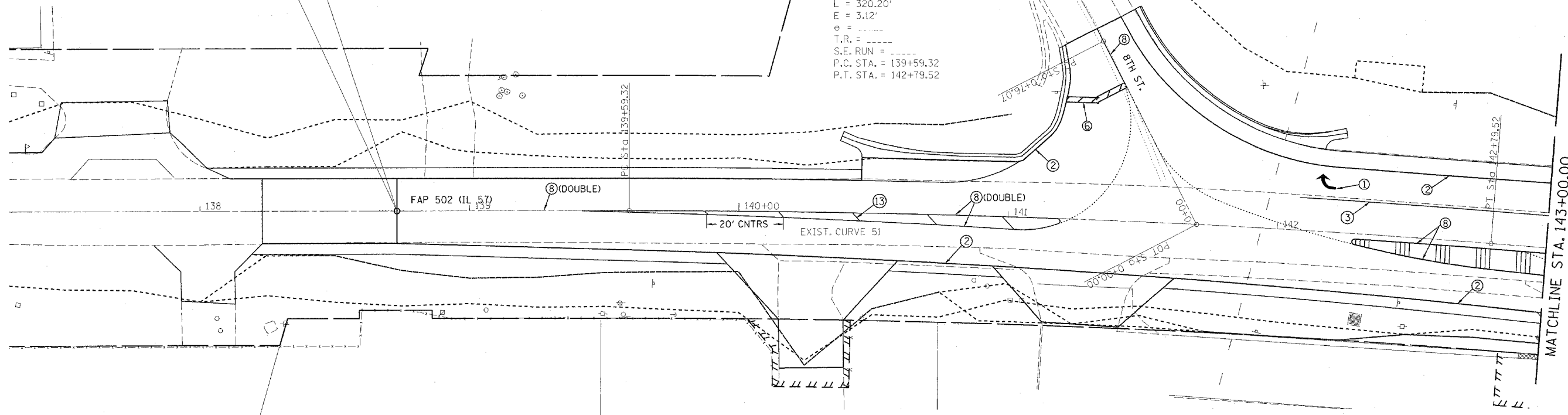

- | | |
|--|--|
| ① POLYUREA PAVEMENT MARKING SPECIAL - LETTERS AND SYMBOLS | ⑦ POLYUREA PAVEMENT MARKING SPECIAL - LINE 5" SKIP DASH YELLOW |
| ② POLYUREA PAVEMENT MARKING SPECIAL - LINE 5" SOLID WHITE | ⑧ POLYUREA PAVEMENT MARKING SPECIAL - LINE 5" SOLID YELLOW |
| ③ POLYUREA PAVEMENT MARKING SPECIAL - LINE 6" SOLID WHITE | ⑨ POLYUREA PAVEMENT MARKING SPECIAL - LINE 6" SOLID YELLOW |
| ④ POLYUREA PAVEMENT MARKING SPECIAL - LINE 8" SOLID WHITE | ⑩ POLYUREA PAVEMENT MARKING SPECIAL - LINE 8" SOLID YELLOW |
| ⑤ POLYUREA PAVEMENT MARKING SPECIAL - LINE 12" SOLID WHITE | ⑪ RAISED REFLECTIVE PAVEMENT MARKERS - 1 WAY - AMBER |
| ⑥ POLYUREA PAVEMENT MARKING SPECIAL - LINE 24" SOLID WHITE | ⑫ RAISED REFLECTIVE PAVEMENT MARKERS - 2 WAY - AMBER |
| | ⑬ POLYUREA PAVEMENT MARKING SPECIAL - LINE 12" YELLOW |

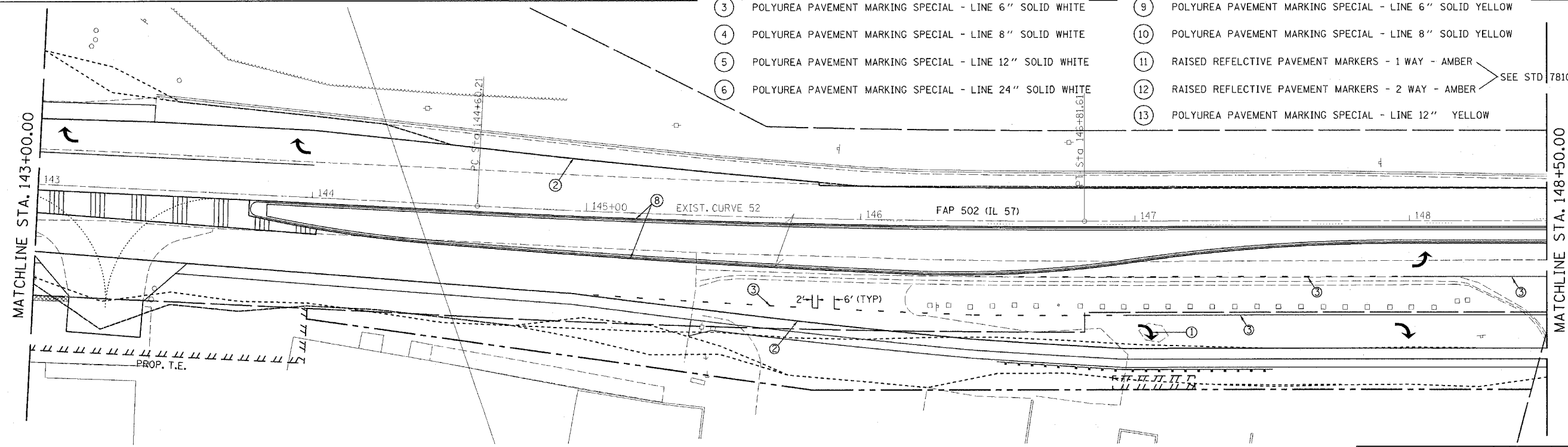
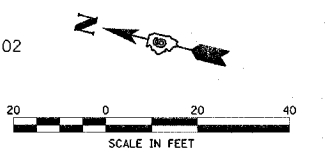

EXIST. CURVE 52
 PI STA. = 145+70.94
 $\Delta = 2^\circ 57' 03''$ (LT)
 $D = 1^\circ 19' 58''$
 $R = 4,298.93'$
 $T = 110.72'$
 $L = 221.40'$
 $E = 1.43'$
 $e =$
 $T.R. =$
 $S.E. RUN =$
 $P.C. STA. = 144+60.21$
 $P.T. STA. = 146+81.61$

| REVISIONS | |
|-----------|------|
| NAME | DATE |
| | |
| | |
| | |
| | |
| | |
| | |
| | |
| | |
| | |
| | |

ILLINOIS DEPARTMENT OF TRANSPORTATION
PAVEMENT MARKING DETAILS
 FAP 502 (IL 57) & RADIO ROAD
 SEC. (53RS-7, PIRS-2)JN, TS
 ADAMS COUNTY
 QUINCY, IL.
 SCALE: VERT. _____
 HORIZ. _____
 DATE 08-02-04
 DRAWN BY TMJ
 CHECKED BY MEB

c:\projects\653004\pavem\p.k.dgn
 2/3/2005
 *REF01