

F.A.P. RTE.	SECTION	COUNTY	TOTAL SHEETS	SHEET NO.
502	*	ADAMS	315	92
STA.		TO STA.		
FED. ROAD DIST. NO.		ILLINOIS FED. AID PROJECT		

• [53RS-7, PIRS-2] IN, TS
CONTRACT NO. 72897

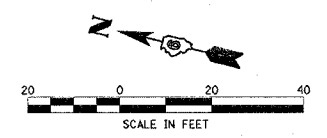

STA. EQUATION:
POT STA. 149+00.01 (BK)=
POT STA. 69+09.30 (AH)
FAP 502 (IL 57)

STA. EQUATION:
STA. 148+96.96 (IL 57)=
POT STA. 50+00.00
(EXIST. RADIO RD.)

STA. 70+37.50 (IL 57)=
STA. 50+50.19 (RADIO RD.)
STA. 10+00.00 (CAVE ENTRANCE)

ISLAND DETAIL STA./OFFSETS
FAP 502 (IL 57) STATIONING

- (I1) 69+56.19
34.00' RT
- (I2) 69+56.19
38.00' RT
- (I3) 69+60.67
40.00' RT
2.0' R.
- (I4) 69+68.73
51.35' RT
2.0' R.
- (I5) 69+68.63
55.53' RT
- (I6) 69+70.36
56.53' RT
- (I7) 69+74.67
39.00' RT
3.0' R.
- (I8) 69+83.30
34.00' RT

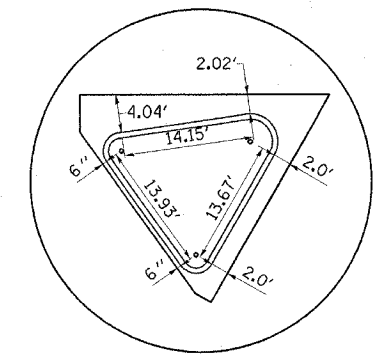
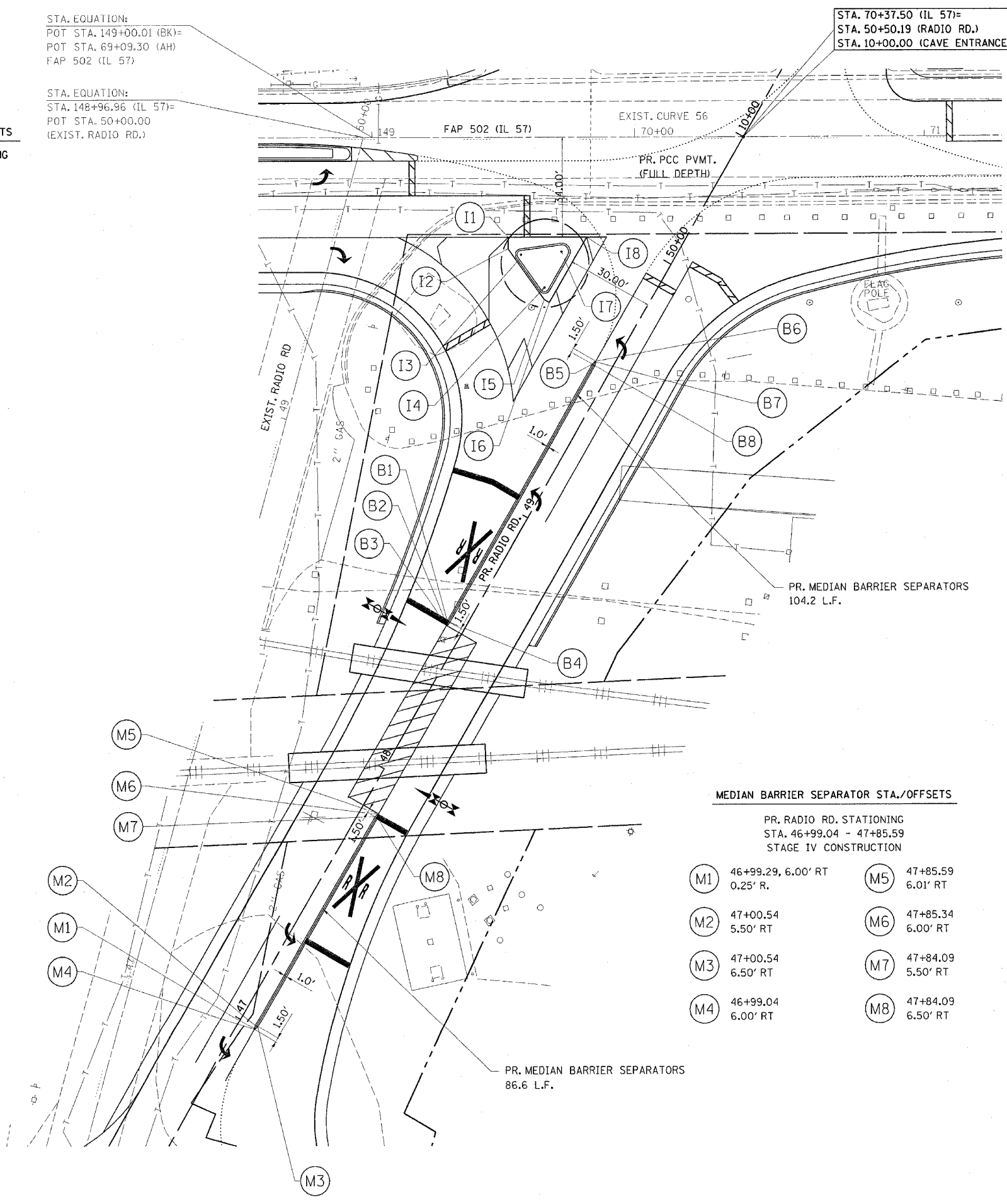

M-6.06 ISLAND DETAIL

ISLAND DETAIL (NOT TO SCALE)
STAGE IV CONSTRUCTION

MEDIAN BARRIER SEPARATOR STA./OFFSETS

PR. RADIO RD. STATIONING
STA. 48+53.82 - 49+58.00
STAGE IV CONSTRUCTION

- | | |
|---------------------------|---------------------------|
| (B1) 48+55.32
6.50' LT | (B5) 49+56.50
6.50' LT |
| (B2) 48+54.07
6.00' LT | (B6) 49+58.00
6.00' LT |
| (B3) 48+53.82
6.00' LT | (B7) 49+57.75
6.00' LT |
| (B4) 48+55.32
5.50' LT | (B8) 49+56.50
5.50' LT |

MEDIAN BARRIER SEPARATOR STA./OFFSETS

PR. RADIO RD. STATIONING
STA. 46+99.04 - 47+85.59
STAGE IV CONSTRUCTION

- | | |
|-------------------------------------|---------------------------|
| (M1) 46+99.29, 6.00' RT
0.25' R. | (M5) 47+85.59
6.01' RT |
| (M2) 47+00.54
5.50' RT | (M6) 47+85.34
6.00' RT |
| (M3) 47+00.54
6.50' RT | (M7) 47+84.09
5.50' RT |
| (M4) 46+99.04
6.00' RT | (M8) 47+84.09
6.50' RT |

PR. MEDIAN BARRIER SEPARATORS
86.6 L.F.

PR. MEDIAN BARRIER SEPARATORS
104.2 L.F.

REVISIONS	
NAME	DATE

ILLINOIS DEPARTMENT OF TRANSPORTATION
ISLAND DETAIL
MEDIAN BARRIER SEPARATORS

SCALE: VERT.
HORIZ.
DATE 01-26-05

DRAWN BY TMJ
CHECKED BY MEB

ct:\projects\0653004\ppsheets.dgn
2/2/2005
*REF01