

72938

F.A.P. RTE.	SECTION	COUNTY	TOTAL SHEETS	SHEET NO.
714	134B	CHRISTIAN	23	8
STA. 431+92 TO STA. 432+72				
FED. ROAD DIST. NO. ILLINOIS FED. AID PROJECT				

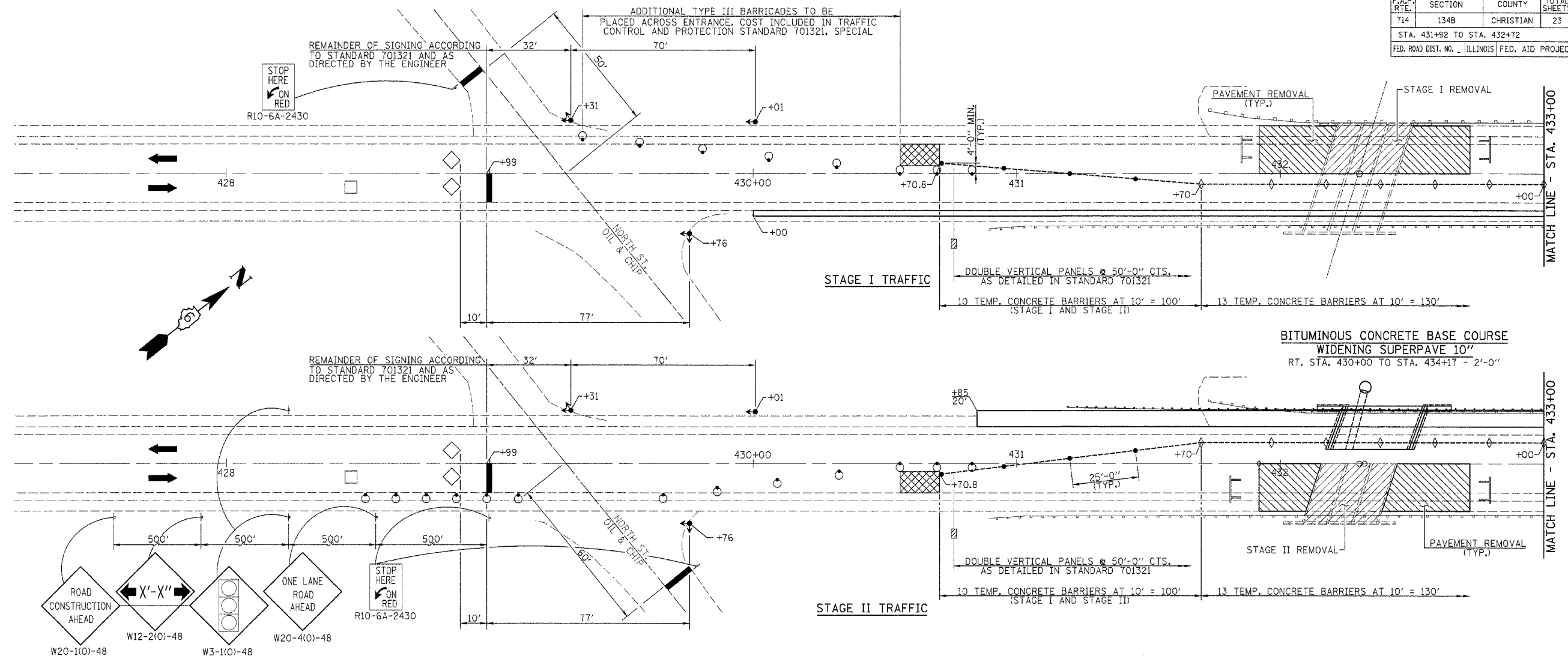

SUGGESTED STAGE CONSTRUCTION SEQUENCE

STAGE I

1. THE CONTRACTOR SHALL PLACE MAX. WIDTH SIGNS AS SHOWN ON SHEET 10, BEFORE IMPLEMENTING ANY STAGE TRAFFIC CONTROL. THESE SIGNS SHALL BE INCLUDED IN THE COST OF "TRAFFIC CONTROL AND PROTECTION STANDARD 701321 (SPECIAL)".
2. CONSTRUCT BITUMINOUS CONCRETE BASE COURSE WIDENING SUPERPAVE 10" RT. STA. 430+00 TO STA. 434+17 - (2'-0" WIDE).
3. ERECT TRAFFIC CONTROL FOR STAGE I.
4. REMOVE EXISTING STRUCTURE LEFT, @ STA. 432+30.
5. CONSTRUCT PROPOSED STAGE I THREE SIDED 28'-0" X 5'-10" CULVERT AND WINGWALLS @ STA. 432+32.
6. CONSTRUCT PROPOSED BITUMINOUS BASE COURSE SUPERPAVE 10" LT. STA. 430+85 TO STA. 433+84.3.
7. CONSTRUCT PROPOSED GUARDRAIL & TERMINALS LT. STA. 431+70.03 TO STA. 433+84.63.
8. CONSTRUCT P.C.C. BASE COURSE, BINDER COURSE AND TEMPORARY RAMPS.

STAGE II

1. ERECT TRAFFIC CONTROL FOR STAGE II.
2. REMOVE EXISTING STRUCTURE RIGHT @ STA. 432+30.
3. CONSTRUCT PROPOSED STAGE II PRECAST THREE SIDED 28'-0" X 5'-10" CULVERT AND WINGWALLS @ STA. 432+32.
4. CONSTRUCT PROPOSED BITUMINOUS BASE COURSE SUPERPAVE 10" RT. STA. 431+92 TO STA. 432+72.
5. CONSTRUCT PROPOSED AGGREGATE SHOULDERS RT. STA. 430+00 TO STA. 431+92 & STA. 432+72 TO STA. 434+17.
6. CONSTRUCT PROPOSED GUARDRAIL & TERMINALS RT. STA. 430+41.87 TO STA. 433+68.97.
7. CONSTRUCT P.C.C. BASE COURSE, BINDER COURSE AND TEMPORARY RAMPS.

FINAL

1. INSTALL SHORT-TERM PAVEMENT MARKINGS AND REMOVE ALL STAGE TRAFFIC CONTROL AND RE-ESTABLISH NORMAL TRAFFIC PATTERNS.
2. REMOVE SHORT TERM PAVEMENT MARKINGS AND COMPLETE BITUMINOUS CONCRETE SURFACE COURSE 1 1/2" UNDER TRAFFIC WITH FLAGGERS.
3. FINAL STRIPING, SEEDING AND MISCELLANEOUS CLEANUP.

GENERAL NOTES

1. THIS TRAFFIC CONTROL DETAIL SHALL BE USED IN CONJUNCTION WITH STANDARD 701321.
2. THE CONTRACTOR SHALL NOTIFY LARRY SIMON (PH. 785-5836) IN THE DISTRICT 6 TRAFFIC SECTION OF THE BUREAU OF OPERATIONS AT LEAST ONE WEEK PRIOR TO IMPLEMENTING STAGE TRAFFIC CONTROL.
3. EXISTING PAVEMENT MARKINGS THAT CONFLICT WITH THE REVISED STAGE TRAFFIC PATTERNS DURING ALL PHASES OF STAGE CONSTRUCTION SHALL BE REMOVED AS SPECIFIC IN SECTION 783 OF THE STANDARD SPECIFICATIONS AND PAID FOR AS "PAVEMENT MARKING REMOVAL".
4. THE CONTRACTOR SHALL MAINTAIN FULL OPERATIONAL STATUS OF ALL SIDEROADS AND ACCESS TO ALL PRIVATE AND COMMERCIAL PROPERTIES DURING ALL PHASES OF CONSTRUCTION.
5. TEMPORARY CONCRETE BARRIER, THE BARRIER UNIT AT EACH END OF THE INSTALLATION SHALL BE SECURED TO THE PAVEMENT OR SHOULDER USING ALL SIX ANCHORING PINS FOR F SHAPE OR ALL SIX DOWEL BARS FOR NEW JERSEY SHAPE.
6. EACH DETECTOR LOOP SHALL BE CONNECTED TO A SEPERATE DETECTOR AMPLIFIER.
7. THE COST TO INSTALL TEMPORARY PAVEMENT MARKING AS DETAILED ON THESE SHEETS SHALL BE INCLUDED IN THE COST OF "TRAFFIC CONTROL & PROTECTION STANDARD 701321, SPECIAL".
8. SIGNING FOR STAGE II SAME AS STAGE I.

SYMBOLS

- ▨ WORK AREA
- ⊥ SIGN
- ⌋ TYPE III BARRICADE
- ⊙ DRUM WITH STEADY BURNING LIGHT
- ⬅ TRAFFIC SIGNAL
- ▤ TEMPORARY RUMBLE STRIP
- ◻ ◊ INDUCTION LOOP DETECTOR
- ▨ DOUBLE VERTICAL PANEL
- ◊ TYPE C BIDIRECTIONAL REFLECTOR
- TEMPORARY CONCRETE BARRIER
- ▨ IMPACT ATTENUATOR
- STEADY BURNING LIGHTS AND DOUBLE VERTICAL PANELS

WORK THIS SHEET WITH SHEETS 7, 9 & 10 OF 23.
SEE SHEET NO. 9 FOR TRAFFIC CONTROL & TEMPORARY PAVEMENT MARKING SCHEDULES.

STAGE CONSTRUCTION TRAFFIC DETAILS
IL. ROUTE 48 OVER BUCKHART CREEK
F.A.P. ROUTE 714 - SECTION 134B
CHRISTIAN COUNTY
STA. 432+32
S.N. 011-2505

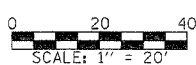

FILE NAME: 134B-SC1D2&3 (REV. 2/7/05)