

72938

F.A.P. RTE.	SECTION	COUNTY	TOTAL SHEETS	SHEET NO.
714	134B	CHRISTIAN	23	12
STA. 431+92 TO STA. 432+72				
FED. ROAD DIST. NO. ILLINOIS FED. AID PROJECT				

FINAL SURVEY BY DATE
 SURVEYED SURVEY
 TEMPLATE
 NOTE BOOK
 AREAS CHECKED
 NO.

ORIGINAL SURVEY BY DATE
 SURVEYED SURVEY
 TEMPLATE
 NOTE BOOK
 AREAS CHECKED
 NO.

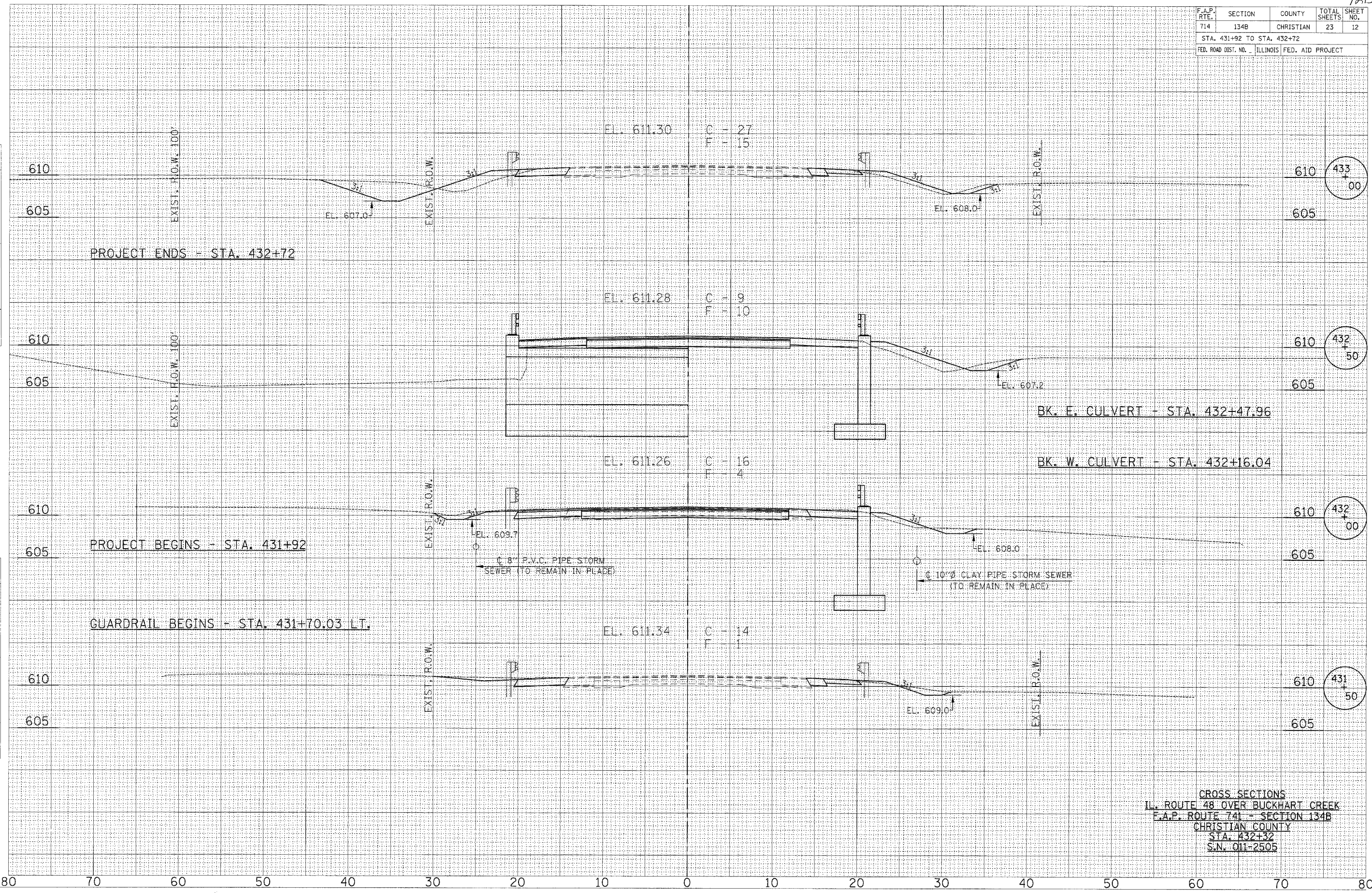

CROSS SECTIONS
 IL. ROUTE 48 OVER BUCKHART CREEK
 F.A.P. ROUTE 741 - SECTION 134B
 CHRISTIAN COUNTY
 STA. 432+32
 S.N. 011-2505

80 70 60 50 40 30 20 10 0 10 20 30 40 50 60 70 80