

F.A.P. RTE.	SECTION	COUNTY	TOTAL SHEETS	SHEET NO.
662		SANGAMON	18	12
STA. _____		TO STA. _____		
FED. ROAD DIST. NO. ILLINOIS FED. AID PROJECT				

D6 MEDIAN REPAIR 2005

PROPOSED CABLE DIAGRAM

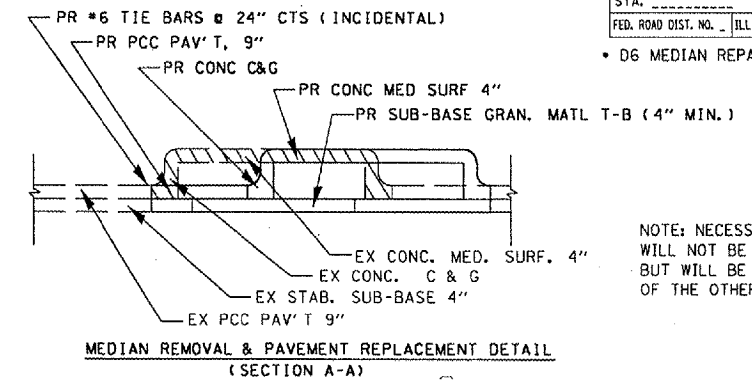
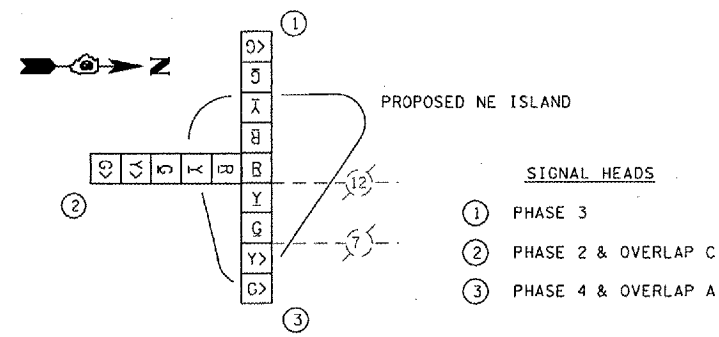

NOTE: NECESSARY EARTH EXCAVATION WILL NOT BE PAID FOR SEPARATELY, BUT WILL BE CONSIDERED AS PART OF THE OTHER BID ITEMS.

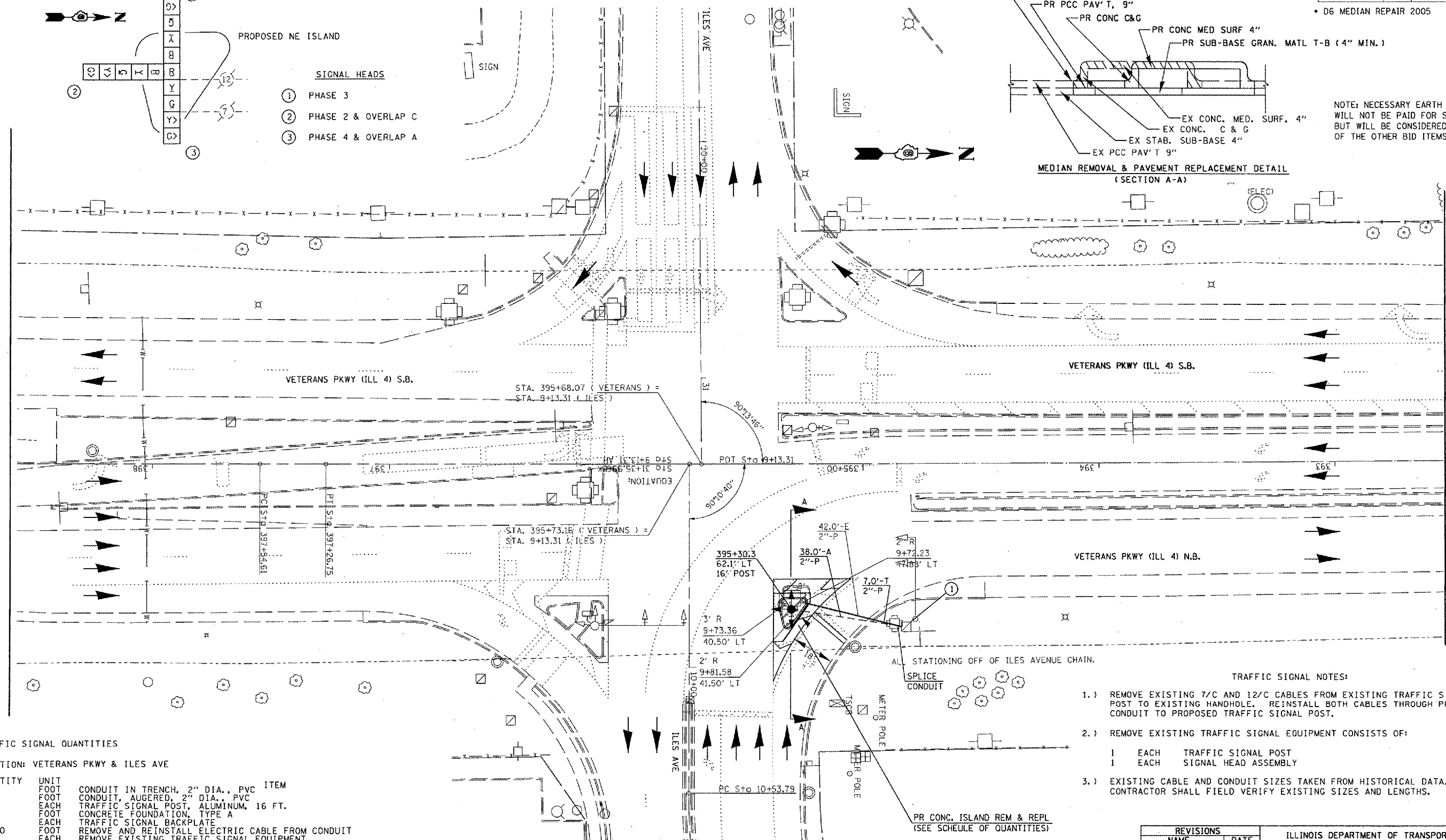

TRAFFIC SIGNAL NOTES:

- 1.) REMOVE EXISTING 7/C AND 12/C CABLES FROM EXISTING TRAFFIC SIGNAL POST TO EXISTING HANDHOLE. REINSTALL BOTH CABLES THROUGH PROPOSED CONDUIT TO PROPOSED TRAFFIC SIGNAL POST.
- 2.) REMOVE EXISTING TRAFFIC SIGNAL EQUIPMENT CONSISTS OF:
 - 1 EACH TRAFFIC SIGNAL POST
 - 1 EACH SIGNAL HEAD ASSEMBLY
- 3.) EXISTING CABLE AND CONDUIT SIZES TAKEN FROM HISTORICAL DATA. CONTRACTOR SHALL FIELD VERIFY EXISTING SIZES AND LENGTHS.

TRAFFIC SIGNAL QUANTITIES

LOCATION: VETERANS PKWY & ILES AVE

QUANTITY	UNIT	DESCRIPTION
7.0	FOOT	CONDUIT IN TRENCH, 2" DIA., PVC ITEM
38.0	FOOT	CONDUIT, AUGERED, 2" DIA., PVC
1.0	EACH	TRAFFIC SIGNAL POST, ALUMINUM, 16 FT.
3.0	FOOT	CONCRETE FOUNDATION, TYPE A
1.0	EACH	TRAFFIC SIGNAL BACKPLATE
116.0	FOOT	REMOVE AND REINSTALL ELECTRIC CABLE FROM CONDUIT
1.0	EACH	REMOVE EXISTING TRAFFIC SIGNAL EQUIPMENT
1.0	EACH	SIGNAL HEAD, POLYCARBONATE, L.E.D., 3-FACE, 1-4 SECTION, 2-5 SECTION, BRACKET MOUNTED

REVISIONS	
NAME	DATE

ILLINOIS DEPARTMENT OF TRANSPORTATION
LOCATION NO. 2
Plan Sheet
IL 4 @ ILES AVENUE
 SCALE: VERT. _____
 DATE _____ HORIZ. _____
 DRAWN BY BDK
 CHECKED BY JCN

PLOT DATE = 2/22/2005
 FILE NAME = I:\144\1144\1144.dgn
 PLOT SCALE = 43.3735 / IN.
 REFERENCE = #REF#