

PLAN	DATE
BY	
REVISIONS	
PLOTTED	
CHECKED	
DATE	
FILE NAME	

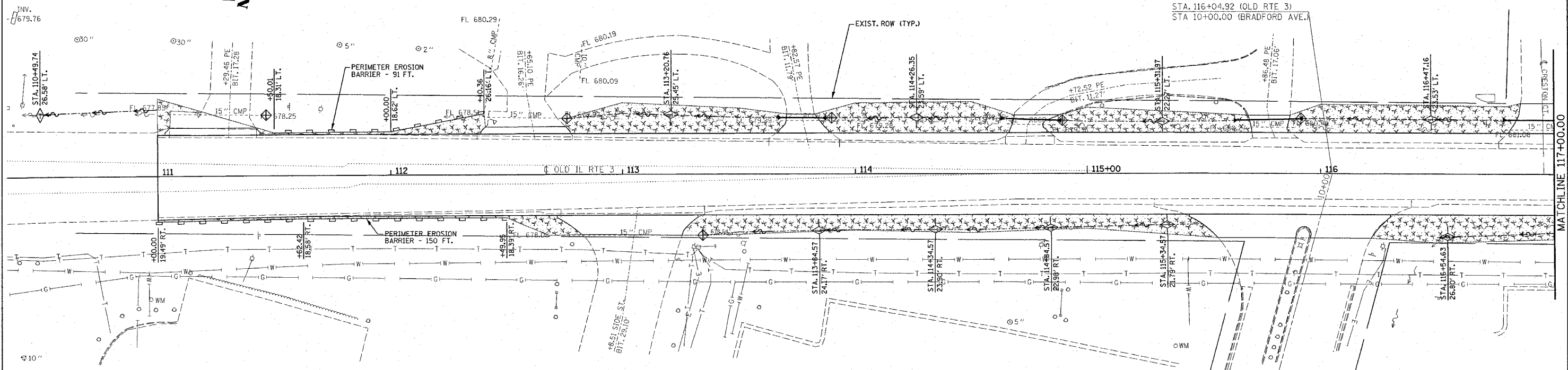

LEGEND

- SEEDING, FERTILIZER AND MULCH AREA
- PERIMETER EROSION CONTROL BARRIER
- INLET AND PIPE PROTECTION
- TEMPORARY DITCH CHECK

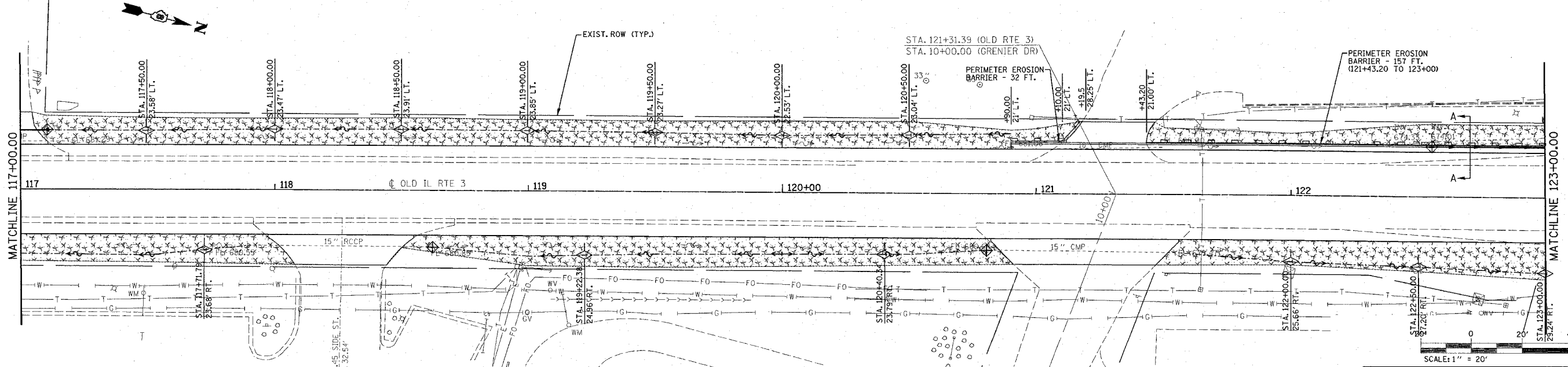

REVISIONS	
NAME	DATE

ILLINOIS DEPARTMENT OF TRANSPORTATION
EROSION AND SEDIMENT CONTROL PLAN
 FAU 9320
 SECTION 68WRS
 MONROE COUNTY
 DRAWN BY:

2/8/2005
 Tuesday, February 08, 2005 @ 9:19:25 AM
 C:\projects\fa9320\plan\erosion\plan\erosion.dwg
 L:\277\2024\277.dwg
 L:\277\2024\277.dwg
 L:\277\2024\277.dwg