

FAP ROUTE	SECTION	COUNTY	TOTAL SHEETS	SHEET NO
785	132-31, 133RS-5	MADISON	29	17
STA.	TO STA.			
CONTRACT NO.: 76796				

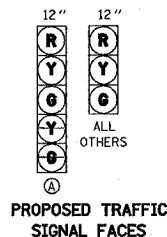

LEFT TURN
YIELD
ON GREEN
●
R10-12
24 x 30
DETAIL B
NOT TO SCALE

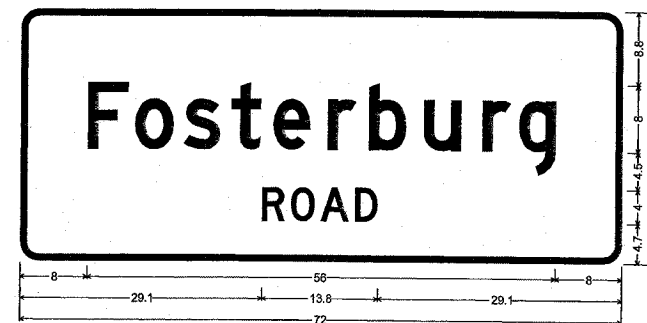

2.3" Radius, 0.6" Border, White on Green;
[Fosterburg] D 96% spacing; [ROAD] D;
Table of distances between letter and object lefts.

F	o	s	t	e	r	b	u	r	g		R	O	A	D			
8.0	5.7	5.9	5.8	4.9	6.5	4.9	6.5	7.0	4.3	4.5	8.0	29.1	3.4	3.6	4.1	2.7	29.1

STREET NAME SIGN
DETAIL C
NOT TO SCALE

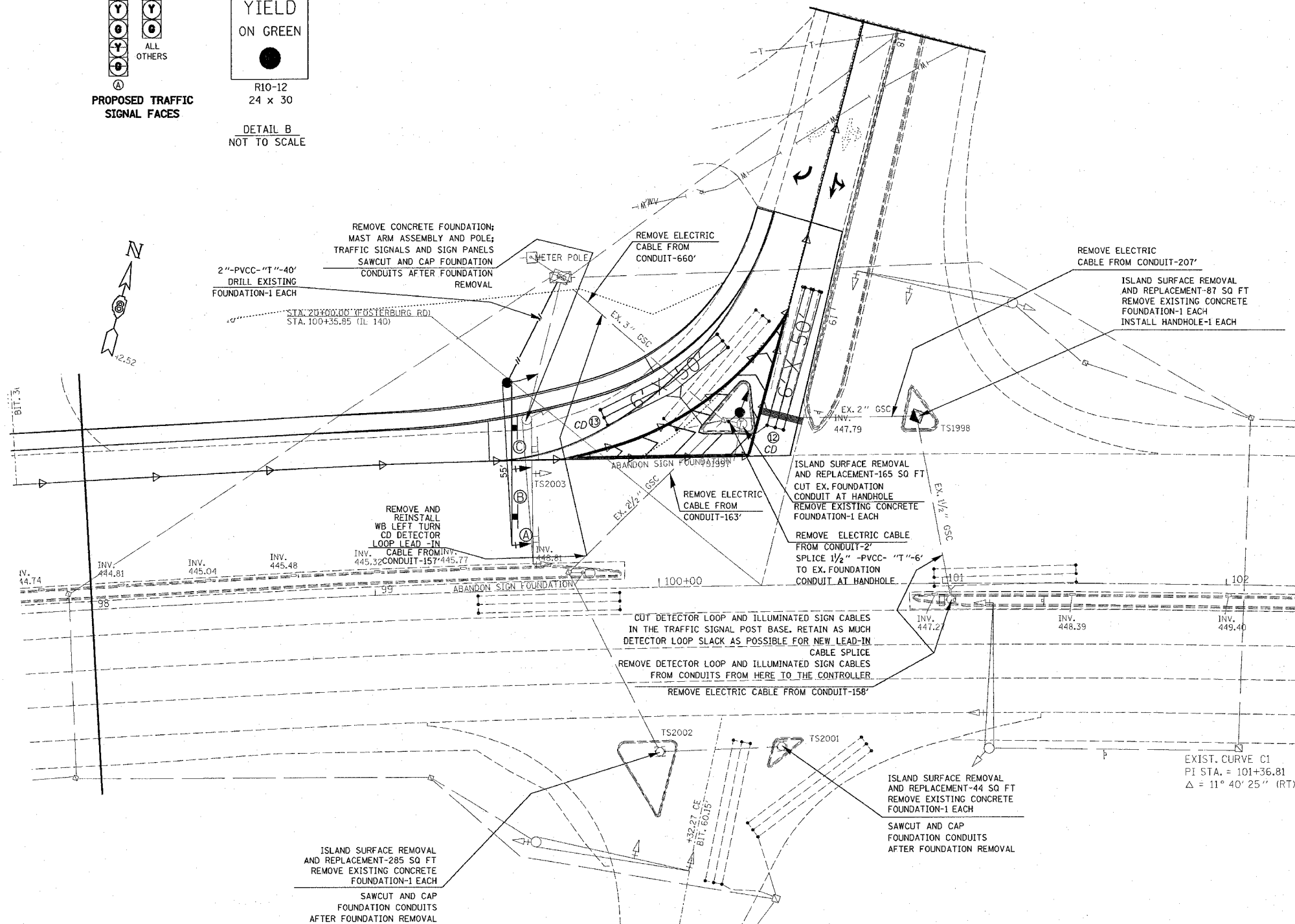

DETECTOR LOOP REQUIREMENTS AND CALCULATIONS FOR IL 111 AND FOSTERBURG RD.

LOOP	PHASE (Ø)	LOOP SIZE(FT)	REQUIRED # OF TURNS	CALCULATED INDUCTANCE MICROHENRIES (µH)	CALCULATED RESISTANCE OHMS (Ω)
1.-11.	NA	NA	NA	NA	NA
12. SB THRU-LT CD	4	6' X 50'	3-6-3	808	2.1
13. SB RT CD	4	6' X 50'	3-6-3	809	2.1

THE ABOVE VALUES ARE CALCULATED OF COMBINED LOOP AND LEAD-IN INDUCTANCE AND RESISTANCE. ACTUAL MEASURED VALUES SHOULD BE WITHIN +/- 20% OF THESE VALUES.

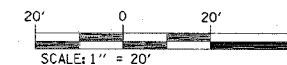

REVISIONS	
NAME	DATE

ILLINOIS DEPARTMENT OF TRANSPORTATION
TRAFFIC SIGNAL PLAN
LOCATION 1
IL 111 AND FOSTERBURG ROAD
FAP 785
SECTION 132-31, 133RS-5
MADISON COUNTY
DRAWN BY:

PLOT DATE: Tuesday February 08, 2005 @ 3:53:32 PM

PLAN	SURVEYED	BY	DATE
	FILED		
	NOTE BOOK		
	NO.		