

F.A.P. ROUTE NO.	SECTION	COUNTY	TOTAL SHEETS	SHEET NO.
0607	01-00014-00-FP	WILL	85	21
STA. 50+00 TO STA. 54+00		FED AID PROJECT CMF-0607 (070)		
FED. ROAD DIST. NO.		ILLINOIS	CONTRACT NO. 83786	

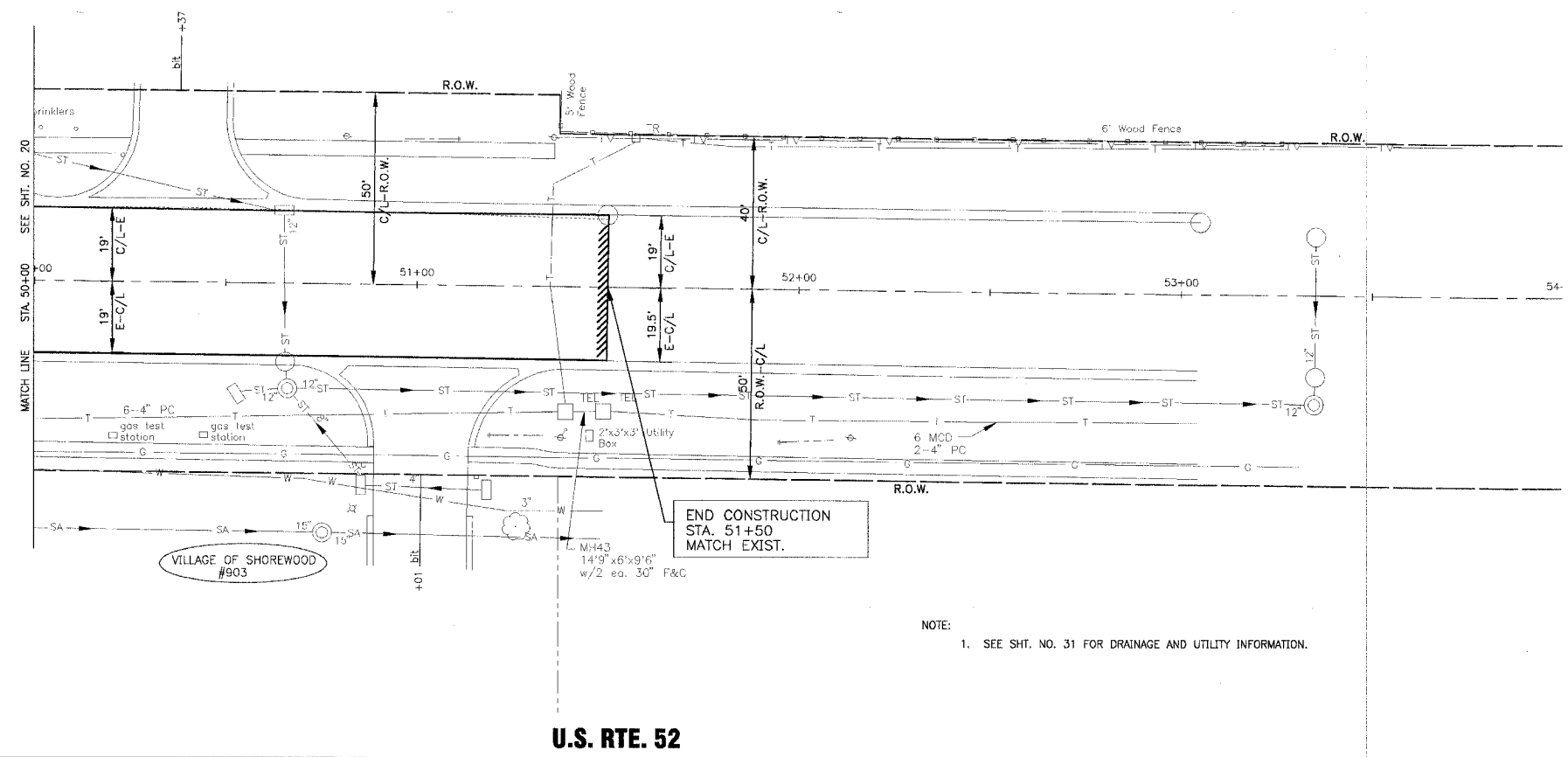

SCALE: 1" = 20'



NOTE:  
1. SEE SHT. NO. 31 FOR DRAINAGE AND UTILITY INFORMATION.

**U.S. RTE. 52**

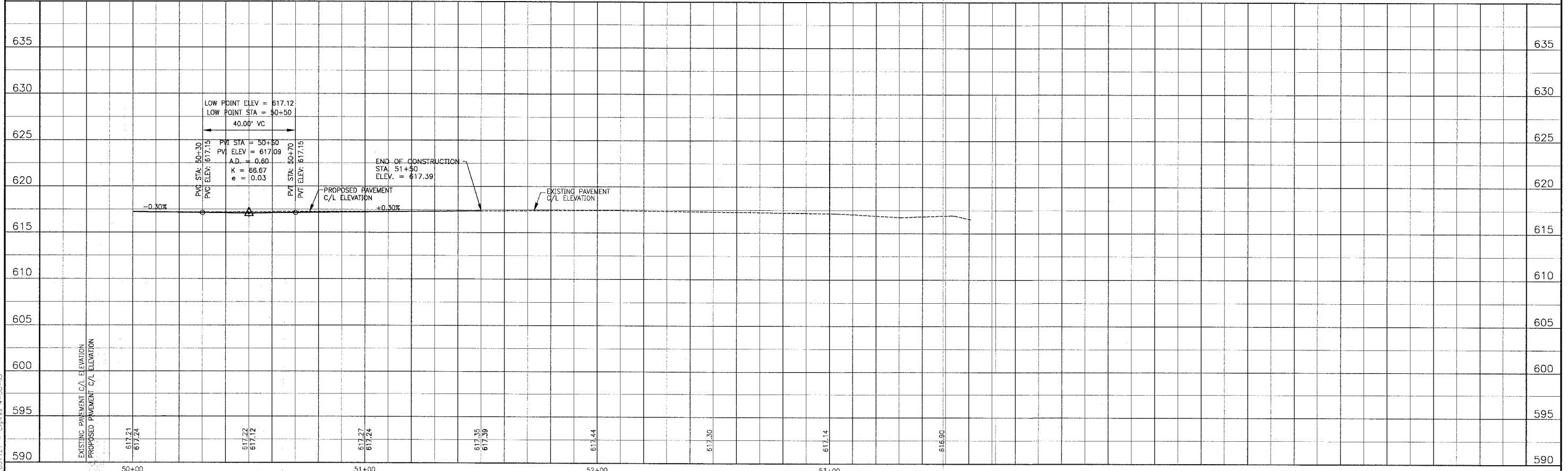

I:\SHOREWOOD\010665\DWG\010665-PRF.dwg  
 Plotter: 12-15-04 @ 10:17am Pr: 231ukb  
 Copyright ©2004, By Baxter & Woodman, Inc.  
 State of Illinois - Professional Design Firm  
 License No. - 184-001121 - Expires 4-30-05

CONSULTANTS	REV. NO.	DATE	DESCRIPTION
	1	12-21-04	PER I.D.O.T. REVIEW

DRAWING FILE: \_\_\_\_\_ PLOTTED BY: \_\_\_\_\_

**BAXTER & WOODMAN**  
 Consulting Engineers

*Baxter & Woodman*  
 Crystal Lake, Illinois 815.459.1260  
 Burlington, Wisconsin 262.763.7834  
 Mokena, Illinois 708.478.2090  
 DeKalb, Illinois 815.787.3111  
 Grayslake, Illinois 847.223.5088  
 Rockford, Illinois 815.489.1551

**VILLAGE OF SHOREWOOD, ILLINOIS**  
**U.S. ROUTE 52 IMPROVEMENTS**

DESIGNED BY LDH	SCALE VERT: 1"=5'
DRAWN BY UKB	HORIZ: 1"=20'
CHECKED BY LDH	PROJECT NO. 010665
DATE 10-05-04	SHEET NO. 21 OF 85