

F.A.P. ROUTE NO.	SECTION	COUNTY	TOTAL SHEETS	SHEET NO.
0607	01-00014-00-FP	WILL.	85	23
STA. 54+00	TO STA. 57+50			
FED. ROAD DIST. NO.	ILLINOIS	FED AID PROJECT CMF-0607 (070)		
CONTRACT NO. 83786				

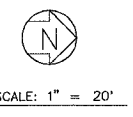

NOTE:
1. SEE SHT. NO. 33 FOR DRAINAGE AND UTILITY INFORMATION.

RIVER ROAD

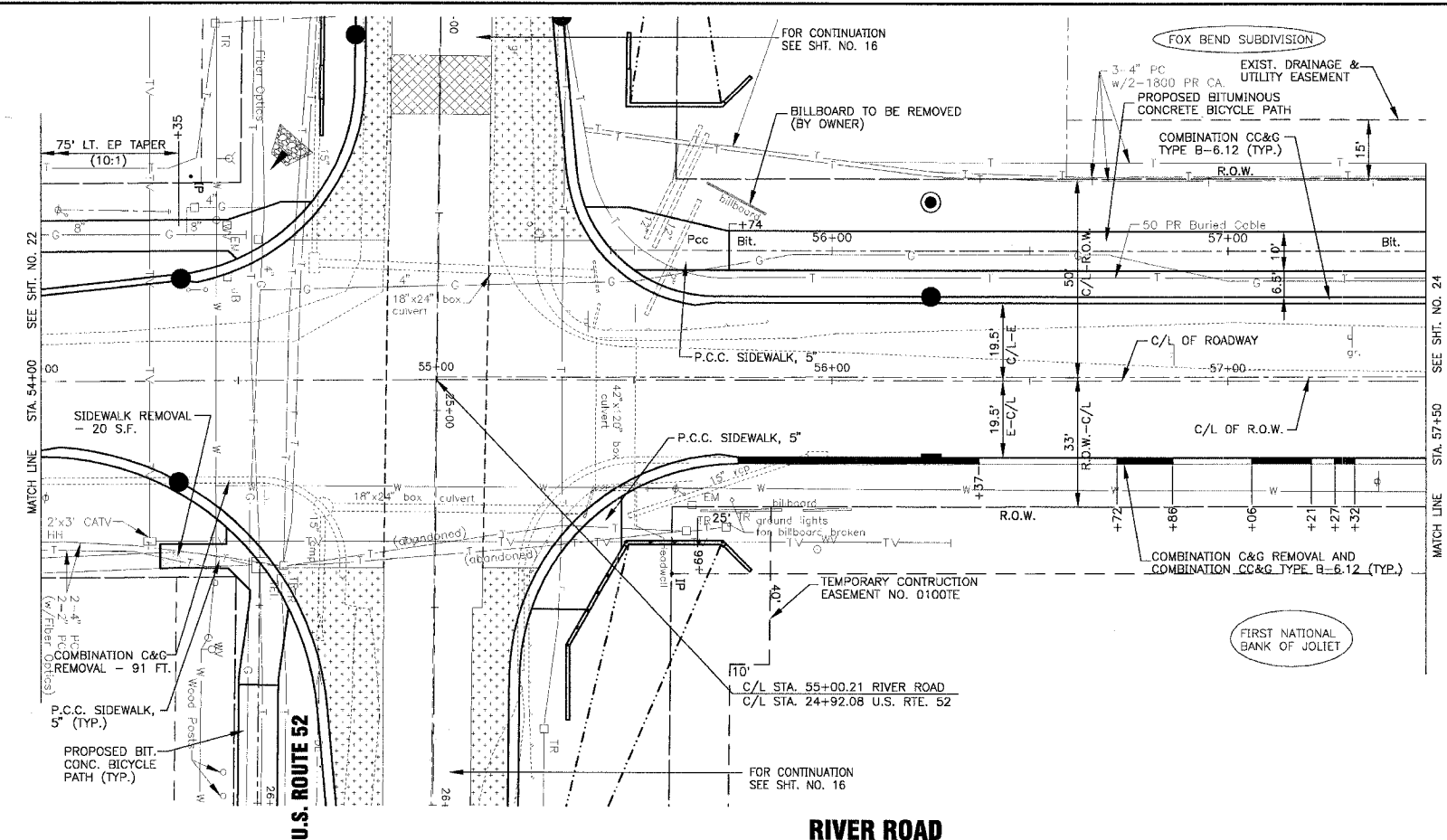
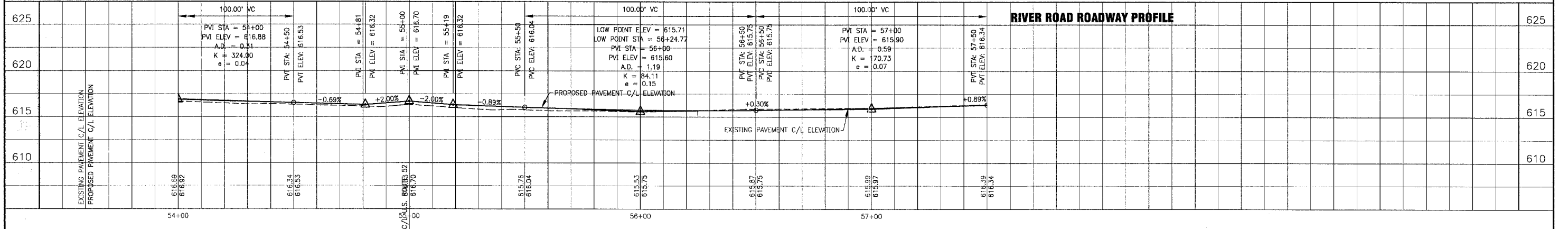

RIVER ROAD BICYCLE PROFILE
(WEST SIDE OF ROAD)

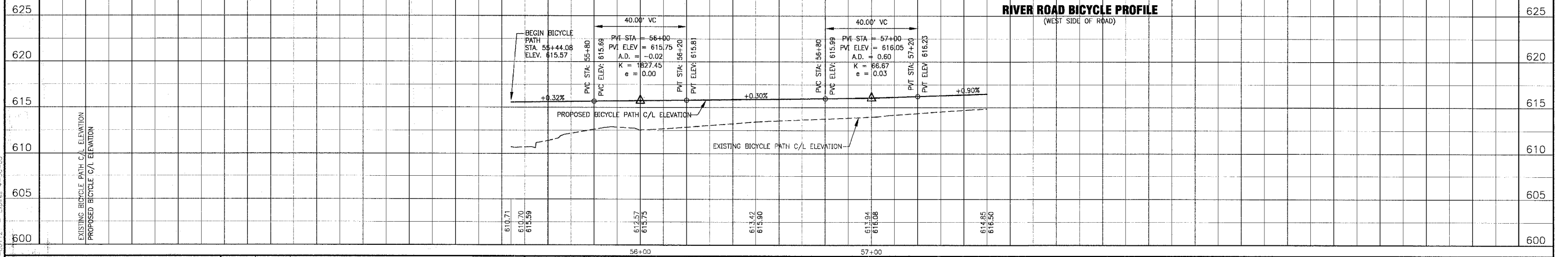

I:\SHRIMP\010665\DWG\SA\10665-PRF.dwg
 Plotted: 12-15-04 @ 10:19am By: 231ubh
 Copyright © 2004, By Baxter & Woodman, Inc.
 State of Illinois - Professional Design Firm
 License No. 184-00112 - Expires 4-30-05

CONSULTANTS	REV. NO.	DATE	DESCRIPTION
	1	12-21-04	PER I.D.O.T. REVIEW

DRAWING FILE: _____ PLOTTED BY: _____

BAXTER & WOODMAN
Consulting Engineers

Baxter & Woodman
Crystal Lake, Illinois 815.459.1280
Burlington, Wisconsin 262.763.7834
Mokena, Illinois 708.478.2090
DeKalb, Illinois 815.787.3111
Rockford, Illinois 815.223.5088
Rockford, Illinois 815.489.1551

VILLAGE OF SHOREWOOD, ILLINOIS
U.S. ROUTE 52 IMPROVEMENTS

RIVER ROAD
STA. 54+00 TO STA. 57+50
GEOMETRIC PLAN

DESIGNED BY LDH	SCALE VERT: 1"=5'
DRAWN BY UKB	HORIZ: 1"=20'
CHECKED BY LDH	PROJECT NO. 010665
DATE 10-05-04	SHEET NO. 23 OF 85