

F.A.P. ROUTE NO.	SECTION	COUNTY	TOTAL SHEETS	SHEET NO.
0607	01-00014-00-FP	WILL.	85	32
STA.	TO STA.	ILLINOIS		FED. AID PROJECT CMF-0607 (07D)
FED. ROAD DIST. NO.		CONTRACT NO. 83786		

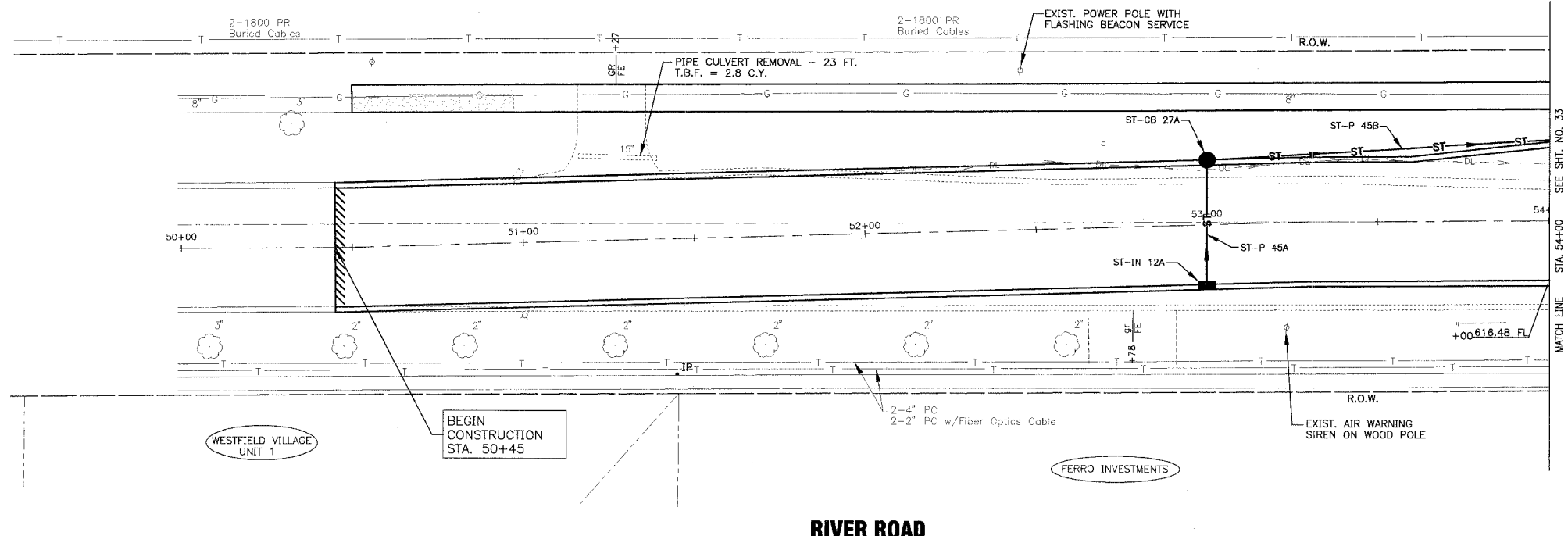

SCALE: 1" = 20'



- INLETS**
- ST-IN 12A
INLET, TY A, TY 11 F&G
STA. 53+00 19' RT.
FL = 616.95
INV. 614.20 12" W
- CATCH BASINS**
- ST-CB 27A
CATCH BASIN, TY C, TY 11 F&G
2" DIA.
STA. 53+00 19' LT.
FL = 616.95
INV. 613.84 12" E & N
- STORM SEWER PIPES**
- ST-P 45A
36 L.F. OF 12" STRG, CL A, TY 1 @ 1.00%
T.B.F. = 8.5 C.Y.
 - ST-P 45B
135 L.F. OF 12" STRG, CL A, TY 1 @ 0.45%
T.B.F. = 31.9 C.Y.

- NOTE:
- FOR CONTINUATION SEE SHT. NO. 22 FOR GEOMETRIC INFORMATION.
 - DATUM CORRELATION: BAXTER & WOODMAN, INC. SURVEY DATA SHOULD BE ADJUSTED BY -0.12' TO MATCH FEM A REFERENCE MARK DATUM.

RIVER ROAD

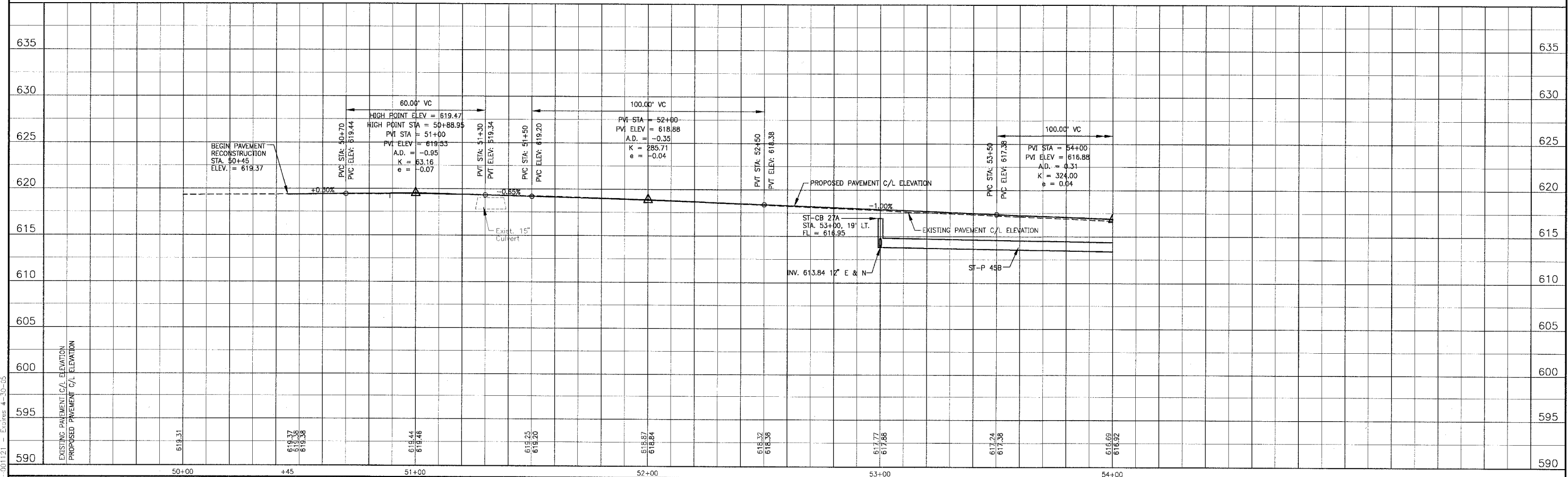

I:\SHRWD\010665\DWG\51\0665-PRF.dwg
 Plotted: 12-15-04 @ 10:43am By: 231ukb
 Copyright © 2004, by Baxter & Woodman, Inc.
 State of Illinois Professional Design Firm
 License No. 08-00121 Expires 4-30-05

CONSULTANTS	REV. NO.	DATE	DESCRIPTION
	1	12-21-04	PER I.D.O.T. REVIEW

* REFER TO EQUIPMENT MANUFACTURER'S SHOP DRAWINGS DRAWING FILE: PLOTTED BY:

BAXTER & WOODMAN
 Consulting Engineers

Baxter & Woodman
 Crystal Lake, Illinois 815.459.1260
 Burlington, Wisconsin 262.763.7834
 Mokena, Illinois 708.478.2090
 DeKalb, Illinois 815.787.3111
 Grayslake, Illinois 847.223.5088
 Rockford, Illinois 815.488.1551

VILLAGE OF SHOREWOOD, ILLINOIS
U.S. ROUTE 52 IMPROVEMENTS

RIVER ROAD
STA. 50+00 TO STA. 54+00
DRAINAGE & UTILITY PLAN

DESIGNED BY LDH	SCALE VERT: 1"=5'
DRAWN BY UKB	HORIZ: 1"=20'
CHECKED BY LDH	PROJECT NO. 010665
DATE 10-05-04	SHEET NO. 32 OF 85