

| | | | | |
|---------------------|----------------|---------------------------------|--------------|-----------|
| F.A.P. ROUTE NO. | SECTION | COUNTY | TOTAL SHEETS | SHEET NO. |
| 0607 | 01-00014-00-FP | WILL | 85 | 53 |
| STA. | TO STA. | | | |
| FED. ROAD DIST. NO. | ILLINOIS | FED. AID PROJECT CMF-0607 (070) | | |

CONTRACT NO. 83786

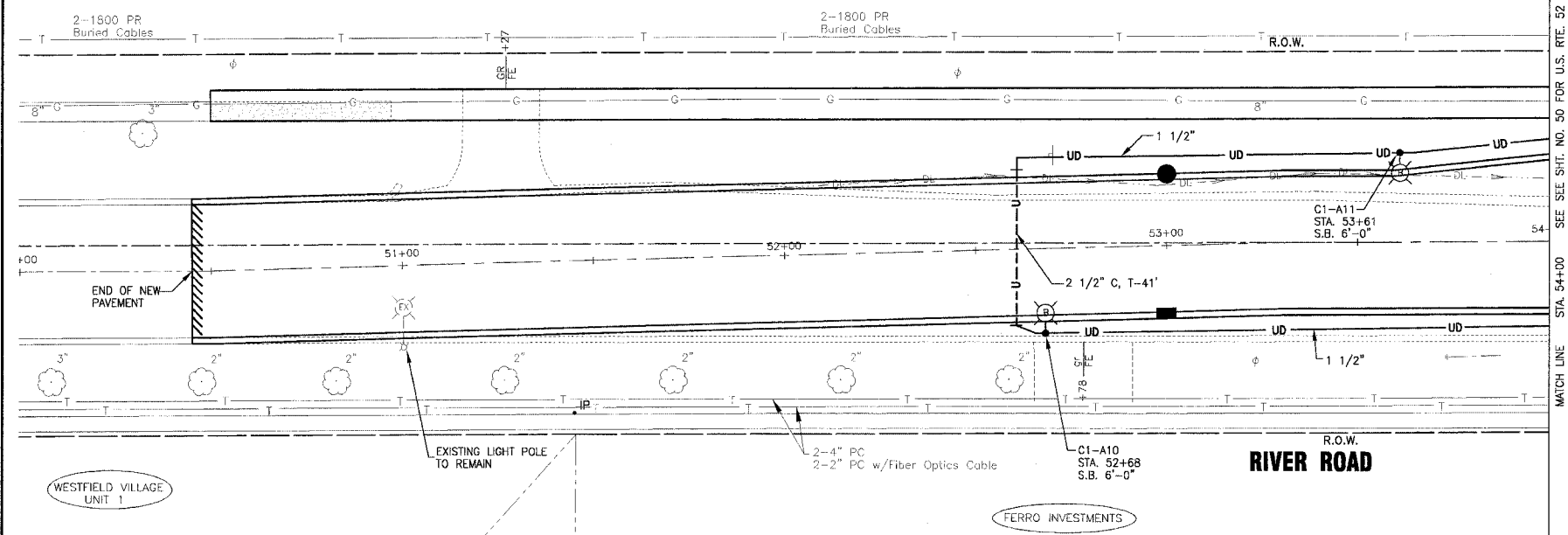

SCALE: 1" = 20'



LEGEND

- 2 1/2" C, P-20' 2 1/2" CONDUIT SLEEVE PUSHED 20' LONG FOR 1 1/2" UNIT DUCT
- 2 1/2" C, T-20' 2 1/2" CONDUIT SLEEVE IN TRENCH 20' LONG FOR 1 1/2" UNIT DUCT
- 1 1/4" 1 1/2" UNIT DUCT WITH 2#6, 2#4 & 1#6 GROUND (OR AS INDICATED)
- LIGHT POLE WITH 310 WATT HPS LUMINAIRE MOUNTED AT 35' MOUNTING HEIGHT
- LIGHT POLE WITH 70 WATT HPS LUMINAIRE MOUNTED AT 16' MOUNTING HEIGHT
- LIGHTING CONTROLLER C1, CIRCUIT B1 SETBACK 6'-0" FROM FRONT OF CURB
- EXISTING LIGHTING CONTROLLER
- LIGHTING CONTROLLER

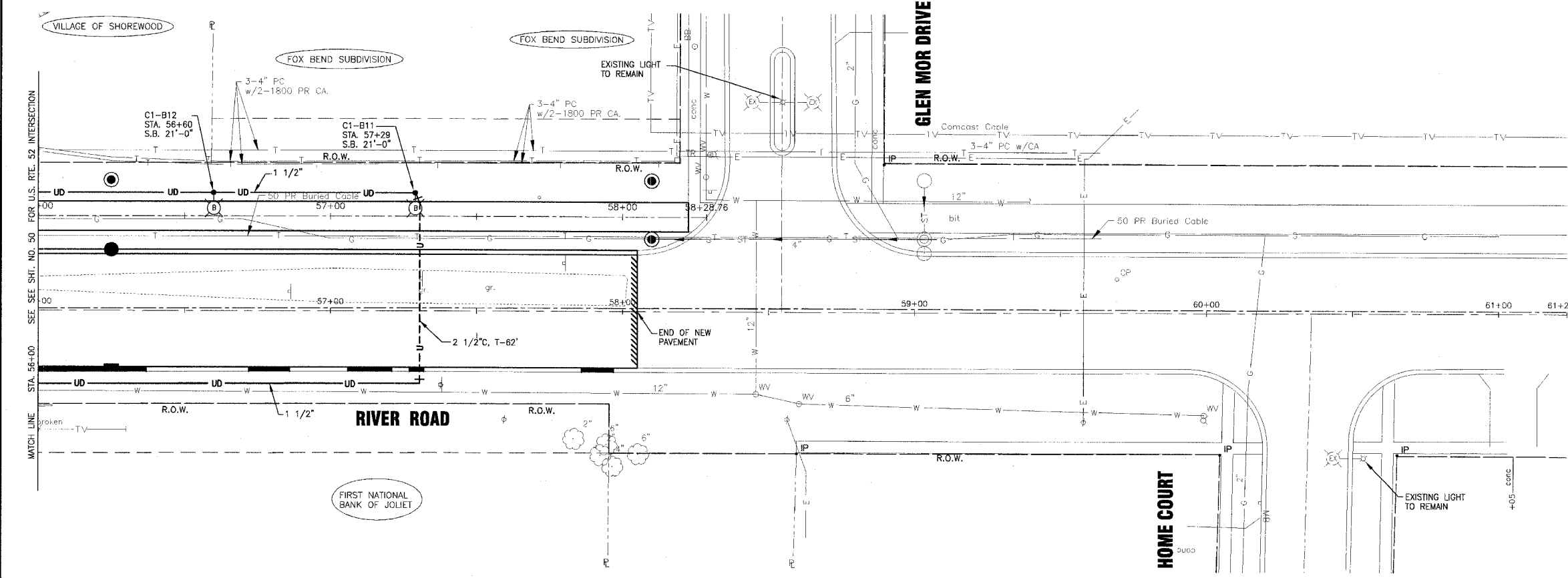

SCALE: 1" = 20'

C:\Land Projects\2004\shrd\010665\dwgs\10665LGH.dwg
 Plotted: 12-23-04 @ 10:51am By: 231ubb
 Copyright © 2004, by Baxter & Woodman, Inc.
 State of Illinois Professional Design Firm
 License No. 187-501121 - Expires 11-30-05

| CONSULTANTS | REV. NO. | DATE | DESCRIPTION |
|-------------|----------|----------|---------------------|
| | 1 | 11-29-04 | PER I.D.O.T. REVIEW |
| | 2 | 12-21-04 | PER I.D.O.T. REVIEW |

* REFER TO EQUIPMENT MANUFACTURER'S SHOP DRAWINGS DRAWING FILE: PLOTTED BY:



Baxter & Woodman
 Crystal Lake, Illinois 815.459.1260
 Burlington, Wisconsin 262.763.7834
 Mokena, Illinois 708.478.2090
 DeKalb, Illinois 815.787.3111
 Grayslake, Illinois 847.223.5088
 Rockford, Illinois 815.488.1551

VILLAGE OF SHOREWOOD, ILLINOIS
U.S. ROUTE 52 IMPROVEMENTS

RIVER ROAD
STREET LIGHTING
STA. 50+00 TO STA. 61+00

| | | | |
|-------------|----------|-------------|---------------|
| DESIGNED BY | JLR | SCALE | HORIZ: 1"=20' |
| DRAWN BY | UKB | PROJECT NO. | 010665 |
| CHECKED BY | JLR | SHEET NO. | 53 OF 85 |
| DATE | 10-05-04 | | |

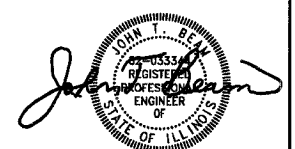

LICENSE EXPIRES 11-30-05