

FAS RTE	SECTION	COUNTY	TOTAL SHEETS	SHEET NO.
TR 384	04-01119-00-BR 04-04126-00-BR	HENRY	13	2
F.H.W.A. REG.	ILLINOIS	PROJECT	BR-OS-073(49)	

B.M. 1 - 60p Nail in Power Pole
Sta. 106 + 96 13' Left
Elev. 201.50

B.M. 2 - 60p Nail in Power Pole
Sta. 109 + 79 53' Right
Elev. 202.16

PROPOSED STRUCTURE: A Three Span (40-80-40)
Precast Prestressed Concrete Deck Beam (33")
Bridge on Pile Bent Abutments and Concrete Encased
Pile Bent Piers

EXISTING STRUCTURE: A Single Span Steel Throug
Truss (140') on Closed Concrete Abutments

SEEDING QUANTITIES

Seeding Class 6 0.73Acre
Nitrogen Fert. Nutr. 66 lb.
Phosphorus Fert. Nutr. 66 lb.
Potassium Fert. Nutr. 66 lb.
Mulch Method 2 0.73 Acre

AGGREGATE BASE COURSE, TYPE B

Sta. 103+00 To 107+19.25 381 Tons
Sta. 108+80.75 To 111+25 221 Tons
Sta. 104+50 FEL, FER 52 Tons
Total 654 Tons

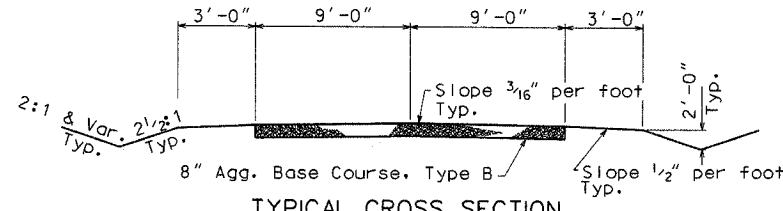
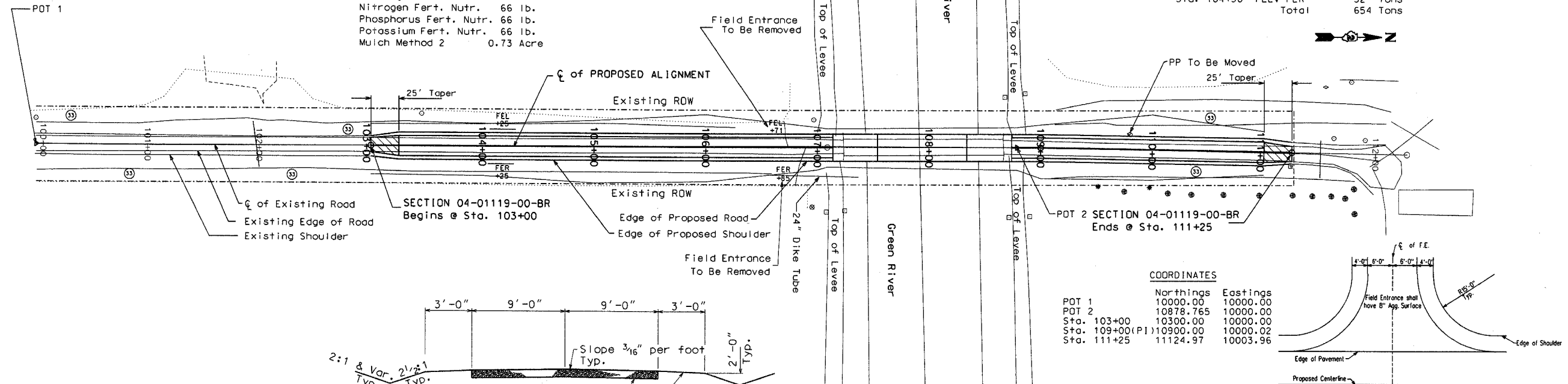

COORDINATES

	Northings	Eastings
POT 1	10000.00	10000.00
POT 2	10878.765	10000.00
Sta. 103+00	10300.00	10000.00
Sta. 109+00 (PI)	10900.00	10000.02
Sta. 111+25	11124.97	10003.96

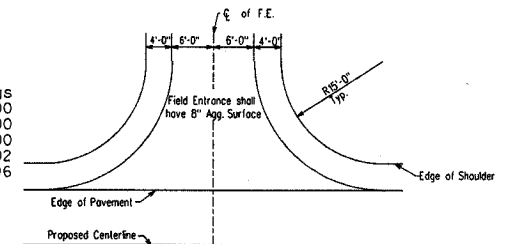

SCALES:
1" = 50' HOR
1" = 5' VER

