

RTE	SECTION	COUNTY	TOTAL SHEETS	SHEET NO.
• 02-00088-00-BR	MORGAN	76	7	
STA.	TO STA.			
FED. ROAD DIST. NO.	ILLINOIS	FED. AID PROJECT		

• COUNTY HIGHWAY 19 (FAS 611)
CONTRACT NO. 93388

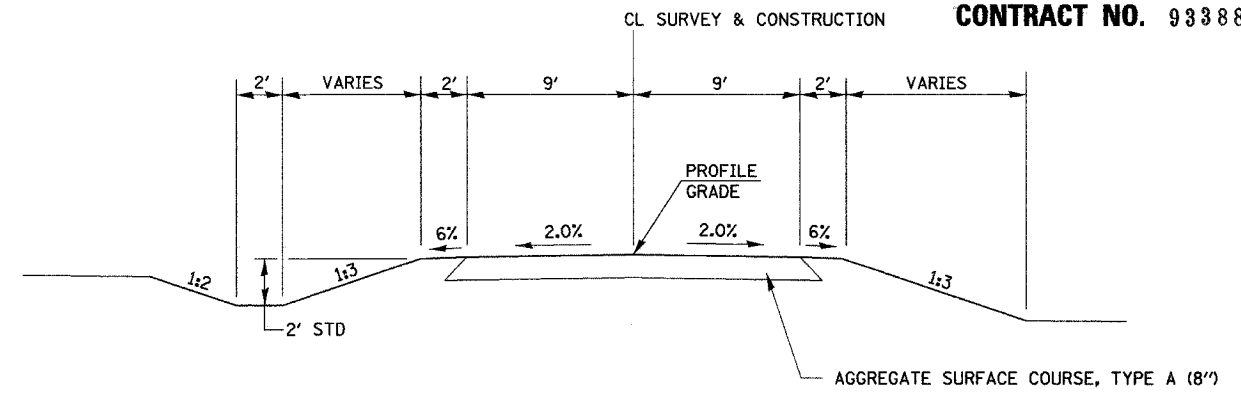
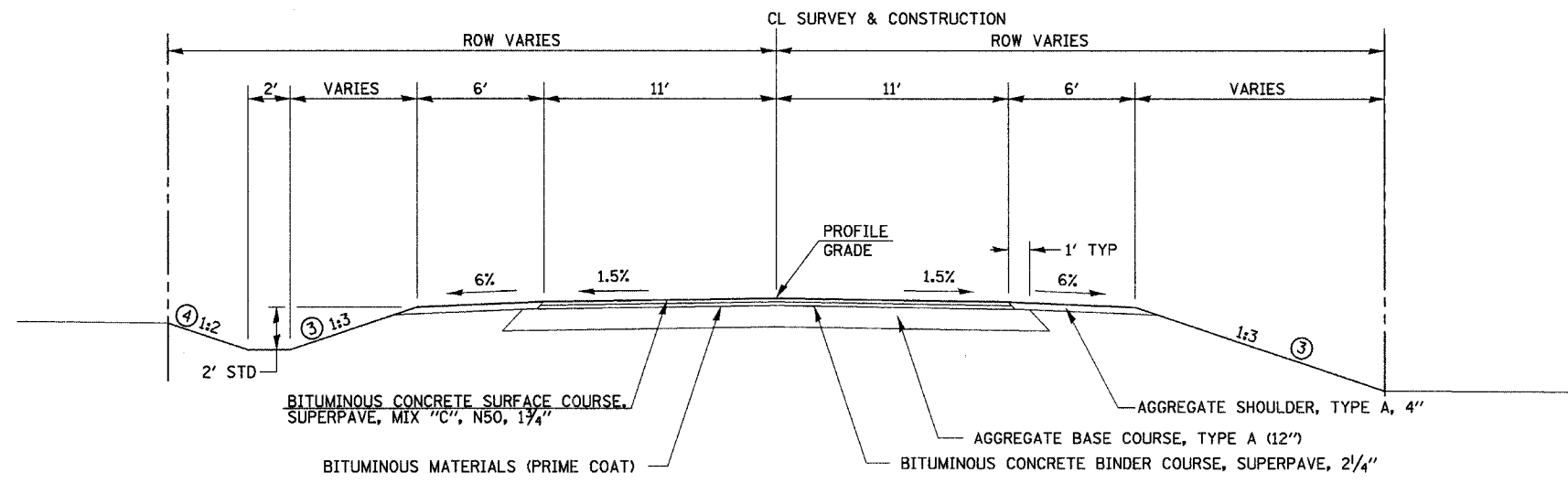

PROPOSED TYPICAL SECTION
 JOHNSON ROAD (TR 260) STATION 10+41.00 TO STATION 13+11.00

NOTE: THE PROPOSED CH 19 PAVEMENT SHALL BE CONSTRUCTED THROUGH THE TR 260 INTERSECTION TO THE BACK OF RETURNS AT STATION 10+41.

PROPOSED TYPICAL SECTION
 LITERBERRY-PRENTICE ROAD (CH 19)
 STATION 150+50.00 TO STATION 159+74.40
 BRIDGE OMISSION STATION 159+74.40 TO STATION 162+17.98
 STATION 173+77.01 TO STATION 173+94.26
 STATION 186+12.47 TO STATION 186+50.00
 E STRAWN CROSSING ROAD (CH 2)
 STATION 37+05.00 TO STATION 46+07.75
 STATION 52+79.89 TO STATION 54+22.03

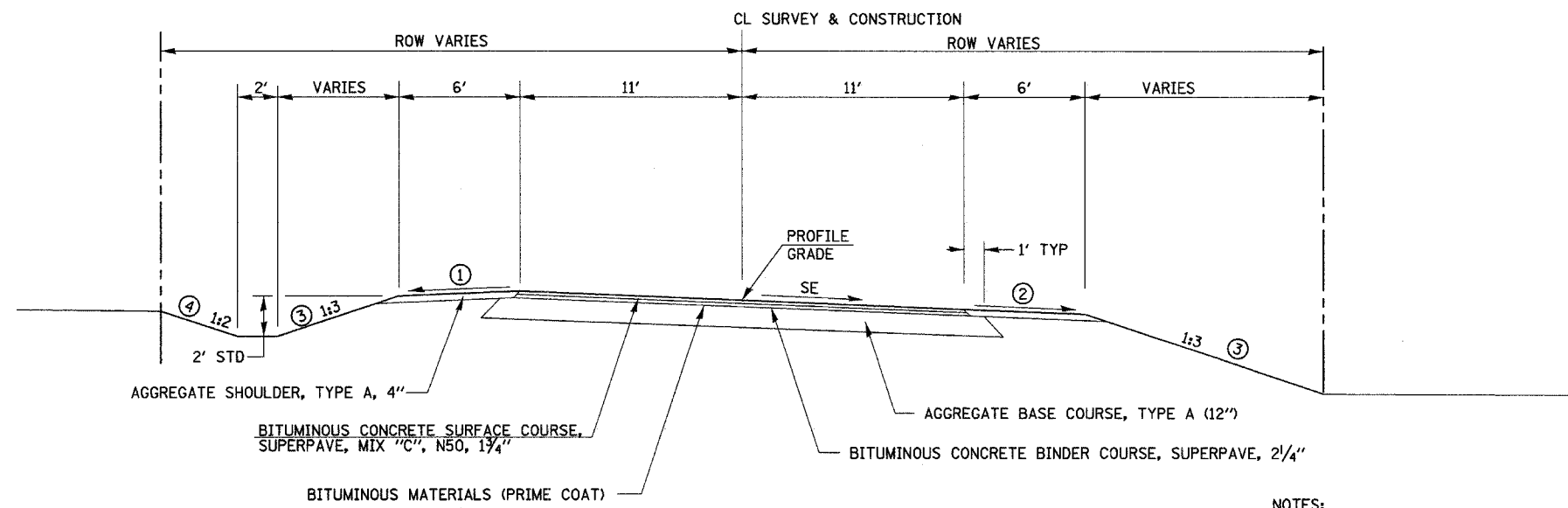

PROPOSED TYPICAL SUPERELEVATION SECTION
 LITERBERRY-PRENTICE ROAD (CH 19)
 CURVE LEFT
 STATION 161+91.68 TO STATION 163+81.68 SE TRANSITION (PARTIALLY ON BRIDGE)
 STATION 163+81.68 TO STATION 171+87.01 8% SE
 STATION 171+87.01 TO STATION 173+77.01 SE TRANSITION
 CURVE RIGHT
 STATION 173+94.26 TO STATION 175+84.26 SE TRANSITION
 STATION 175+84.26 TO STATION 184+22.47 8% SE
 STATION 184+22.47 TO STATION 186+12.47 SE TRANSITION
 E STRAWN CROSSING ROAD (CH 2)
 CURVE LEFT
 STATION 46+07.75 TO STATION 47+97.05 SE TRANSITION
 STATION 47+97.05 TO STATION 50+89.89 8% SE
 STATION 50+89.89 TO STATION 52+79.89 SE TRANSITION

- NOTES:**
- HIGH SIDE
6% & VARIES, 10% MAXIMUM BREAKOVER.
 - LOW SIDE
6% OR SE, WHICHEVER IS GREATER.
 - FOR FILL HEIGHTS > 10' USE 1:2.
 - FOR CUT DEPTHS > 15' USE BENCH DITCH IN BACKSLOPE.
 - IN GUARDRAIL LOCATIONS, WIDEN SHOULDER BY 3'-3".

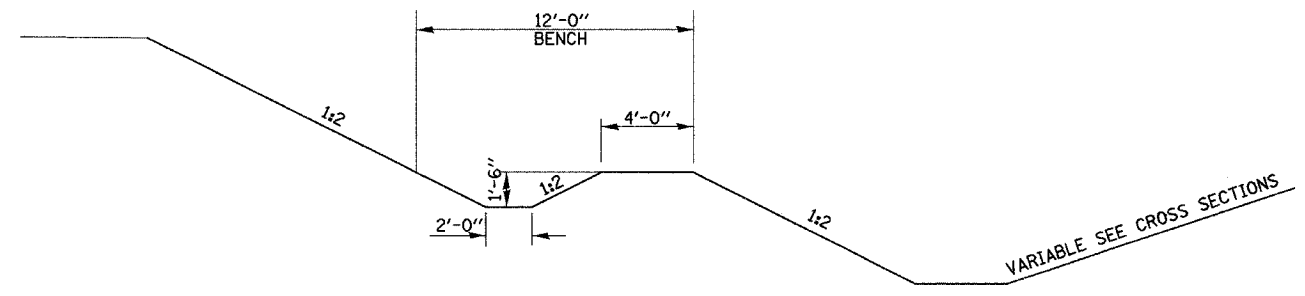

BENCH DITCH IN BACKSLOPE

STRUCTURAL DESIGN INFORMATION
 COUNTY HIGHWAY 19 (FAS 611)

ROAD CLASSIFICATION: CLASS III (80,000 lb)
 STRUCTURAL DESIGN TRAFFIC (2014):
 PV = 283 SU = 23 MU = 17
 PERCENT OF STRUCTURAL DESIGN TRAFFIC IN DESIGN LANE:
 P = 50% S = 50% M = 50%
 MINIMUM SUBGRADE SUPPORT RATING: IBR = 3.0
 FLEXIBLE PAVEMENT DESIGN: MINIMUM TF = 0.091
 BIT CONC SURFACE COURSE, SUPERPAVE, MIX "C", N50, 1 3/4"
 BIT CONC BINDER COURSE, SUPERPAVE 2 1/4"
 AGGREGATE BASE COURSE, TYPE A, 12"

REVISIONS	
NAME	DATE

ILLINOIS DEPARTMENT OF TRANSPORTATION
 LITERBERRY-PRENTICE ROAD (CH 19)
 E. STRAWN CROSSING ROAD (CH 2)
 AND JOHNSON ROAD (TR 260)
 PROPOSED TYPICAL SECTIONS

SCALE: _____
 DATE: _____
 DRAWN BY: KLS
 CHECKED BY: JRB