

F.A. RTE.	SECTION	COUNTY	TOTAL SHEETS	SHEET NO.
* D2-00088-00-BR		MORGAN	76	21
STA. 165+00		TO STA. 180+00		
FED. ROAD DIST. NO.	ILLINOIS	FED. AID PROJECT		
* COUNTY HIGHWAY 19 (FAS 611)				
CONTRACT NO. 93388				

MORGAN COUNTY
SEC 18, T 16 N, R 9 W, 3RD PM

SEC 7, T 16 N, R 9 W, 3RD PM

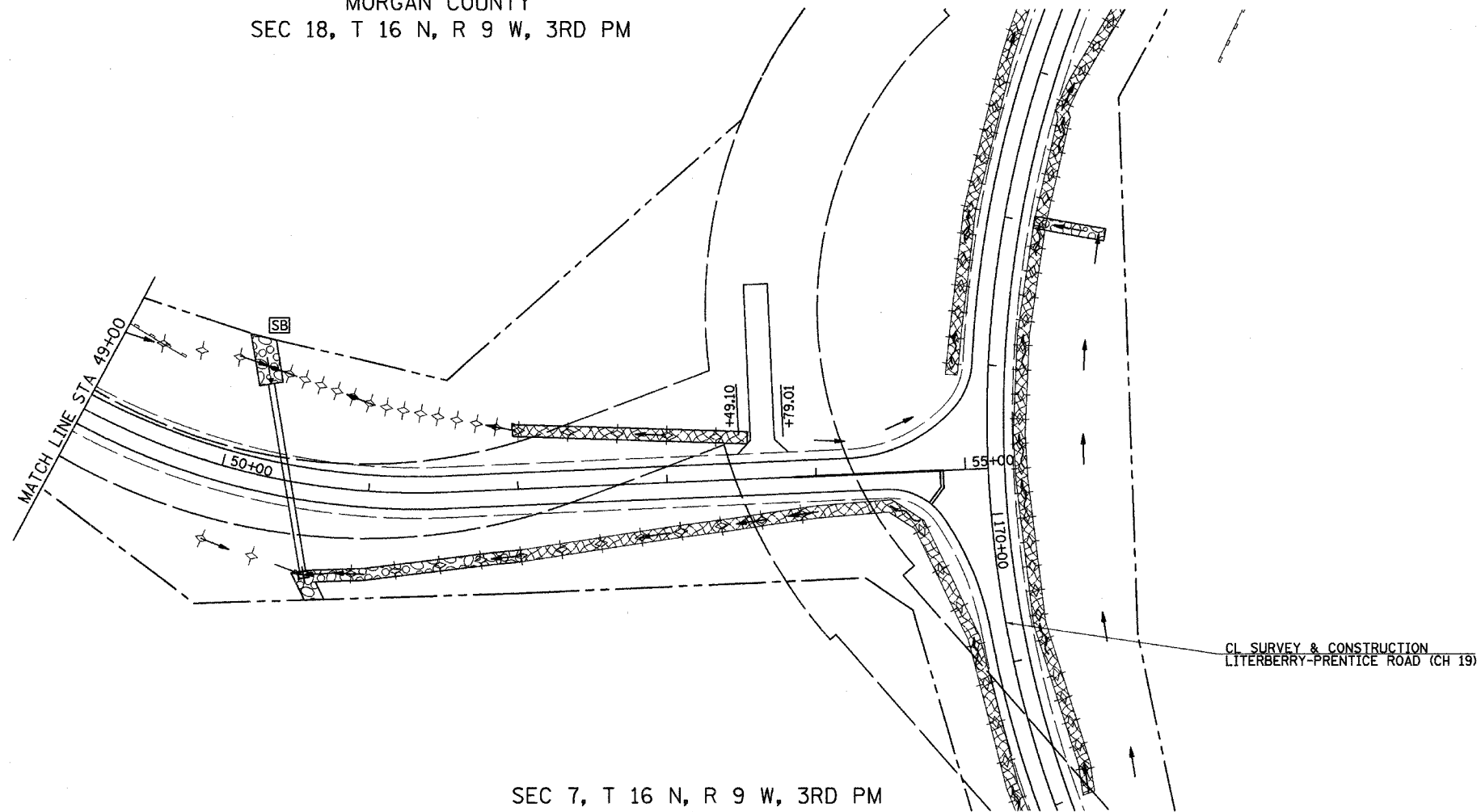

SEC 7, T 16 N, R 9 W, 3RD PM

CL SURVEY & CONSTRUCTION
LITERBERRY-PRENTICE ROAD (CH 19)

LEGEND

- PERIMETER EROSION BARRIER
- EROSION CONTROL BLANKET
- AGGREGATE DITCH
- TEMPORARY DITCH CHECK
- INLET & PIPE PROTECTION
- STANDARD DITCH - FLOW LINE AND DIRECTION
- SPECIAL DITCH - FLOW LINE AND DIRECTION
- PROPOSED RIPRAP PLACEMENT

NOTE: TEMPORARY EROSION CONTROL SEEDING SHALL BE DONE IN ACCORDANCE WITH ARTICLE 280.04 OF THE STANDARD SPECIFICATIONS.

REVISIONS		ILLINOIS DEPARTMENT OF TRANSPORTATION
NAME	DATE	
		STORM WATER POLLUTION PREVENTION PLAN E STRAWN CROSSING ROAD (CH 2) STA 49+00 TO STA 55+00
SCALE: VERT. _____		DRAWN BY _____
DATE _____		