

F.A.P. RTE.	SECTION	COUNTY	TOTAL SHEETS	SHEET NO.
774	.	EFFINGHAM	273	75
FED. ROAD DIST. NO. 7 ILLINOIS			FED. AID PROJECT	
*107WRS-1, 107BY, 107BY-1 & 107B-2				
CONTRACT NO. 94827				

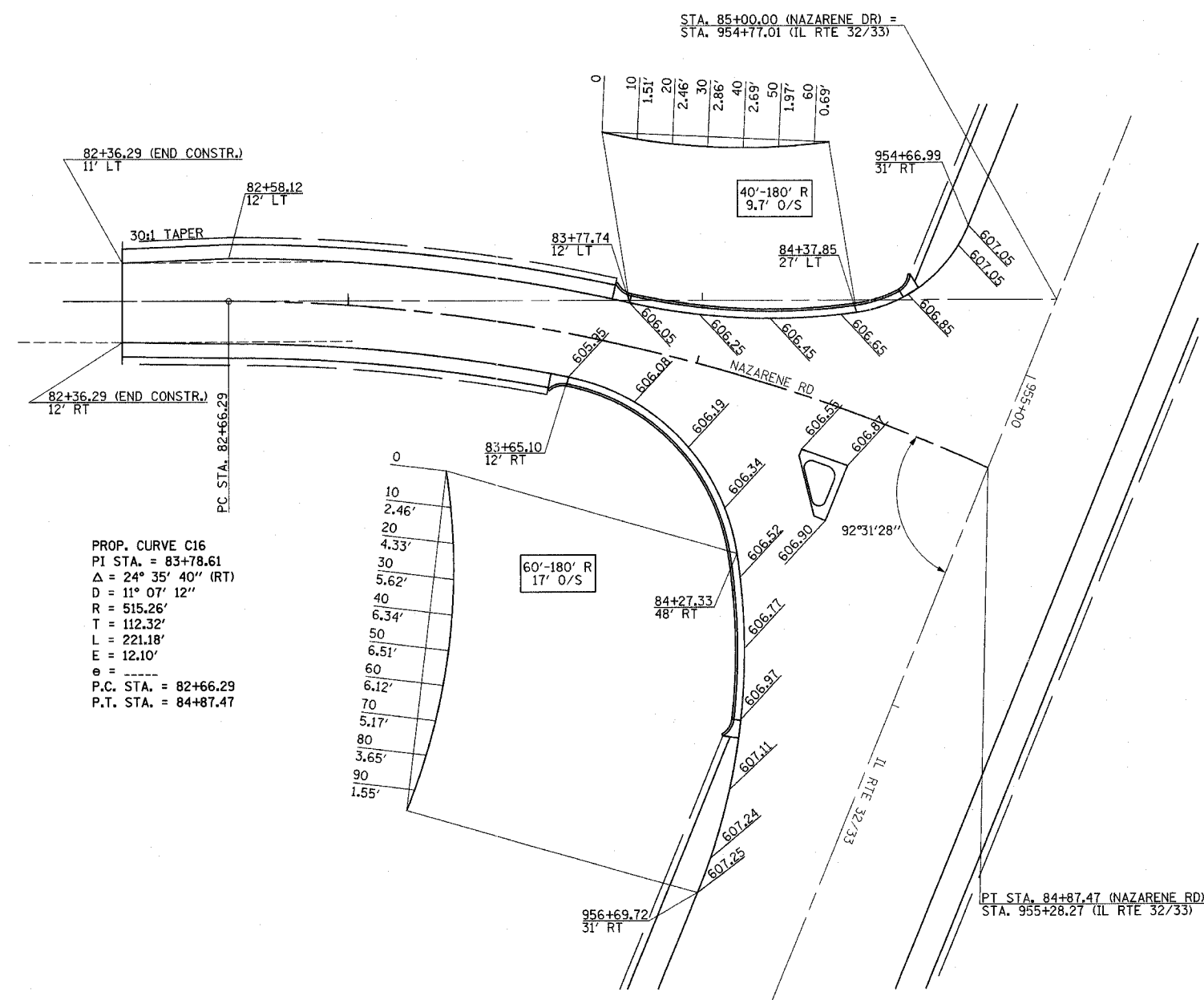

PROP. CURVE C16  
 PI STA. = 83+78.61  
 $\Delta = 24^\circ 35' 40''$  (RT)  
 $D = 11^\circ 07' 12''$   
 $R = 515.26'$   
 $T = 112.32'$   
 $L = 221.18'$   
 $E = 12.10'$   
 $e = \text{-----}$   
 P.C. STA. = 82+66.29  
 P.T. STA. = 84+87.47

- 0
- 10 2.46'
- 20 4.33'
- 30 5.62'
- 40 6.34'
- 50 6.51'
- 60 6.12'
- 70 5.17'
- 80 3.65'
- 90 1.55'

LEGEND

XXXXX INDICATES PROPOSED GRADE ELEVATION INTERVAL AROUND CURVES IS 20' UNLESS NOTED

REVISIONS	
NAME	DATE

ILLINOIS DEPARTMENT OF TRANSPORTATION  
 INTERSECTION GEOMETRICS  
 SHEET 1 OF 5

NAZARENE RD

DATE 8/02  
 DRAWN BY MLO  
 CHECKED BY SJK