

Benchmarks:  
 BM #8: 78' RT, Sta. 981+01, Elev. 600.57  
 RR Spike in Power Pole  
 BM #9: 121' RT, Sta. 991+87, Elev. 558.84  
 Chisled "X" in North Bolt of Fire Hydrant at  
 Wabash River Hills & IL 32/33

Existing Structure: None  
 Two lane, two way traffic to be maintained  
 at all times per Stage Construction Plans.

STATE OF ILLINOIS  
 DEPARTMENT OF TRANSPORTATION

F.A.P. RTE.	SECTION	COUNTY	TOTAL SHEETS	SHEET NO.
774	*	EFFINGHAM	273	86
FED. ROAD DIST. NO. 7 ILLINOIS FED. AID PROJECT				
* 107WRS-1, 107BY, 107BY-1 & 107B-2				
CONTRACT NO. 94827				

SHEET NO. 1  
 OF 3 SHEETS

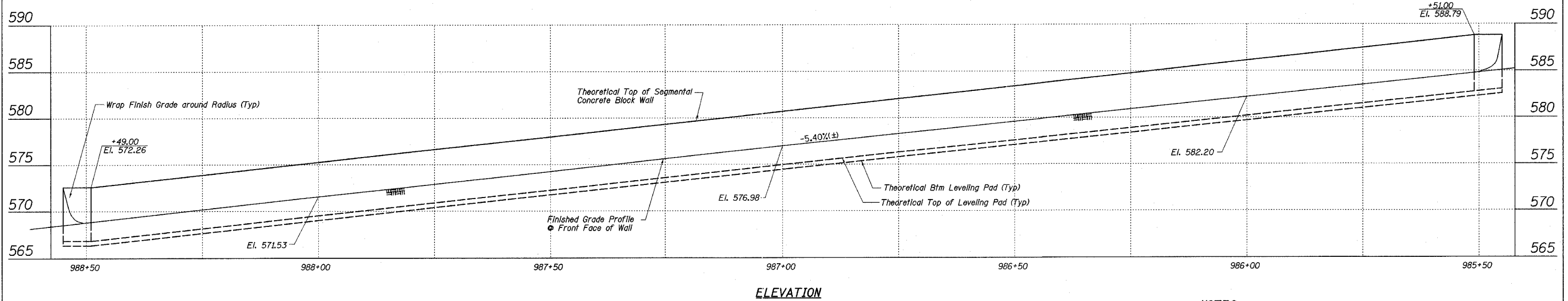
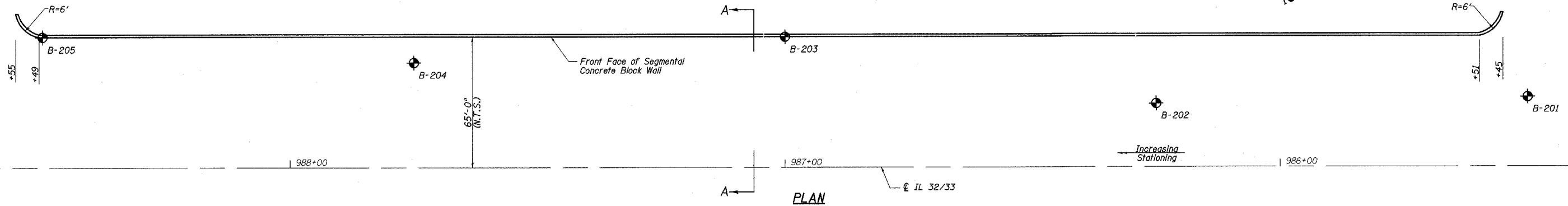

NOTES:

1. Block size, batter, setback and number of courses per Wall Supplier Design. See Special Provisions for additional requirements.
2. Ground Line behind Wall to match Top of Segmental Concrete Block Wall Elevation.
3. See Sheets 2 & 3 of 3 for Soil Borings.
4. See Roadway Cross Sections, Sheets 131 & 132.

TOTAL BILL OF MATERIAL

ITEM	UNIT	QUANTITY
SEGMENTAL CONCRETE BLOCK WALL	SQ. FT.	1901
PIPE DRAINS, 4"	FOOT	320

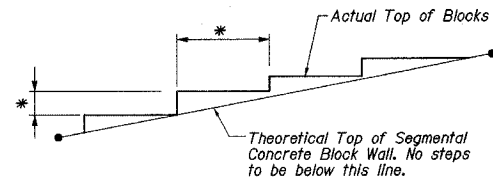

TOP OF WALL DETAIL

\* Actual Length, Location & Height of steps to be shown on shop drawings.

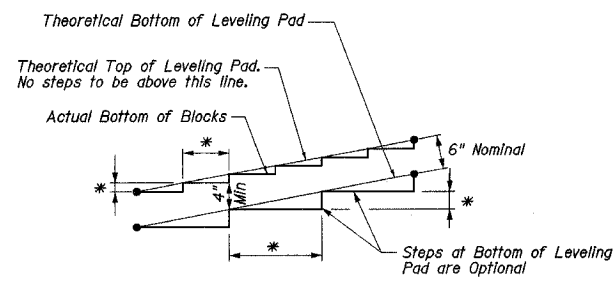

BOTTOM OF WALL DETAIL

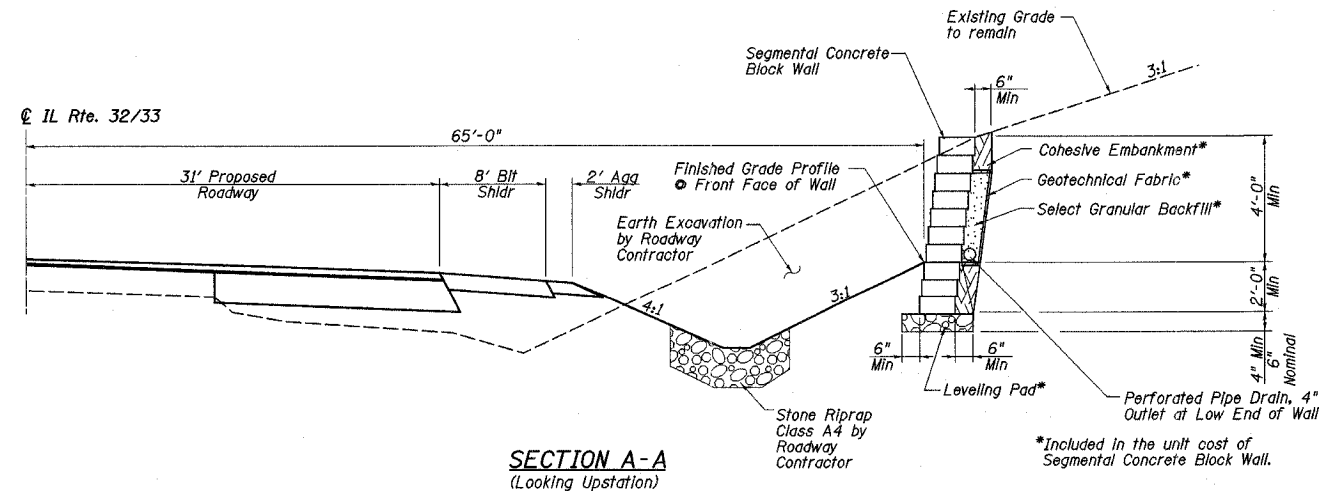

SECTION A-A  
 (Looking Upstation)

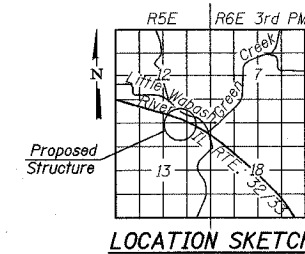

LOCATION SKETCH

GENERAL PLAN  
 ILLINOIS ROUTE 32/33  
 F.A.P. ROUTE 774  
 SECTION 107 WRS-1, 107BY,  
 107BY-1 & 107B-2  
 EFFINGHAM COUNTY  
 RETAINING WALL  
 STA. 985+45.00 RT. TO STA. 988+55.00 RT.