

**GENERAL NOTES:**

THIS SECTION SHALL BE CONSTRUCTED IN ACCORDANCE WITH THE PLANS, SPECIAL PROVISIONS AND "STANDARD SPECIFICATIONS FOR ROAD AND BRIDGE CONSTRUCTION", ADOPTED JANUARY 1, 2002.

THE WORK INVOLVED ON THIS SECTION CONSISTS OF THE REMOVAL OF THE EXISTING STRUCTURE, THE CONSTRUCTION OF A 50 FOOT LONG SINGLE SPAN PRECAST, PRESTRESSED CONCRETE DECK BEAM BRIDGE, EARTH APPROACHES, AGGREGATE SURFACE COURSE AND OTHER MISCELLANEOUS ITEMS NECESSARY TO COMPLETE THIS SECTION.

ALL ELEVATIONS ARE BASED ON U.S.C.S. MEAN SEA LEVEL DATUM.

IT SHALL BE THE CONTRACTOR'S RESPONSIBILITY TO CONTACT ALL THE UTILITIES, AFFECTING THE PROJECT, PRIOR TO CONSTRUCTION.

THE CONTRACTOR SHALL BE RESPONSIBLE FOR ALL FEES, PERMITS, LICENSES, COSTS, AND PAYMENTS TO GOVERNMENTAL AUTHORITIES FOR THE ISSUANCE OF PERMITS.

**SCHEDULE OF STEEL RAILING T.Y. S1**

| STA     | STA     | LOCATION  | QUANTITY       |
|---------|---------|-----------|----------------|
| 5+96.75 | 6+46.75 | LT. & RT. | 100 FOOT       |
|         |         |           | TOTAL 100 FOOT |

**SCHEDULE OF TRAFFIC BARRIER TERMINALS T.Y. 5A**

| STA     | STA     | LOCATION | QUANTITY     |
|---------|---------|----------|--------------|
| 5+83.50 | 5+96.75 | RT.      | 1 EACH       |
| 6+46.75 | 6+60.00 | LT.      | 1 EACH       |
|         |         |          | TOTAL 2 EACH |

**SCHEDULE OF CURLED END SECTIONS**

| STA     | LOCATION | QUANTITY     |
|---------|----------|--------------|
| 5+96.75 | LT.      | 1 EACH       |
| 6+46.75 | RT.      | 1 EACH       |
|         |          | TOTAL 2 EACH |

| F.A.S. | SECTION        | COUNTY | TOTAL SHEETS | SHEET NO. |
|--------|----------------|--------|--------------|-----------|
| 882    | 91-00071-00-BR | WHITE  | 14           | 2         |

WILSON CREEK  
CONTRACT NO. 95038

323 W. 3RD ST.  
P.O. BOX 160  
MT. CARMEL, IL  
62863  
PHONE: (618)-262-8651  
FAX: (618)-263-3327

405 W. STATE ST  
SUITE 1  
PRINCETON, IN  
47670  
PHONE: (812)-386-7611  
FAX: (812)-385-2812



PROFESSIONAL DESIGN FIRM  
LAND SURVEY & PROFESSIONAL ENGINEERING CORPORATION  
184-000887  
(62-032435)(35-002769)

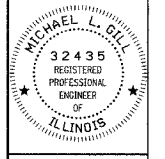

MICHAEL L. GILL  
NAME  
SIGNATURE  
DATE: 11-16-09  
11-30-05 EXPIRES

F.A.S. ROUTE 2821 (CH 15)  
CROOKED CREEK  
WHITE COUNTY, ILLINOIS

SHEET TITLE:  
PLAN & PROFILE  
SCALE: VARIES  
BY: DKB  
DATE: 12/5/00  
REV:  
2 OF 14 SHEETS  
SHEET NO. 2

**CURVE DATA**  
P.I. STA = 2+66  
Δ = 3°01' LT.  
D = 0°34'  
R = 10116.03  
T = 266.37  
L = 532.62  
E = 3.51  
P.C. STA = 0+0.37  
P.T. STA = 5+32.25

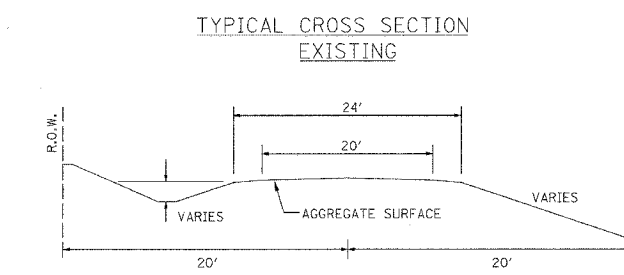
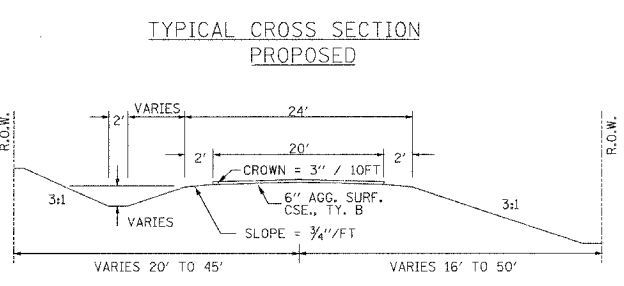
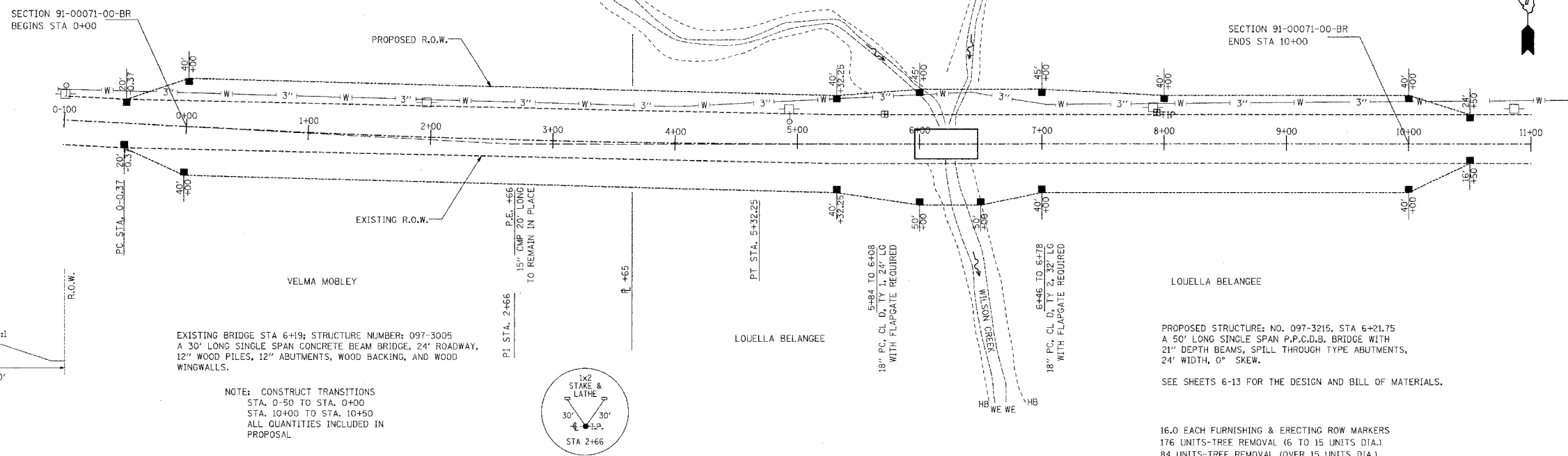
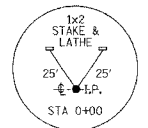
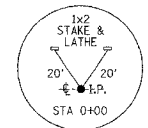

EXISTING BRIDGE STA 6+19; STRUCTURE NUMBER: 097-3005  
A 30' LONG SINGLE SPAN CONCRETE BEAM BRIDGE, 24' ROADWAY,  
12" WOOD PILES, 12" ABUTMENTS, WOOD BACKING, AND WOOD WINGWALLS.

NOTE: CONSTRUCT TRANSITIONS  
STA. 0+50 TO STA. 0+00  
STA. 10+00 TO STA. 10+50  
ALL QUANTITIES INCLUDED IN PROPOSAL

16.0 EACH FURNISHING & ERECTING ROW MARKERS  
176 UNITS-TREE REMOVAL (6 TO 15 UNITS DIA.)  
84 UNITS-TREE REMOVAL (OVER 15 UNITS DIA.)  
1.5 ACRES SEEDING, CLASS 2 SPECIAL REQUIRED

**UTILITIES:**

- JULI.L.E. 1-800-892-0123
- VERIZON  
225 E. CHESTNUT  
OLNEY, IL 62450  
618-395-6181
- GENERAL TELEPHONE  
800-231-3700
- WAYNE-WHITE ELECTRIC CO-OP  
ROUTE 45 WEST  
FAIRFIELD, IL 62837  
618-842-1296
- VILLAGE OF BURNT PRAIRIE  
618-896-2211

NOTE: CONSTRUCT SPECIAL DITCH  
STA 0+00 TO STA 6+06 LT & RT  
STA 6+33 TO STA 10+00 LT & RT

NOTE: CONSTRUCT STONE RIPRAP DITCH  
STA 5+83 TO STA 6+13 LT (0.62 TON/LIN FT)  
STA 6+30 TO STA 6+60 LT (0.62 TON/LIN FT)

38 TON STONE RIPRAP DITCH ALLOWED IN PROPOSAL.  
SEE SHEET NO. 14 FOR STONE RIPRAP DITCH DETAIL.

