

- LEGEND**
- ① EXISTING BITUMINOUS SURFACE TREATMENT
  - ② EXISTING AGGREGATE BASE COURSE
  - ③ EXISTING PCC GUTTER
  - ④ EXISTING PCC SIDEWALK
  - ⑤ PROPOSED PCC PAVEMENT, 7"
  - ⑥ PROPOSED SUBBASE GRANULAR MATERIAL, TYPE A, 4"
  - ⑦ PROPOSED MODIFIED SOIL, 12"
  - ⑧ PROPOSED COMBINATION CONCRETE CURB & GUTTER, TYPE B-6.24
  - ⑨ PROPOSED PCC SIDEWALK, 4"
  - ⑩ PROPOSED BIT. CONCRETE SURFACE COURSE, SUPERPAVE, MIX "C", N50, 2"
  - ⑪ PROPOSED BIT. CONCRETE BINDER COURSE, SUPERPAVE, IL-19.0, N50, 5"

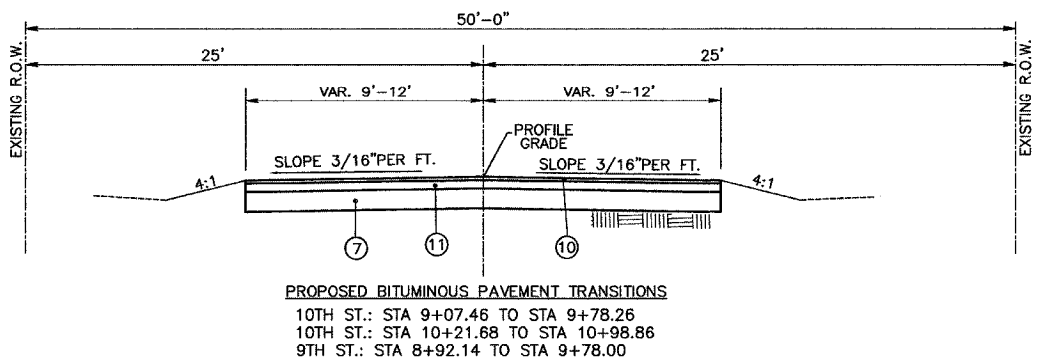
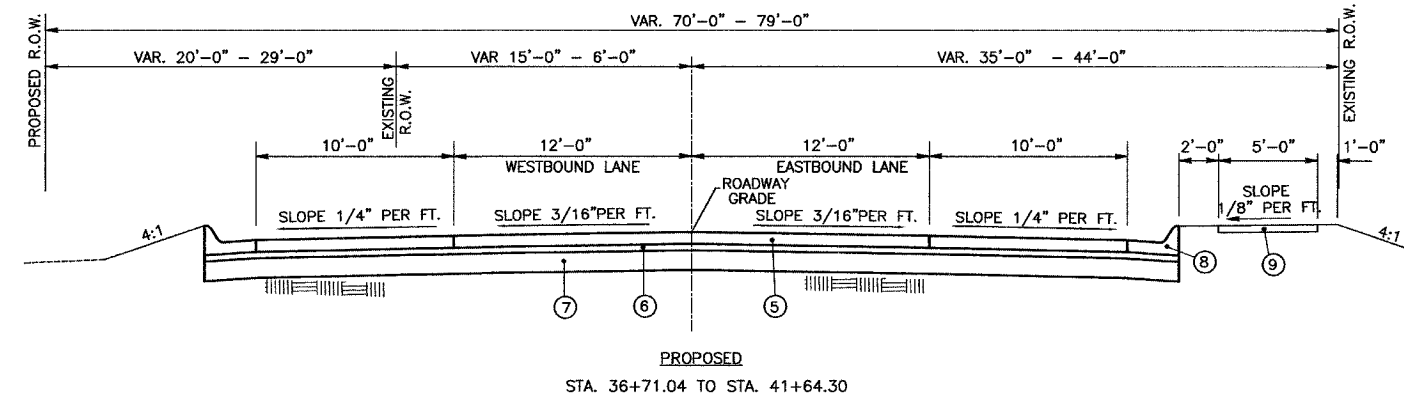
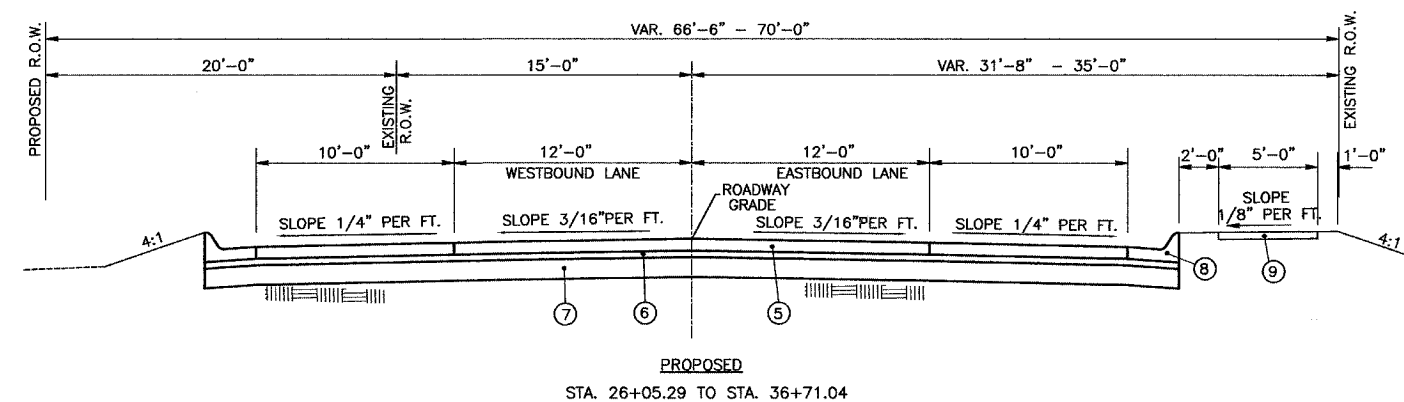
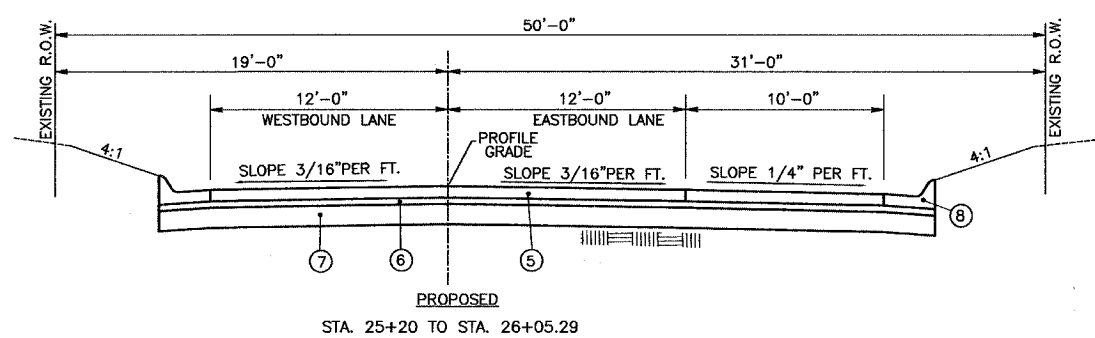

**STRUCTURAL DESIGN INFORMATION**  
 STRUCTURAL DESIGN TRAFFIC: YEAR 2014  
 PV=2,499(98%) SU=48(1.9%) MU=3(0.1%)  
 LOAD LIMIT=73,280 LB  
 ROADWAY CLASSIFICATION: CLASS II  
 TRAFFIC FACTOR: TF=0.07  
 SUBGRADE SUPPORT RATING: SSR=POOR  
 RECOMMENDED PAVEMENT THICKNESS: 7"

REVISIONS	
NAME	DATE

TYPICAL SECTIONS  
 HARNETT STREET IMPROVEMENTS  
 CITY OF MASCOUTAH  
 ST. CLAIR COUNTY, ILLINOIS