

B.M. - RR Spike in Power Pole
32.5' Rt. Station 14+84
Elev. 430.00 (Assumed)

Existing Structure - Single span precast
concrete deck beams on closed timber
pile bent abutments 18.8'W X 21.92'L

ROUTE	SECTION	COUNTY	TOTAL SHEETS	SHEET NO.
C.H.2	00-00130-00-BR	JACKSON	11	3
PROJECT NO. BR09-071(42)			CONTRACT NO. 89209	

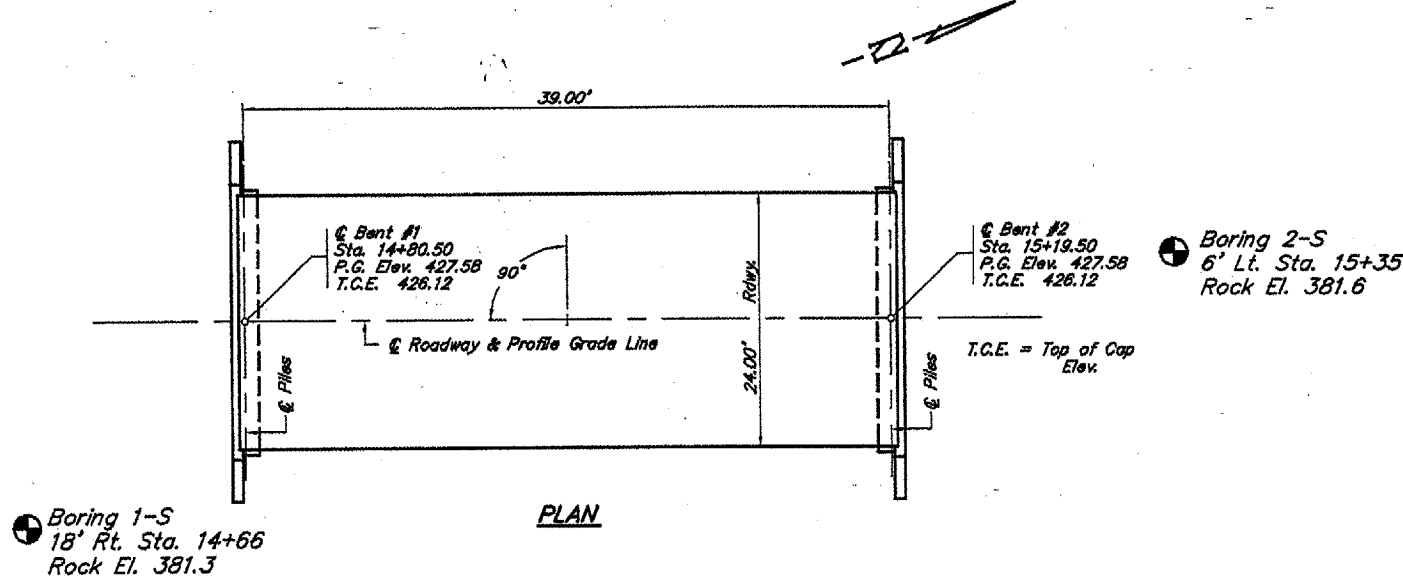
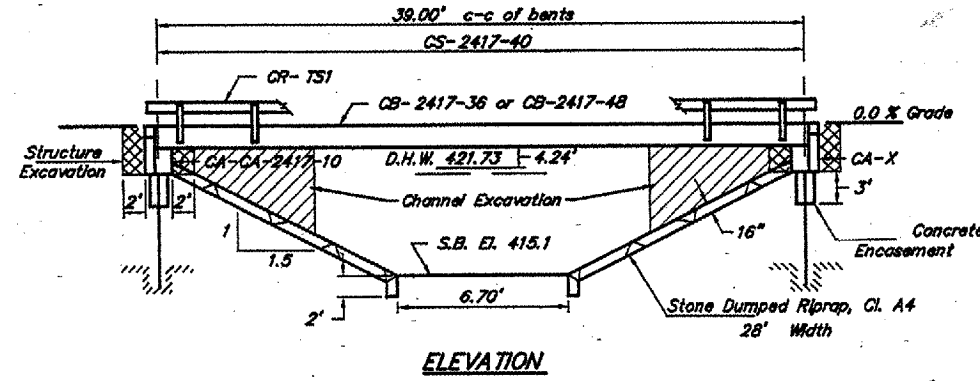

GENERAL NOTES

- Class SI Concrete shall be used throughout except in the deck beams.
- See special provisions for boring logs.
- The Waterproofing Membrane System and the Bituminous Concrete Surface Course shown on the standard bridge plans shall not be provided.
- A calcium nitrite corrosion inhibitor, as covered in the Special Provisions, shall be used in the concrete for precast prestressed concrete deck beams.
- The Article or Section numbers referencing the Standard Specifications for Road and Bridge Construction as shown on the standard bridge plan sheets included with the contract plans shall be interpreted as referring to the current edition of the Standard Specifications (Adopted January 1, 2002) as shown in the "Article/Section No. Reference Table".

ARTICLE/SECTION NO. REFERENCE TABLE

Previous No.	Current No.
504.06	504.06
505.04	505.04
706.05	1006.05
706.32	1006.32
760.07	1060.07

TOTAL BILL OF MATERIAL

Item	Unit	Super	Sub.		Total
			Piers	Abuts.	
Removal of Existing Structures	Each				1
Concrete Structures	Cu. Yds.			16.6	16.6
P.P. Conc. Dk. Bm. 17" Dp.	Sq. Ft.	960			960
Steel Rolling, Type SI	Foot	80			80
Reinforcement Bars	Pound			1720	1720
Furnishing Steel Piles HP10X42	Foot			352	352
Driving Steel Piles	Foot			352	352
Concrete Encasement	Cu. Yds.			2.1	2.1
Name Plates	Each			1	1
Structure Excavation	Cu. Yds.			81	81
Channel Excavation	Cu. Yds.			73	73
Stone Dumped Riprap, Class A4	Tons			122	122

PILE DATA (2-ABUTS.)
 Type ----- HP10X42
 Capacity ----- Refusal
 Estimated Length ----- 44 Feet
 Number Required ----- 8

PAUM CREEK
 SEC. 00-00130-00-BR BUILT 20
 JACKSON COUNTY
 LOADING HS20
 STR. NO. 039-3257

LETTERING FOR NAME PLATE
 Locate Name Plate at Southeast
 Corner of Bridge (See Std. CN)

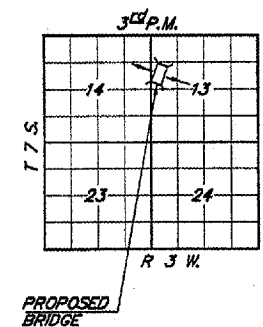

LOCATION SKETCH

DESIGN SPECIFICATIONS

1996 AASHTO & Interims
 HS 20-44 Loading, Load Factor Design.

WATERWAY INFORMATION

Drainage Area = 1.465 Sq. Mi. Low Grade Elev. = 427.03 At Sta. 19+00									
Flood	Freq. Yr.	Q C.F.S.	Opening Exlet. Sq. Ft.	Natural Prop. H.W.E.	Head-Ft. Exlet. Prop.	Headwater El. Exlet. Prop.			
Design	20	897	126.4	110.4	421.73	0.00 421.73			
Base	100	1323	147.0	139.3	422.76	0.21 422.97			
Overtopping									
Max. Calc.	500	1729	159.0	157.7	423.36	1.98 423.34			

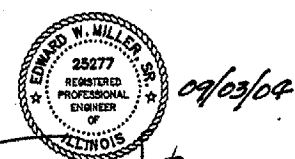

Edward W. Miller
 PROFESSIONAL ENGINEER
 #062-025277
 EXPIRES NOV. 30, 2005

GENERAL PLAN & ELEVATION
 C.H. 2
 PAUM CREEK
 SECTION 00-00130-00-BR
 JACKSON COUNTY
 STATION 15+00