

LEGEND

- POROUS FRICTION COURSE, 0.10'
- BITUMINOUS PAVEMENT MILLING FOR BUTT JOINT CONSTRUCTION
- SODDING

SAND MIX CRACK REPAIR
 LT. & RT. STA. 158+91 = 60 LIN. FT.
 LT. & RT. STA. 162+91 = 60 LIN. FT.
 TOTAL 120 LIN. FT.

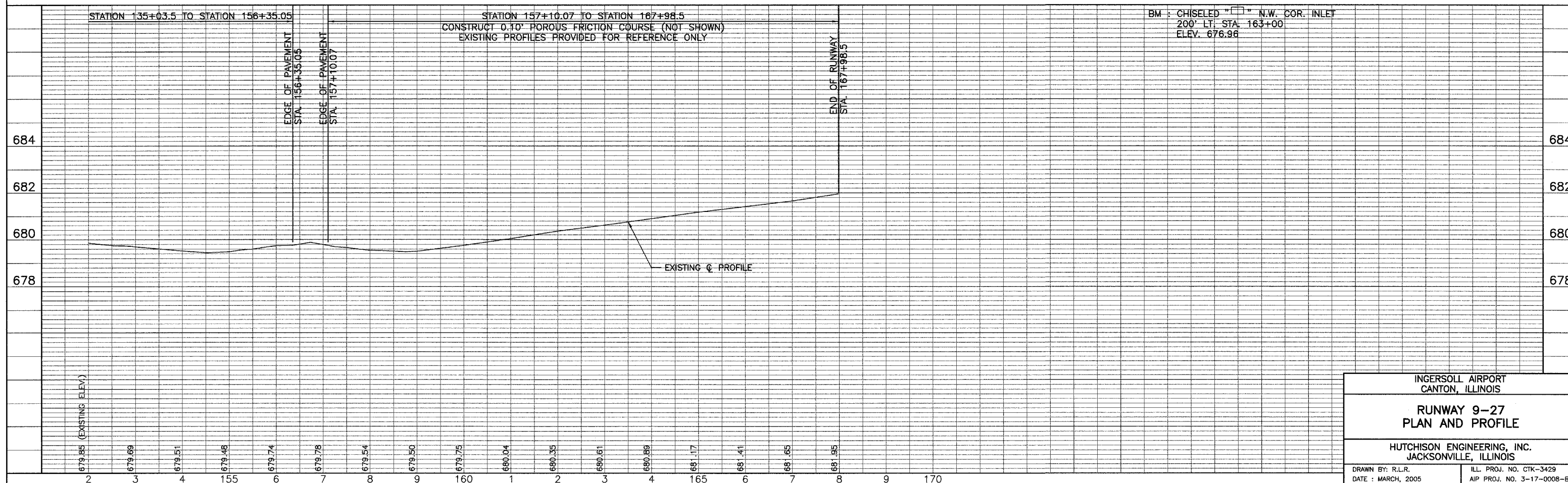

INGERSOLL AIRPORT CANTON, ILLINOIS	
RUNWAY 9-27 PLAN AND PROFILE	
HUTCHISON ENGINEERING, INC. JACKSONVILLE, ILLINOIS	
DRAWN BY: R.L.R. DATE: MARCH, 2005	ILL. PROJ. NO. CTK-3429 AIP PROJ. NO. 3-17-0008-B7