

FEB 15, 2005 11:50 AM DPE  
 I:\AIRPORT\STLOUIS\837-D4RDVAIRPORT\SHEETS\R-306XS.DWG - STA. 4+75 TO STA. 5+00

SR083

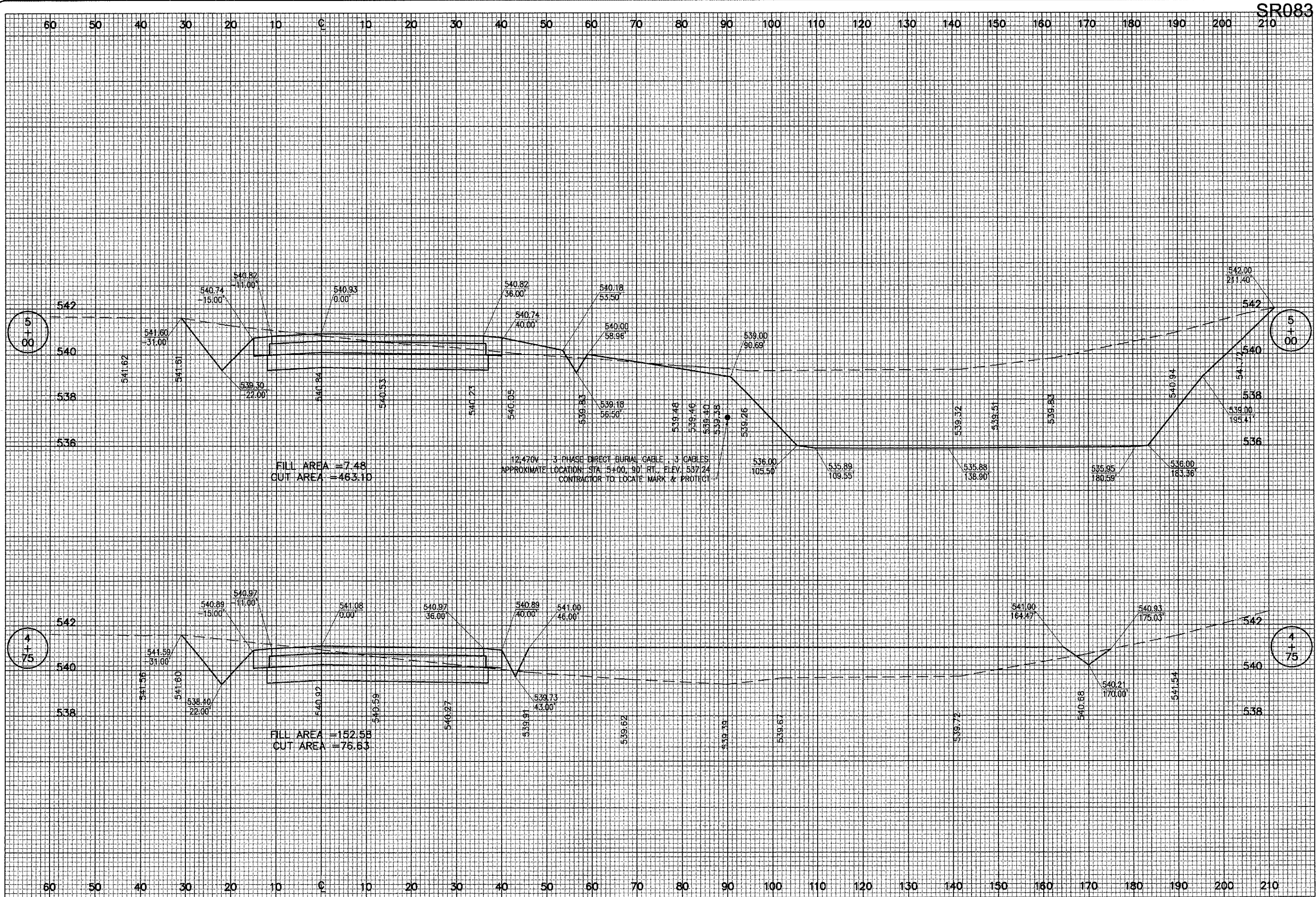

DATE	REVISION	BY

ST. LOUIS REGIONAL AIRPORT  
**St. Louis Regional**  
 EAST ALTON, ILLINOIS  
 IL PROJ.: ALN-3355

HE Project No. 837-04R00 Filename R-306XS.DWG Scale 1"=10'H, 1"=2'V Date 6/23/04	LAYOUT TLW 04/27/04 DRAWN TLW 04/27/04 REVIEWED WJM 6/23/04
---	---

**HANSON**  
 Hanson Professional Services Inc.  
 10001 Southpark Drive  
 Springfield, Illinois 62702-2686  
 Offices Nationwide

CONSTRUCT T-HANGER  
 ACCESS ROAD  
 PROPOSED  
 CROSS-SECTIONS  
 STA. 4+75 TO STA. 5+00